

ESALA 2024

Master of Architecture

**CLOSE ENCOUNTERS: BERLIN.  
EXPERIMENTS WITH DATA,  
NATURE AND COLLECTIVE LIFE  
IN THE URBAN MILIEU**

**B  
E  
R  
L  
I  
N**

Andrea Faed  
Andrew Brooks  
Jack Green  
Miguel Paredes Maldonado









This catalogue is part of a collection published by the Edinburgh School of Architecture and Landscape Architecture (ESALA), Edinburgh College of Art, University of Edinburgh. It documents student design work produced in the Master of Architecture (MArch) programme in 2023-24. Each catalogue describes one of the following six design studios in the MArch programme. The full collection is available to view online at [issuu.com/eca.march](https://issuu.com/eca.march).

**Catalogues 2023-24:**

Architecture as Support Structure.

**Close Encounters: Berlin.**

Crossing Tangier.

Daire's Airc.

Grounding Naples Vol. 2

Radical Harvest: Earth/Care/Reuse.

Published in 2024 by The University of Edinburgh, under the Creative Commons Attribution Non-Commercial Non-Derivative 4.0 International License (CC BY-NC-ND 4.0).

Andrea Faed, Andrew Brooks, Jack Green and Miguel Paredes Maldonado. *Close Encounters: Berlin. Experiments with Data, Nature and Collective Life in the Urban Milieu*. Edinburgh: University of Edinburgh, 2024.

Text © Authors, 2024.

Images © Authors and Contributors, 2024.

**Close Encounters: Berlin**

ISBN (paperback): 978-1-912669-73-8

ISBN (eBook): 978-1-912669-65-3



ESALA 2024

Master of Architecture

**CLOSE ENCOUNTERS: BERLIN  
EXPERIMENTS WITH DATA,  
NATURE AND COLLECTIVE LIFE  
IN THE URBAN MILIEU**

Andrea Faed  
Andrew Brooks  
Jack Green  
Miguel Paredes Maldonado

**B  
E  
R  
L  
I  
N**

# CONTENTS

---

-	<b>CLOSE ENCOUNTERS: BERLIN</b>	1
	<b>EXPERIMENTS WITH DATA, NATURE AND COLLECTIVE LIFE IN THE URBAN MILIEU</b>	
	ANDREA FAED   ANDREW BROOKS   JACK GREEN MIGUEL PAREDES MALDONADO	
-	<b>BIBLIOGRAPHY &amp; IMAGE REFERENCES</b>	116
-	<b>ACKNOWLEDGEMENTS</b>	119
	<b>SENSING INSTRUMENTS</b>	12
	<b>WANDERING ENVIRONMENTAL SENSOR</b>	14
	<b>SOUNDING THE GROUND</b>	16
	<b>BIRD DEVICE</b>	18
	<b>VERTICAL OBSERVER</b>	20
	<b>SHIENENMAUS</b>	22
	<b>TRIPOD SENSOR</b>	24



<b>01</b>	<b>EMBASSY OF NON-HUMAN BEINGS</b>	<b>28</b>
	<b>HYBRID NETWORKS</b>	<b>30</b>
	ANDONG GUO BOLUN HUA SHIYU ZHANG	
<b>02</b>	<b>LENDING LIBRARIES FOR A PERMEABLE CITY</b>	<b>42</b>
	<b>URBAN POROSITY</b>	<b>44</b>
	FOLAHAN ADELAKUN CARL HARRIS OLIVER MAXWELL	
<b>03</b>	<b>BERLIN'S BLOCKS TO REWILDING PLOTS</b>	<b>56</b>
	<b>WAREHOUSE TO BIRDHOUSE</b>	<b>58</b>
	TERRY FENG KIM LEE BINGZHI LI	
<b>04</b>	<b>INTERWEAVING HABITATS</b>	<b>70</b>
<b>04a</b>	<b>CRAFTING FUTURES</b>	<b>72</b>
	JODIE HORSBURGH	
<b>04b</b>	<b>LANDSCAPE OF CARE</b>	<b>76</b>
	INKA EISMAR	
<b>04c</b>	<b>REWILDING ISLANDS</b>	<b>80</b>
	EILIDH MCKENNA	
<b>05</b>	<b>DER GROSSE PARK</b>	<b>84</b>
<b>05a</b>	<b>GATEWAY TO THE GREEN CORRIDOR</b>	<b>86</b>
	GEORGIA TUCKER	
<b>05b</b>	<b>NESTING DER GROSSE PARK</b>	<b>90</b>
	SIMY PUTHENVEEDU ABRAHAM	
<b>06</b>	<b>LIVING BRIDGES</b>	<b>94</b>
	<b>REPAIRING GREEN INFRASTRUCTURES</b>	<b>96</b>
	WULFRIC CLACKSON	
<b>07</b>	<b>THE INHABITED EMBANKMENT</b>	<b>100</b>
	<b>SONIC INFRASTRUCTURES OF BERLIN</b>	<b>102</b>
	ADAM MITCHELL	
<b>08</b>	<b>AVION INSTITUTE</b>	<b>106</b>
<b>08a</b>	<b>SCIENCE OF NATURE: URBAN-AIR</b>	<b>108</b>
	ZEYU WANG	
<b>08b</b>	<b>URBAN EPIPHYTE</b>	<b>112</b>
	RAJ KACHARE	













## **CLOSE ENCOUNTERS: BERLIN**

### EXPERIMENTS WITH DATA, NATURE AND COLLECTIVE LIFE IN THE URBAN MILIEU

*“Not to find one’s way around a city does not mean much. But to lose one’s way in a city, as one loses one’s way in a forest, requires some schooling.”*

Walter Benjamin

#### **INFRASTRUCTURES AND TECHNOSTRUCTURES**

In his collection of essays on the phenomenon of technification, philosopher Gernot Böhme argued that technology has historically held the power to transform the nature of society at a fundamental level. By way of an example, the invention of novel optical apparatuses—such as the telescope, the microscope or the photographic camera—led on each occasion to a radical transformation of our collective culture of vision. Likewise, aural cultures were also remodelled by successive waves of technification. For instance, the invention of telephone communications in the late 19th century radically altered our collective understanding of the act of ‘conversation.’<sup>2</sup>

Böhme also explained how both technology and its attendant technical modes of knowledge had become the chief infrastructural platforms that shape both our social field and our cultural landscape, forming what he referred to as the ‘technostructure of society.’ Building on Böhme’s ideas, the close encounters: Berlin studio investigated a key contemporary component of this technostructure: the ubiquitous layer of data-driven technologies and computational processes that nowadays shape our built environment across all scales. As Böhme noted, ‘the greater the amount of

1 Walter Benjamin, ‘Tiergarten’, in *Berlin Childhood Around 1900* (Cambridge: Harvard University Press, 2006), 53.

2 Gernot Böhme, *Invasive Technification: Critical Essays in the Philosophy of Technology* (Bloomsbury, 2012), 49.



social regulation that takes place via data management and data processing, the more people and things only count as part of society to the extent that they can be defined in terms of data.’

The studio was framed around a series of critical questions pertaining to contemporary urban technification: What novel modalities of urban knowledge can be unpacked by tapping into data-driven technostuctures? How are contemporary urban cultures transformed by pervasive computational platforms? How can designers meaningfully tap into these technical layers to better articulate the spaces of collectivity in the city?

## CRITICAL ZONES / CONTACT ZONES

This enquiry into urban technification was used as a vehicle for the studio to address what is, arguably, the most pressing issue of our times: The planetary-scale climate emergency, and our increased collective awareness of the entangled fragility of our earthly ecosystem.

As a key contribution to recent intellectual debates on this matter, the studio paid special attention to Bruno Latour’s narrative of the ‘Critical Zone.’ Originally coined within the scientific disciplinary realm, the term highlights the fact that all forms of life on Earth (human and nonhuman alike) coexist within a comparatively thin layer of the planet’s atmosphere—the area near the surface of the Earth where life can be sustained. Latour elaborated on the implications of such a ‘tight’ coexistence, noting that human and nonhuman organisms are intimately enmeshed and co-dependent within this shared ‘zone’—their living environments are co-generated and interrelated, and thus cannot be extricated from one another. Critically, Latour foregrounded that such environments—encompassing ecosystems such as forests and lakes but also urban neighbourhoods and brownfields—are not static: they emerge from the interactions of many different living beings over time, eventually making it impossible to draw a line between a particular organism and the biotope that surrounds it.<sup>3</sup>

Latour’s Critical Zone narrative entails a radical change of perspective in regards to what constitutes ‘collective life’ in an urban ecosystem, running contrary to well-established anthropocentric readings of the city as an entirely human construction. For the close encounters: Berlin studio, it seems

<sup>3</sup> Bruno Latour, *After Lockdown: A Metamorphosis* (Polity, 2021), 13, 47, 124.



clear that human and nonhuman beings are equally deserving agents in the making of this collectivity, inasmuch as they are inextricably entangled and must coexist productively to build their joint urban environment together.

Leveraging this new perspectival scenario, where encounters between humans and nonhumans open up new potentials for the production of urban space, the studio framed its design outputs as extensions of what Donna Haraway referred to as 'Contact Zones.' For Haraway, these are boundaries between domains inhabited by different subjects—usually from different species. Contact Zones are not just spatial boundaries, but also encompass the new relationships and forms of communication that may emerge between the subjects at stake. In building Contact Zones, all participating subjects develop adaptations and predispositions, raising opportunities for mutual encounter. As Haraway noted, Contact Zones manifest the interdependence between species and their ability to shape one another over time, as well as the role of technology as both an agent of mediation in this relational framework and a subject on its own merit.<sup>4</sup>

*You want me to land on Earth? Why?— Because you're hanging in midair, heading for a crash.—How is it down there?—Pretty tense.—A war zone?— Close: A Critical Zone, a few kilometres thick, where everything happens.—Is it habitable?—Depends on your chosen science.—Will I survive down there?— Depends on your politics.*<sup>5</sup>

Bruno Latour and Peter Weibel

## **DIGITAL SENSING, URBAN HACKING AND CRITICAL MAKING**

During the first semester, the studio worked with the vast public urban landscapes of Berlin as testing grounds to explore the intertwining of social life and natural life in the city. From a methodological perspective, this exploration was framed through a particular subset of the contemporary urban technostructure: the computational processes and platforms of Digital Urban Sensing. This refers to the collective, distributed and systematic collection of data pertaining to social, infrastructural and environmental conditions in the city, and the insights that can be unpacked from the resulting repositories of digital urban knowledge.

<sup>4</sup> Donna Haraway, *When Species Meet* (University of Minnesota Press, 2007), 218–20

<sup>5</sup> Bruno Latour and Peter Weibel, eds., *Critical Zones: The Science and Politics of Landing on Earth* (MIT Press, 2020).

Contrary to the prevalent, top-down narratives of urban sensing (exemplified, for instance, by the managerial problem-solving structures of the Smart City paradigm) data-driven sensing practices in the studio sought to highlight ‘coexistence’ rather than ‘performance,’ thus seeking ‘knowledge’ rather than ‘optimisation.’ To that extent, investigations into digitally mediated sensing drew from the theories of Urban Hacking (the creative use of digital media to ‘open up urban institutions and infrastructures to systemic change in the public interest’)<sup>6</sup> and Critical Making (a pragmatic pursuit of critical thinking through actions of goal-based physical making).<sup>7</sup>

In practice, this entailed deploying the Arduino digital prototyping platform to build six portable fieldwork instruments: DIY urban sensing devices capable of digitally capturing and recording a range of sensory and environmental data during the Semester 1 studio trip to Berlin. Conceptualised as hybrid digital-analogue mechanisms engineered as adaptations to the urban landscapes in which they operate, the physical architecture of the instruments helped filter, focus or extend their range of digital sensing. The orientation of sensors, the configuration of their envelopes, the articulation of different components and the mechanisms for placing or mounting the instruments on site was as important as their digital sensing capabilities.

Working with these DIY devices, students surveyed the fringes of small natural spaces in the city of Berlin, tuning-in to the non-human entities that inhabit its urban milieu by capturing visual, sonic and environmental data streams outside the ranges of human attention and perception. Upon return to Edinburgh, the task shifted to synthesising and translating the body of data-driven field work into contextual visual and sonic installations in the space of the studio. In so doing, data was articulated as a form of urban infrastructure, capable of acting as an interface between human and nonhuman domains in the city. This, in turn, outlined potential avenues for transformation in the natural public spaces of Berlin, paving the way for the development of a series of distributed interventions that constituted the

6 Cristina Ampatzidou et al., *The Hackable City: A Research Manifesto and Design Toolkit* (Amsterdam: Amsterdam Creative Industries Publishing, 2015).

7 Carl DiSalvo, “Critical Making as Materializing the Politics of Design,” *The Information Society* 30, no. 2 (March 1, 2014): 96–105, <https://doi.org/10.1080/01972243.2014.875770>.

final outputs of the first semester. Conceptualised as ‘Urban Field Stations,’ these interventions were small architectural devices that tapped into the digital infrastructural platform of the city to build productive interactions with urban ecosystems in the public realm.

## THE COMPETITION: SPECULATIVE FUTURES

*(...) But to really understand the strange limbo that is the outskirts, the city limits, the land that’s ‘just waiting’, I’d suggest taking the route covered by the tram, and its environs. In this problematic zone, the transition between city and countryside is rarely as gradual as in a village or small town.*<sup>8</sup>

Franz Hessel, 1929

The studio started the second semester by participating in the AIV Schinkel-Preis 2024, an international architectural competition titled the day after tomorrow. Students were able to freely chose a ‘neighbourhood’ in Berlin to modify, either an empty plot or existing buildings with the aim to create a ‘liveable city’. Embracing the fast-paced rhythm imposed by the competition deadline, students were prompted to draw from the designs, insights and strategies produced during the first semester - investigating the public parks in Berlin - and extrapolate them to the new challenges posed by the competition brief and of the built urban environment. A broad view of collective urban life was pursued - one that encompasses both human and nonhuman entities as equally deserving agents of this collectivity. Projects have meaningful conversations between inhabiting, both publicly and privately, buildings and the spaces between to engender a sustainable community, socially and environmentally.

Working on an open architectural competition within an academic context provided a means to cultivate a critical, reflective engagement with contemporary professional practice. Running counter to calls for academic education to ‘train’ students to work in professional practice, the studio leveraged the competition format as an opportunity to develop hands-on, investigative, collective design reflections that could translate their critical value to the realm of the profession. This approach appeared to gain validation through the outcome of the AIV Schinkel-Preis competition:

---

<sup>8</sup> Franz Hessel, *Walking in Berlin: A Flaneur in the Capital* (Brunswick, Victoria: Scribe Publications, 2016), 112-13



one entry produced in the studio was awarded second prize and one entry was ranked as a finalist by the judging panel.<sup>9</sup>

## HYBRID URBAN ASSEMBLIES

The eight competition submissions (each produced by a range of team sizes from three to singular students) were carried into the final stage of the studio sequence for further investigative, poetic, theoretically informed development. Projects deal in a critical way with issues and questions of contemporary relevance, responding to the themes of inhabitation, coexistence, and hybridization in the urban field. This required addressing the social, cultural, infrastructural, and environmental conditions that were collectively identified throughout the year, mobilizing them to activate complex architectural assemblages that opened up new opportunities for the intertwining of social life and natural life in the Berlin neighbourhoods.

In line with the overarching thematic preoccupations of the close encounters: Berlin studio, key vectors of enquiry during this final stage included the coexistence of human and nonhuman forms of life in the city, the integration of natural life and social life in the urban public realm, and the opportunities (and risks) afforded by the technification of our built environment across all scales—exemplified by our extended engagement with both physical and digital urban infrastructures. On a more general level, the final stages of the studio explicitly sought to address the question of contemporary urban inhabitation: In a context of planetary environmental crisis, how can we establish meaningful forms of collective life in a large European metropolis such as Berlin?

Responses ranged from rethinking future living that predominantly centred around humans to imagining a harmonious coexistence between human and non-human beings, creating an ‘Embassy of Non-Human Beings’ within the Diplomatic Quarter, where non-humans take centre stage ambassadors; a vision that allows the urban green courtyards of Bülowstraße to be accessible to all and activated with a series of sport and music facilities, and lending libraries; transforming an industrial site into a rewilded and residential enclave; re-imagining the territory of Landwehrkanal as a multi-species landscape addressing concerns of

<sup>9</sup> See: <https://www.aiv-berlin-brandenburg.de/dokumentation-aiv-schinkel-wettbewerb-2024-uebermorgen/>







affordable housing and ecological habitats; establishing a green corridor of social interaction across the city, connecting Nature Park Sudgelande to the Tiergarten; repairing green infrastructures with a residential block that bridges and reconnects islands of natural wild spaces that were severed by Südkreutz station; an Inhabited Embankment along the railway line at Park am Gleisdreieck allowing safe passage for animals and acoustic baffling for humans for a co-living urban landscape; and a 'journey' from Tiergarten to a Flea Market, around Ludwig Leo's Umlauftank building, under and over the rail line and ending at the zoo, to disconnect and thicken the human critical zone.

## **SOME NOTES ON BERLIN**

The prevalent socio-political commentary on the city of Berlin, championed by contemporary philosophers such as Peter Sloterdijk and Jürgen Habermas (who published the aptly titled collection of essays 'A Berlin Republic' in 1997)<sup>10</sup> often revolves around the construction and the identity of the modern German state in relation to the historical events of 20th Century Europe. These narratives tend to highlight how Berlin carries both the symbolic and the physical marks of its convoluted recent past, whilst gradually consolidating itself as the locus of political and economic power in the European Union. To a large extent, public discourse appears dominated by different takes on the same question: How does history move forward for Berlin, and by extension, for Germany?

In approaching this question, the studio took the opportunity to investigate how the focus of urban debate appears to have gradually shifted from the Cold War and Post-Wall narratives of the city to contemporary environmental concerns and their attendant effects on urban societies. In 21st century Germany, such concerns appear to crystallise as a strong aspiration to develop socially and ecologically sustainable forms of collective life. As Henri Lefebvre prefigured in his 1967 book 'Le Droit à la ville' (The Right to the City) for the citizens of Berlin this aspiration is nowadays materialising through the pursuit of social and environmental justice in the urban field.

Berlin is both a major, fast-growing European capital and one of Europe's most biodiverse metropolises, making it a highly tensioned urban scenario

---

<sup>10</sup> Jürgen Habermas, *A Berlin Republic: Writings on Germany* (Cambridge: Polity Press, 1998).



with pressing issues that strongly influence its urban housing question: immigration, gentrification, marketization, and collective aspirations for social justice. In this sense, Berlin exemplifies the urgency to redefine contemporary urbanity in an age of environmental crisis, the value of adaptation and reuse as an architectural ethos, the pursuit of meaningful conversations with history and heritage, and the ethical imperative to foster social integration and multiculturalism through design.

## CLOSE ENCOUNTERS

Throughout the arc of the academic year, the close encounters: Berlin studio sought to operate at the intersection of pressing technological, infrastructural and environmental concerns in the contemporary city: pervasive digitalisation, algorithmic governance, threatened biodiversity and the major transformations to both urban mobility and urban material cultures brought about by an unavoidable post-carbon future.

This posited important challenges: First, identifying where such an intersection of concerns may lie, and how it might be framed in the studio context. Second, imagining how it could be meaningfully manifested in order to foster productive design conversations around it. Third, rehearsing how the productive paradigms emerging from this process of enquiry could be mobilised through the tools and spatial ambitions of the architectural discipline.

In light of this overarching framework, it is not surprising that the body of work produced throughout the year tended to privilege a strategic approach to design questions. Encouraged by both the studio briefs and the studio tutors, most projects appealed to systematic rather than formal means to articulate and resolve architectural problems. At the core of all of them is a drive to formulate novel forms of collective existence, which make amends with the city of yesteryear whilst preparing us for a forthcoming post-carbon world. In so doing, they draw a (no longer utopian) future for a radically upturned urban field, ripe for fostering and mediating ‘close encounters’ between a multiplicity of species, objects and entities—human and non-human alike.

*Andrea Faed, Miguel Paredes Maldonado, Andrew Brooks and Jack Green*

# SENSING INSTRUMENTS

- 
1. Wandering Environmental Sensor - Andong Guo, Bolun Hua, Shiyu Zhang
  2. Sounding the Ground - Folahan Adedokun, Carl Harris, Oliver Maxwell
  3. Bird Device - Terry Feng, Kim Lee, Bingzhi Li
  4. Vertical Observer - Inka Eismar, Jodie Horsburgh, Eilidh McKenna
  5. Schienenmaus - Wulfric Clackson, Georgia Tucker, Adam Mitchell
  6. Tripod Sensor - Raj Kachare, Simy Puthenveedu Abraham, Zeyu Wang







# WANDERING ENVIRONMENTAL SENSOR

ANDONG GUO  
 BOLUN HUA  
 SHIYU ZHANG

Interactive installation device adaptation (above left)

Device on site (above right)

Device axonometrics (below)

In use survey video stills (adjacent)

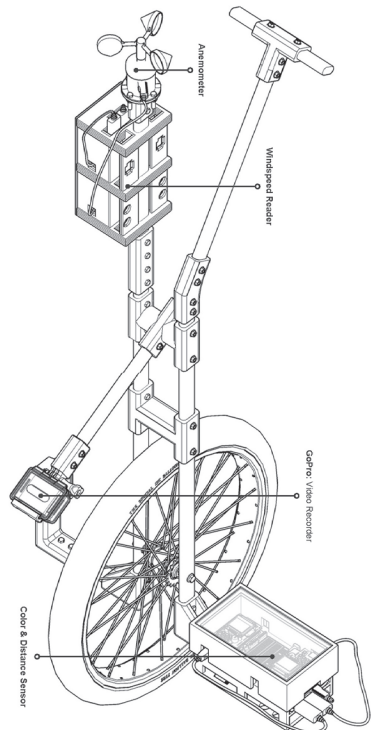
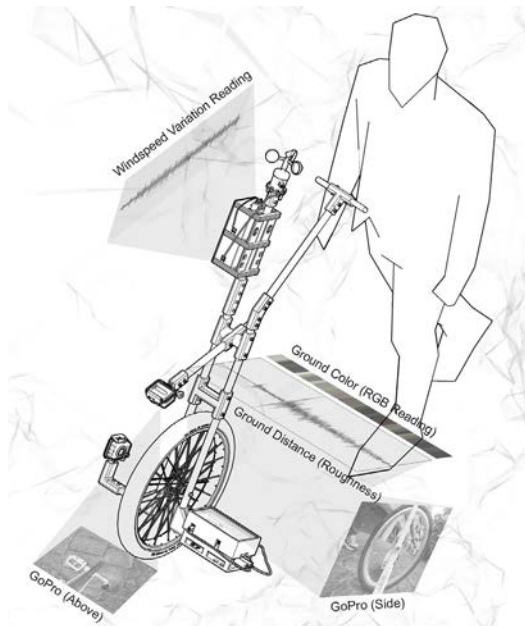





# SOUNDING THE GROUND

**FOLAHAN ADELAKUN**  
**CARL HARRIS**  
**OLIVER MAXWELL**

---

Interactive installation device adaptation (above)

Device axonometric and data tracings (below)

Tiergarten Survey with data tracking overlaid (adjacent)

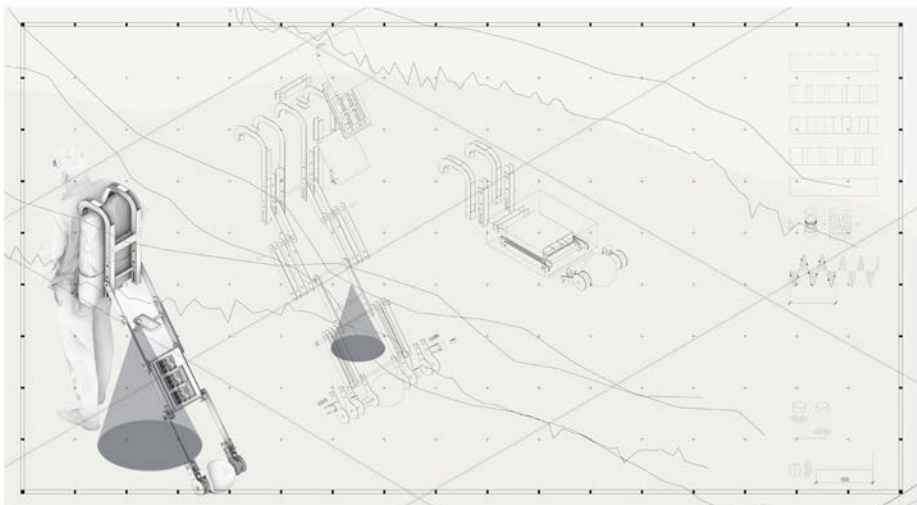





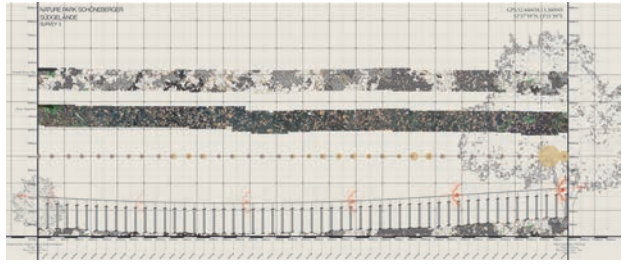

# BIRD DEVICE

**TERRY FENG  
KIM LEE  
BINGZHI LI**

Survey mapping (above)

Bird device - axonometric, plan section and elevation (below)

In-use survey photos (adjacent)

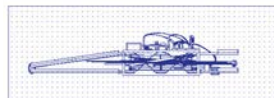
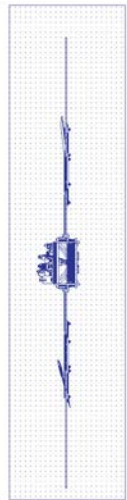
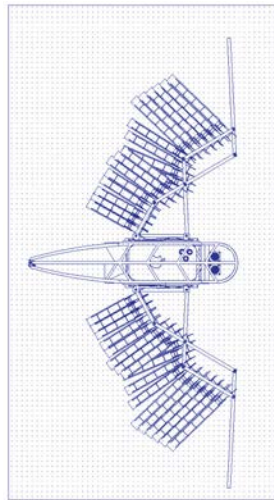
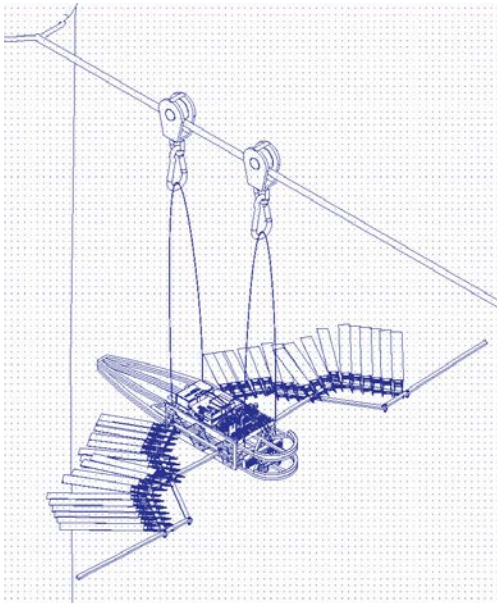



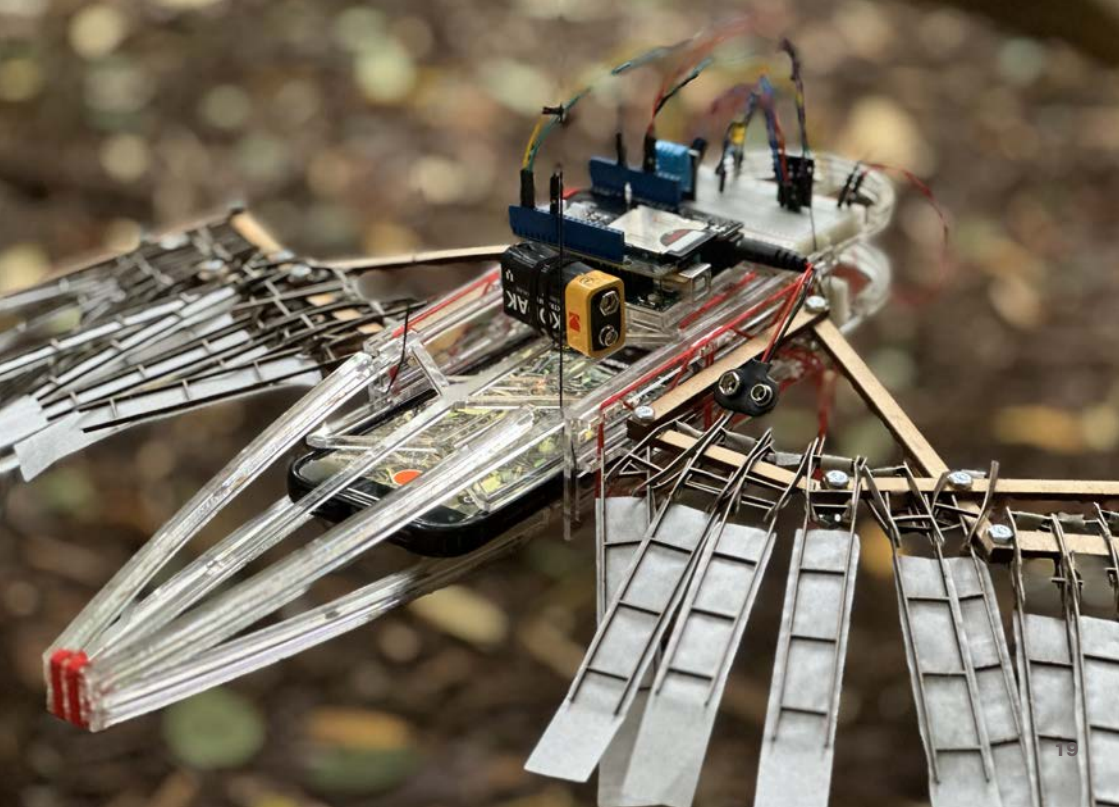





# VERTICAL OBSERVER

**INKA EISMAR  
 JODIE HORSBURGH  
 EILIDH MCKENNA**

Tree log sheet (above right)

Device axonometric (below left)

Device elements and parts taxonomy (below middle & right)

Time-lapse overlay survey photo (adjacent)

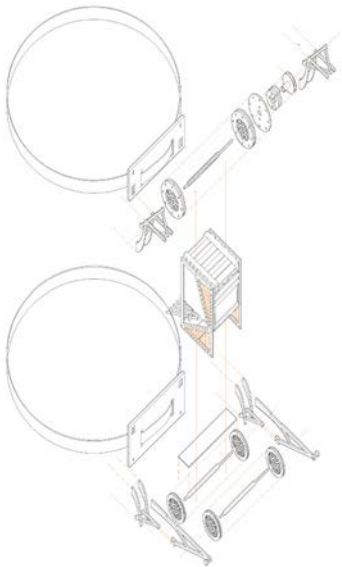





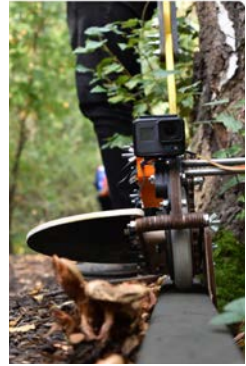

# SCHIENENMAUS

WULFRIC CLACKSON  
 GEORGIA TUCKER  
 ADAM MITCHELL

Track survey front view (above)

Schienenmaus exploded axonometric (below left)

Photographic parts elevations (below right)

Line of Berlin Wall survey (adjacent above)

Time-lapse overlay station survey (adjacent below)

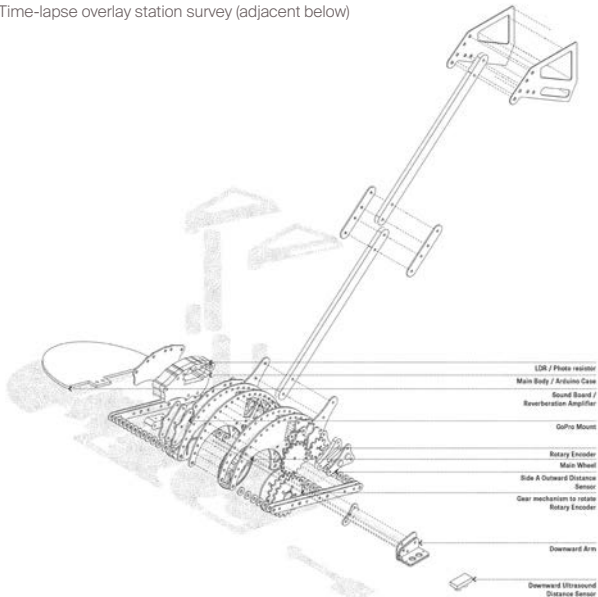







# TRIPOD SENSOR

**RAJ KACHARE**  
**SIMY PUTHENVEEDU ABRAHAM**  
**ZEYU WANG**

- 
- Collected site artefacts - photo (above)
  - Device maquette on Berlin mapping (below left)
  - Tiergarten Survey (below right)
  - Sensing device elevation drawing - stick and tripod iterations (adjacent)







Motion Sensing Device



Traffic Sound Sensing Device



Radio Waves Sensing Device

3000MM

2790MM

2500MM

2000MM

1500MM

1000MM

500MM

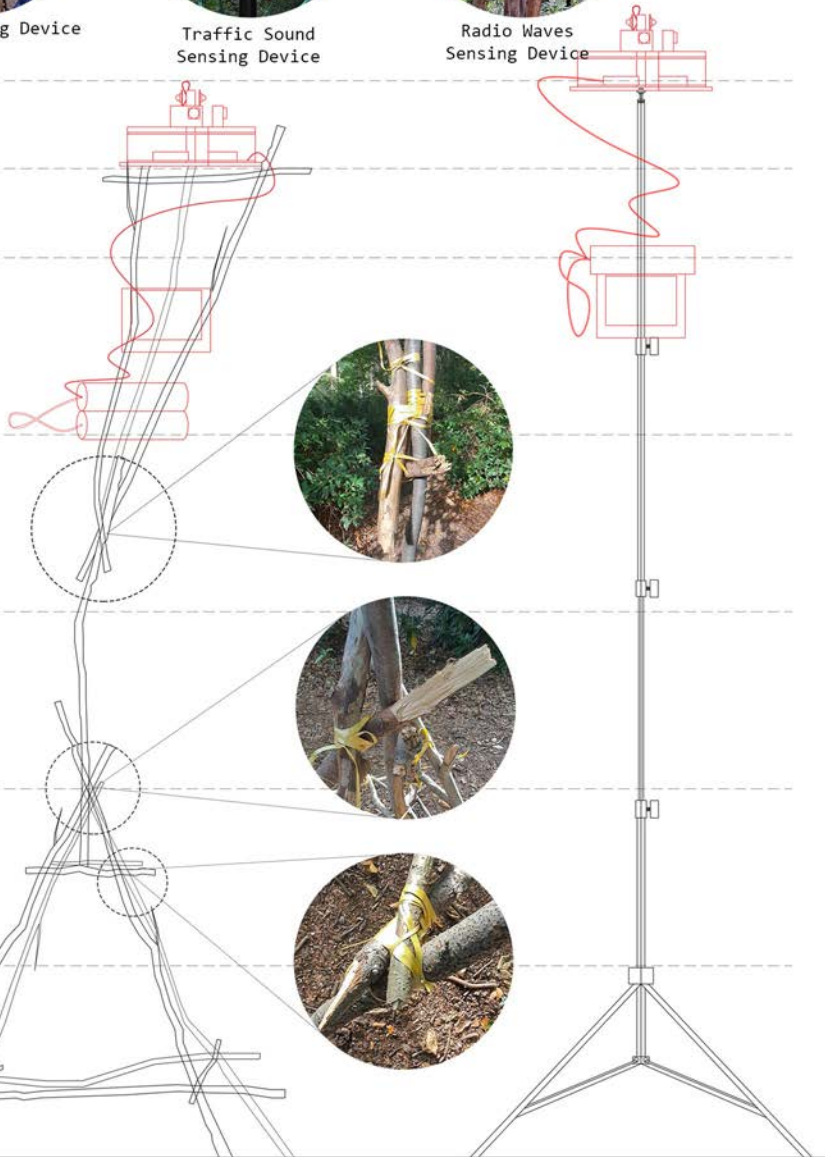





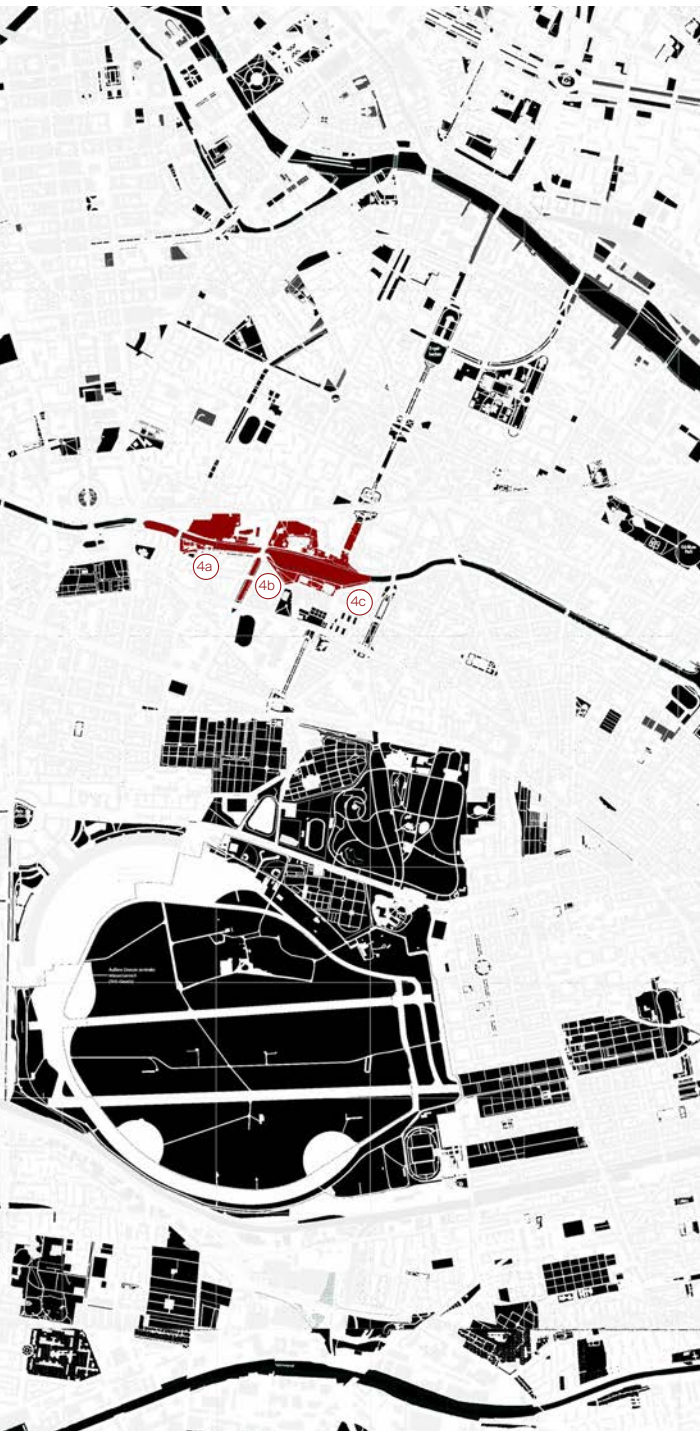

- 1 EMBASSY OF NON-HUMAN BEINGS - ANDONG GUO + BOLUN HUA + SHIYU ZHANG
- 2 URBAN POROSITY - FOLAHAN ADELAKUN + CARL HARRIS + OLIVER MAXWELL
- 3 BERLIN'S BLOCKS TO REWILDING PLOTS - TERRY FENG + KIM LEE + BINGZHI LI
- 4a CRAFTING FUTURES - JODIE HORSBURGH
- 4b LANDSCAPE OF CARE - INKA EISMAR
- 4c REWILDING ISLANDS - EILIDH MCKENNA
- 5a GATEWAY TO THE GREEN CORRIDOR - GEORGIA TUCKER
- 5b NESTING DER GROSSE PARK - SIMY PUTHENVEEDU ABRAHAM
- 6 REPAIRING GREEN INFRASTRUCTURES - WULFRIC CLACKSON
- 7 SONIC INFRASTRUCTURES OF BERLIN - ADAM MITCHELL
- 8a SCIENCE OF NATURE: URBAN-AIR - ZEYU WANG
- 8b URBAN EPIPHYTE - RAJ KACHARE



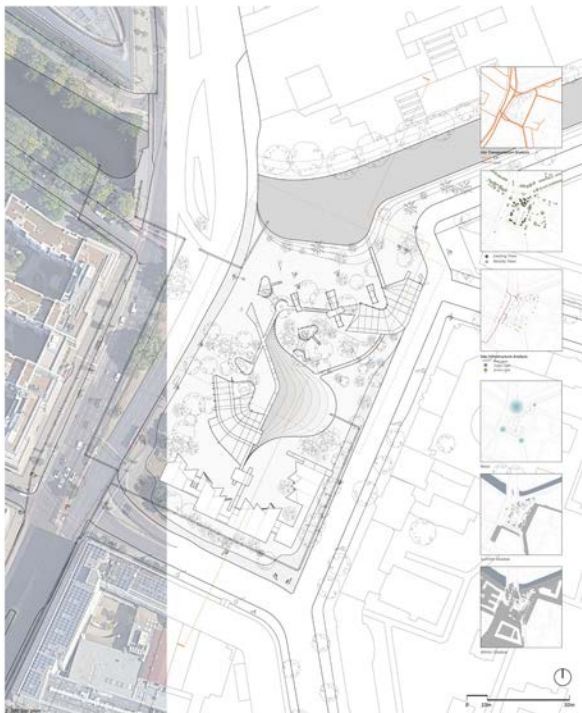





## EMBASSY OF NON-HUMAN BEINGS

Inspired by the ecology, an ensemble of buildings set amidst generous open green spaces, our project begins with Field Ecology as the master plan & a visible structure within. Together, in an alternative approach to form, to restore our architectural presence of landscape, we create a harmonious coexistence between human & non-human actors an Embassy of Non-human Being. The key to this coexistence lies in creating spaces to enable a meeting ground, which offers a habitable habitat. Habitat structures are positioned around the edge while non-humans like the central ridge is an embodiment of this social coexistence. The lighting installation supports conventional green & dark lights to encourage this behavioral habitat. Trees are selected to support and newly planted trees they form a shaded, humid microclimate. Animal's droppings are collected & used as fertilizer, returning to the fertile soil. In essence, our vision for landscape transcends the conventional, weaving together the threads of history, innovation, and environmental stewardship, to create a habitable urban space in dynamic equilibrium, fostering a symbiotic connection between humanity & the natural world—an embassy where both the user & the urban context in a shared language of mutual thriving & sustainability.



1 Kinder Showing more shelter and lamp



2 Boulder Showing Rain Shelter and Urban Form



3 3D Detail Section of Conventional Pedestal



# 01

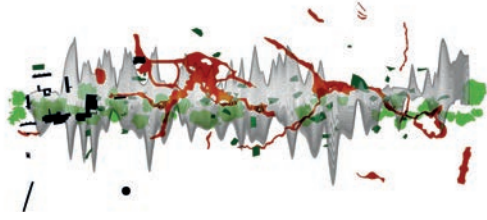

## HYBRID NETWORKS

### EMBASSY OF NON-HUMAN BEINGS

ANDONG GUO  
BOLUN HUA  
SHIYU ZHANG

This project aims to create a space dedicated to animate non-humans within Tiergarten area. Situated within the south axis of Tiergarten, an undeveloped green space within the Diplomatic Quarter becomes a home for animate beings in Berlin. Adapting the concept of Bruno Latour's Actors Network Theory, an Embassy for the Non-Human Beings is proposed to empower the voiceless with same rights as human beings. This embassy invites small mammals, birds, insects and vegetation into the Lützowplatz Park for sanctuary and habitation while scientists offer support and monitor their activities. A nature-dominated landscape is interwoven within the urban tapestry which blurs the boundary of 'building' and 'park', a hybrid network for both to interact. The bird tower in the north demonstrates a close relationship between site and Landwehr Canal, providing habitats and nesting spaces at various heights. The greenhouse in the west doubles as a research lab, housing vertical ecology systems. Surface water in pipes is utilized as a water source, ensuring sustainability and resilience. The coexisting residence aims to achieve equality between all inhabitants with spacious sheltered areas and compact living spaces for humans, while ha-ha walls minimize human disturbance. The project trajectory spans 20 years, envisioning the establishment of similar embassies across Germany. Hybrid Networks aims to foster biodiversity and create a thriving environment for a wide range of species. This project seeks to redefine the relationship between urban environments and the natural world, offering a beacon of hope for coexistence and ecological harmony in the heart of Berlin.







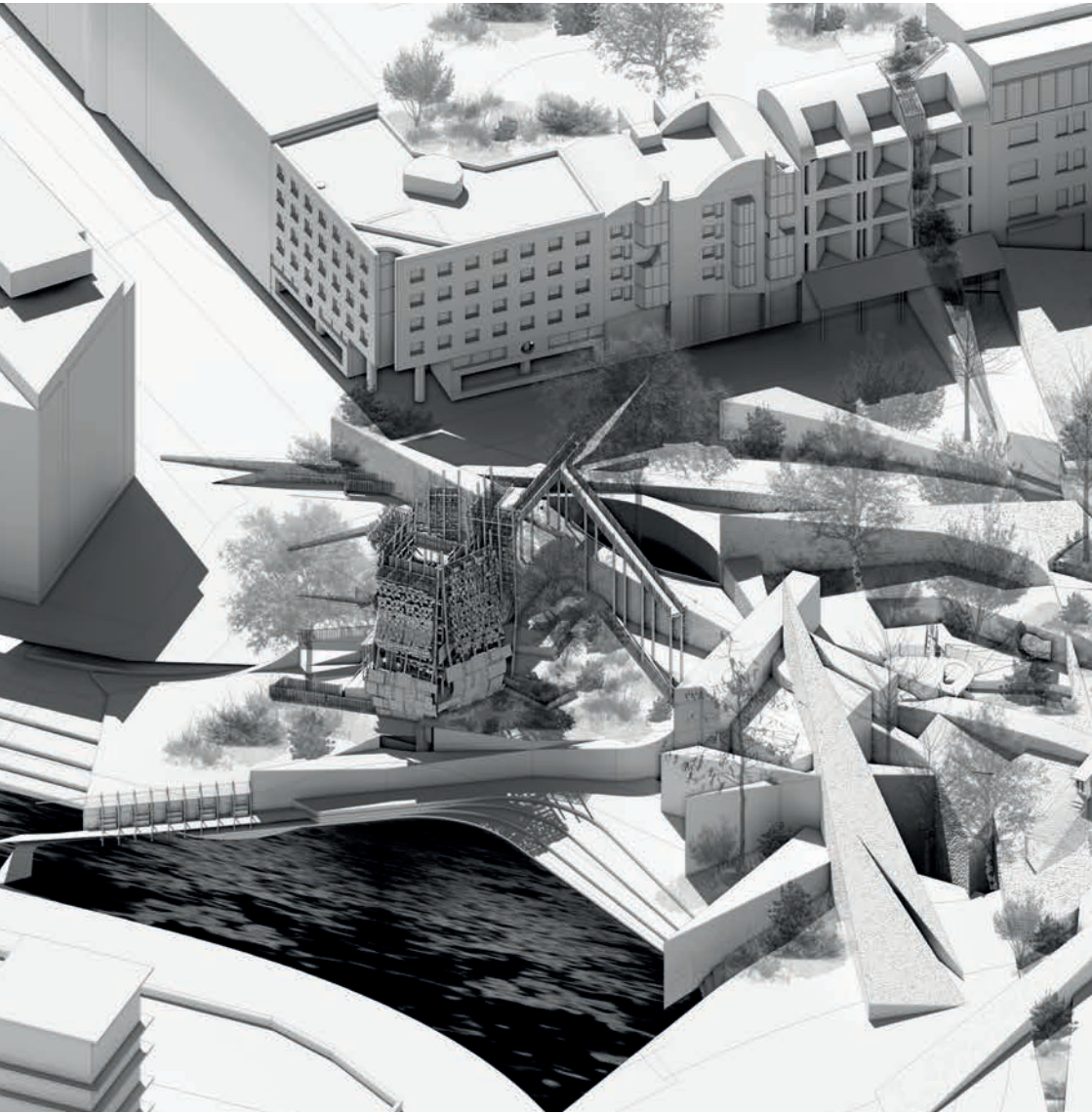

---

Remapping 'Tokens' onto a digital landscape - multiple scales (previous thumbnail)

Plan iteration (previous right)

Final Proposal Axonometric from North West (above)

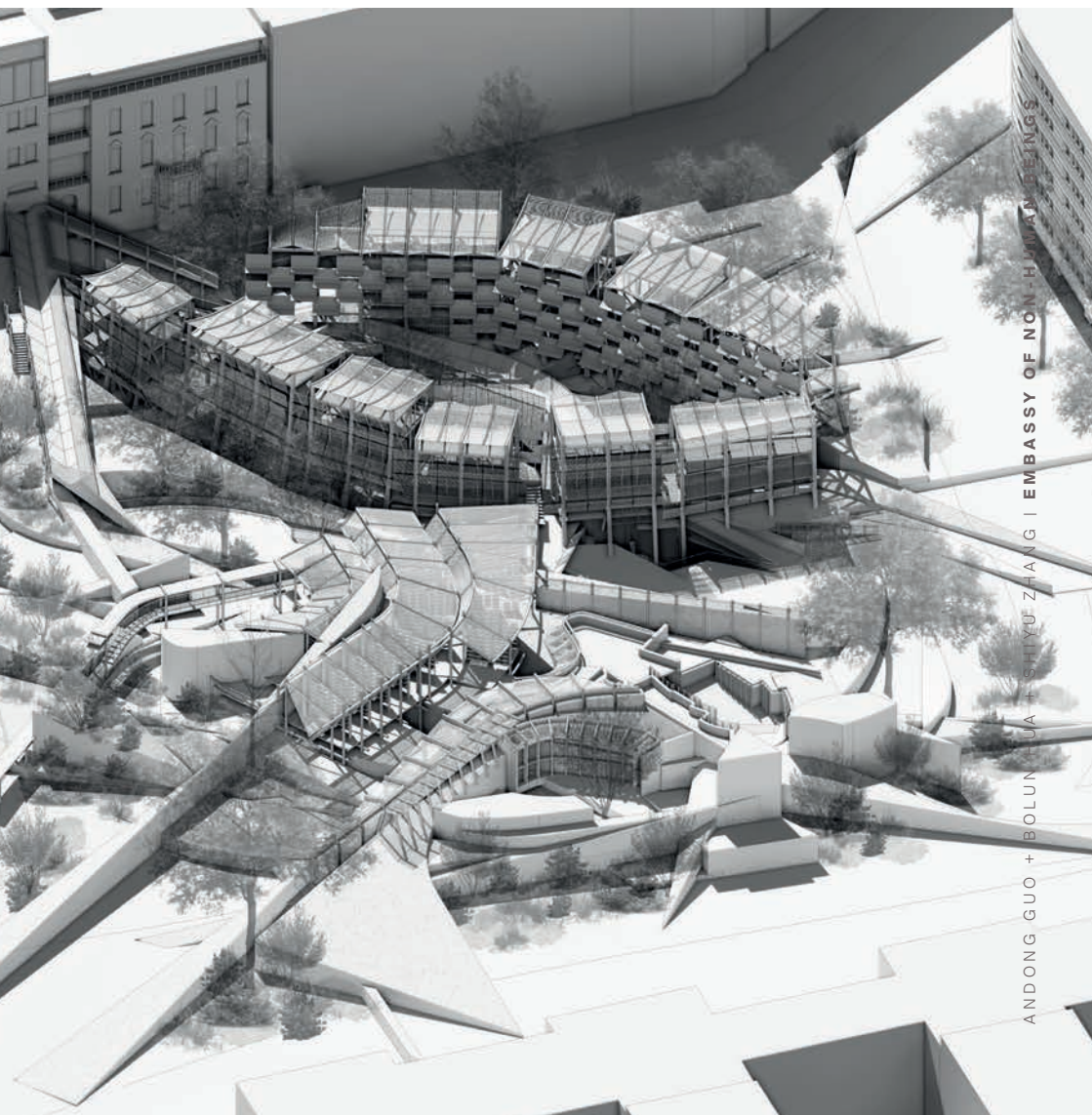

ANDONG GUO + BOLUN JIA + SHIYU ZHANG | EMBASSY OF NON-HUMAN FEELINGS



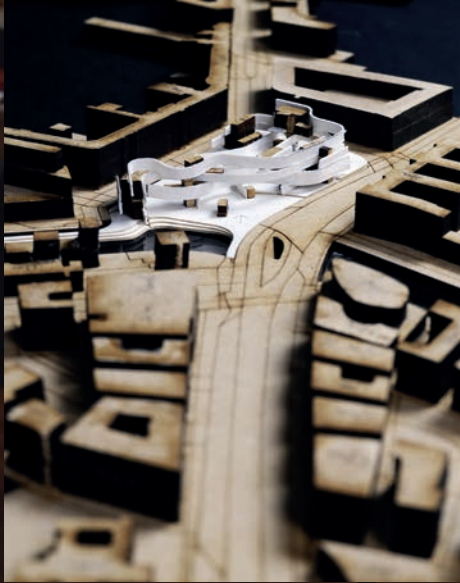

1:2000 Urban Scale model iteration detail (left inset)

1:2000 Urban Scale model in exhibition (above)

Juxtaposed journey - Tiergarten - Lutzopplatz (adjacent right)





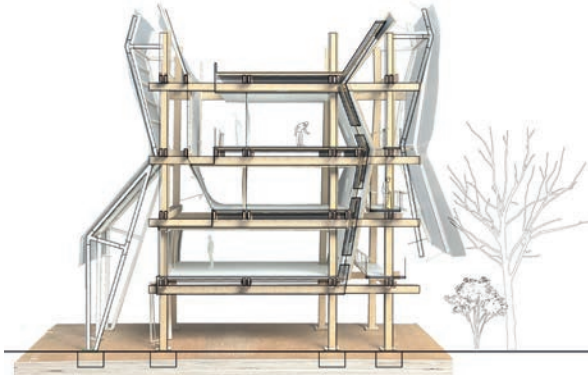

Residence of Co-existence 1:50 model (top left and right)  
 Bird Observation Tower facade build up (adjacent top)  
 Ecological Laboratory section (bottom)

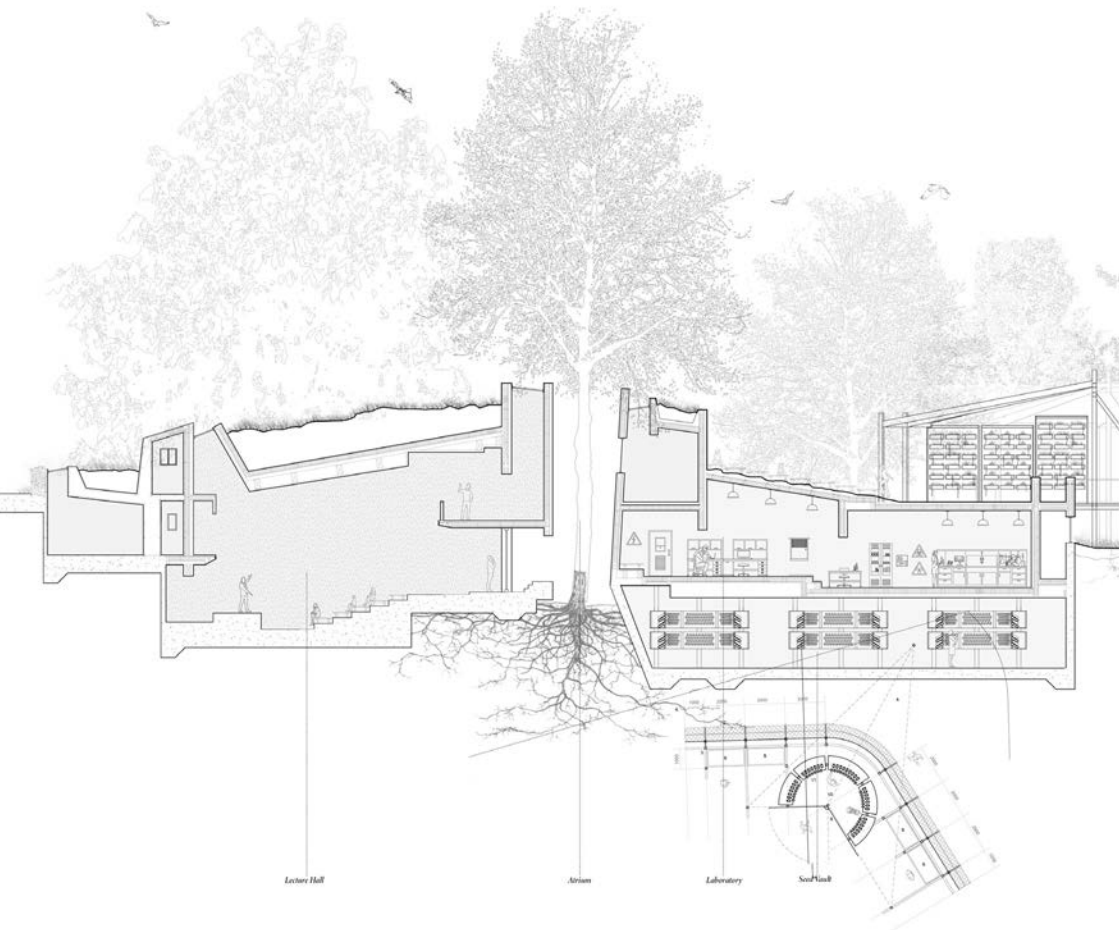

Lecture Hall

Atrium

Laboratory

Sun Plaza

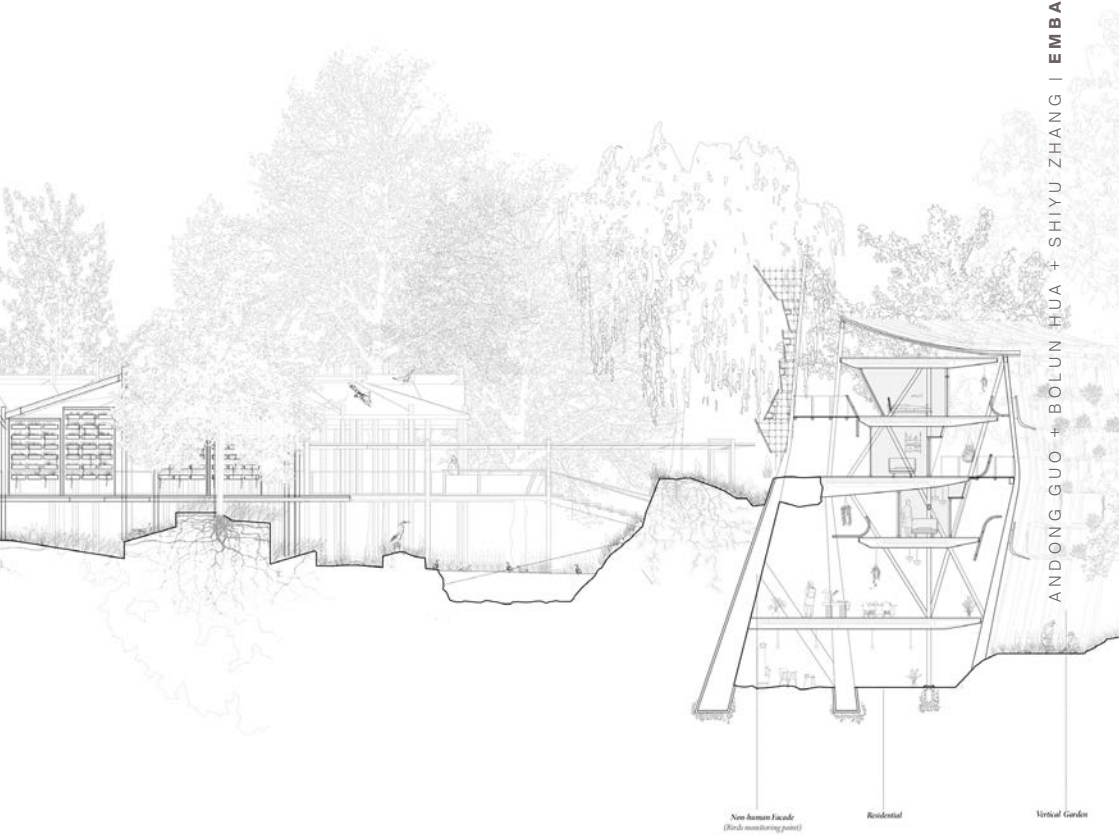
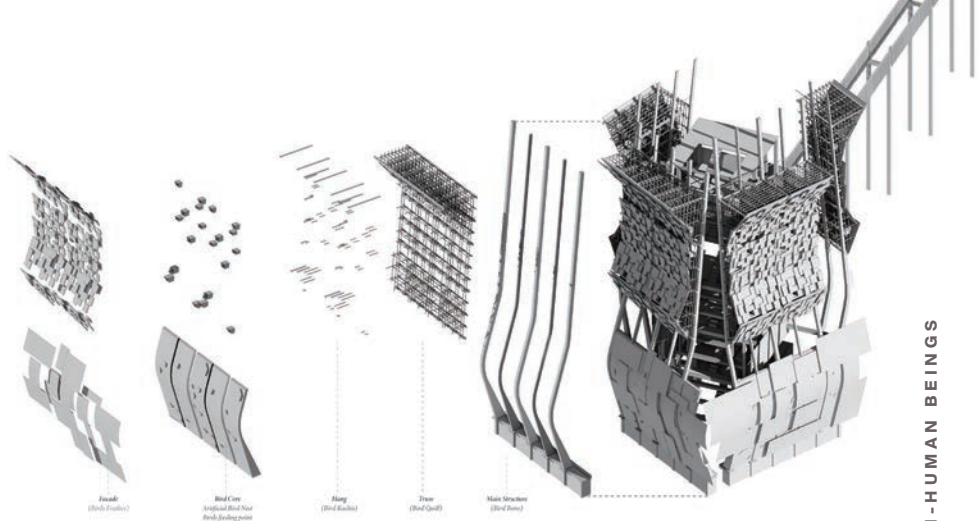



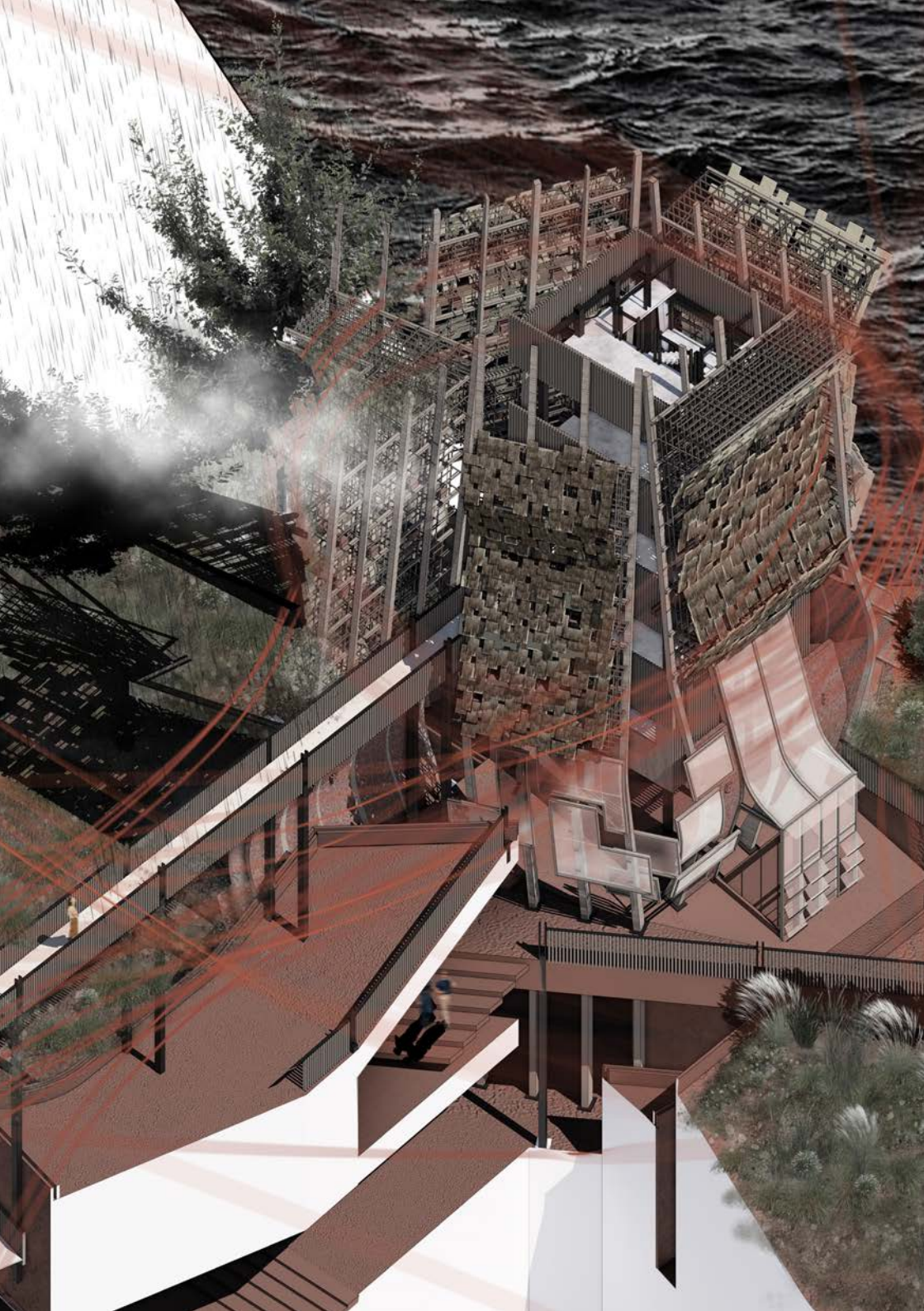



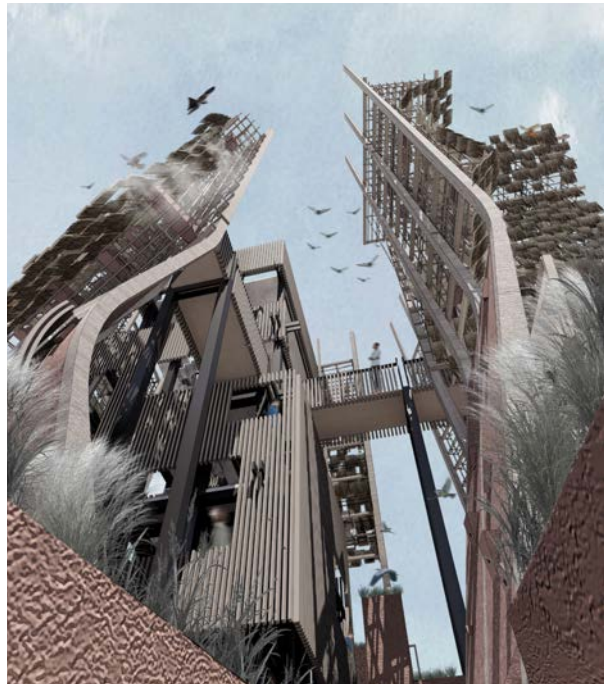

ANDONG GUO + BOLUN HUA + SHIYU ZHANG | EMBASSY OF NON-HUMAN BEINGS

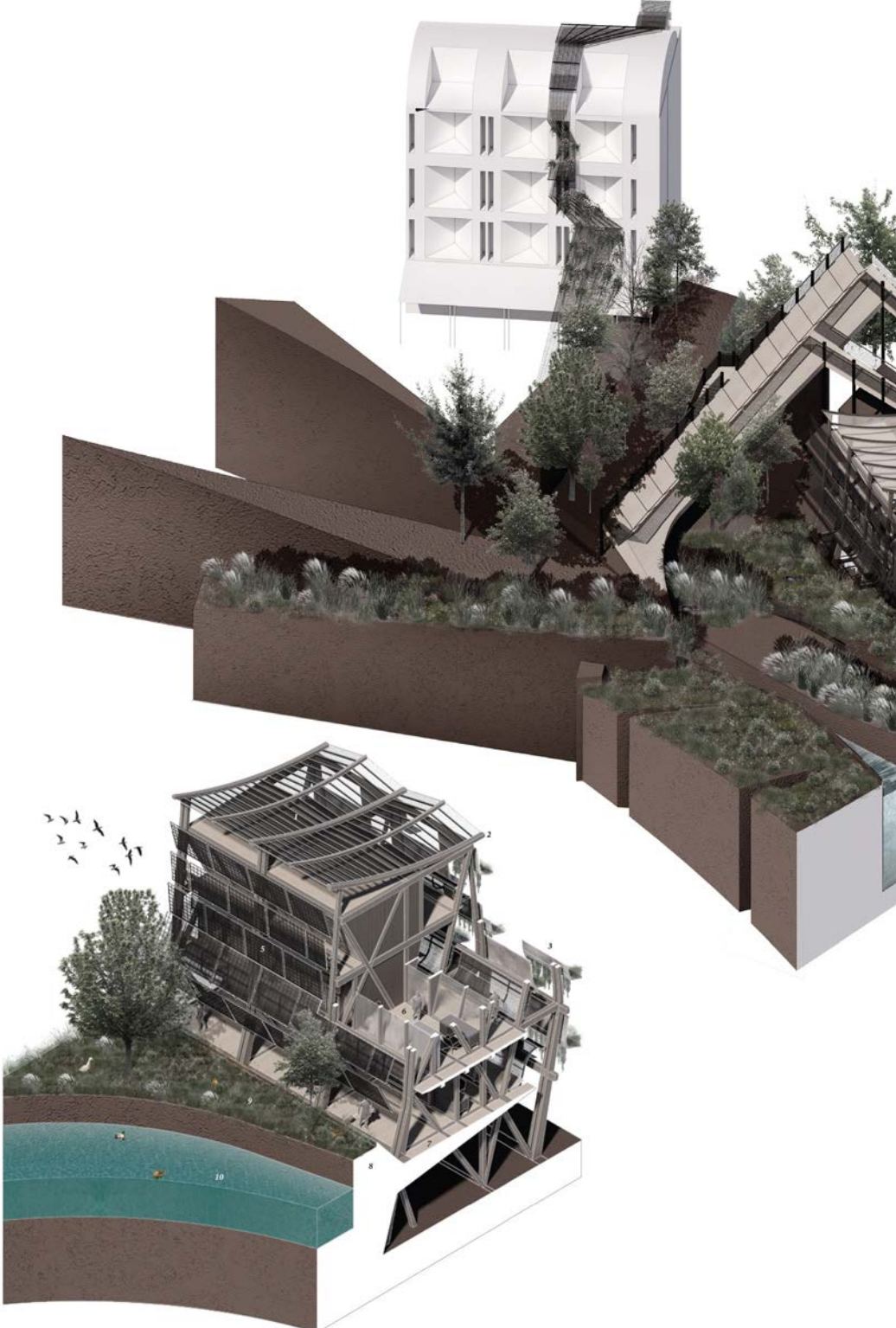



Bird Observation Tower rendering (previous left)

Bird Observation Tower perspectives (previous right)

Residence of Co-existence sectional perspectives (middle & bottom left)

Residence of Co-existence courtyard perspective (below)

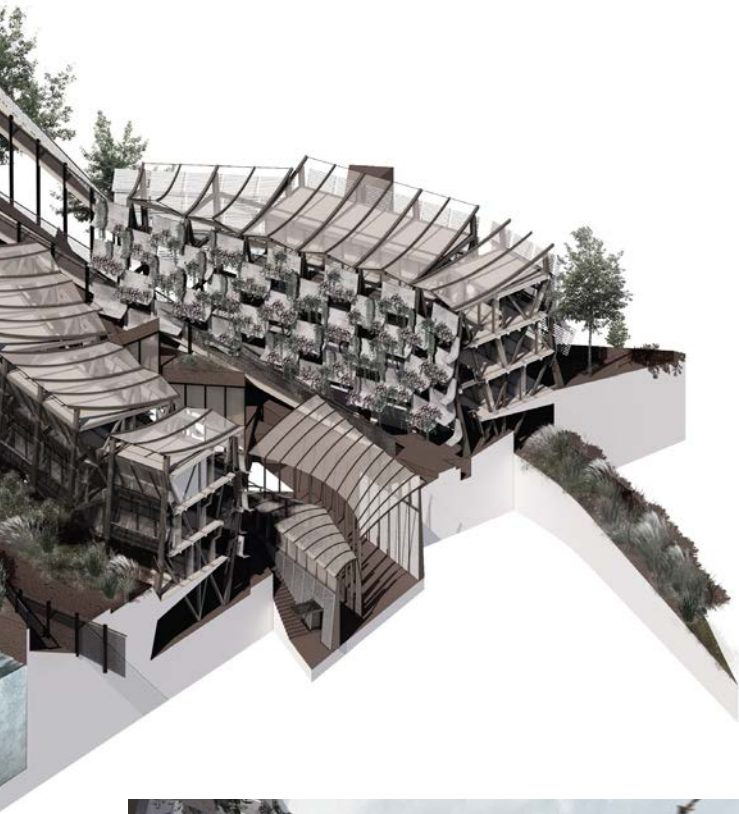

# Lending Libraries for a Permeable City

Unlocking Potential in Urban Peripheries

Targarten  
52 ROOMS | 13.84.2019

**Targarten's Natural Climatic Shelter**

- The building is designed to take full advantage of the natural shelter provided by the surrounding forest.
- The building's orientation and form are optimized to maximize natural ventilation and minimize energy consumption.
- The building's design is inspired by the natural shelter provided by the surrounding forest.



## Urban Protocol: Inhabiting Urban and Parkland Forests

Targarten



## Urban Protocol: Interventions in Bülowstraße Urban Neighborhood

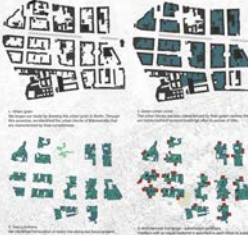

Lending Library Model

**Lending Library Model**

- The building is designed to provide a flexible space for community activities and events.
- The building's design is inspired by the concept of a lending library, where resources are shared and accessible to all.



The information for this project was provided by the client and is subject to change without notice. The information is provided for informational purposes only and does not constitute an offer or any other financial product. The information is provided for informational purposes only and does not constitute an offer or any other financial product. The information is provided for informational purposes only and does not constitute an offer or any other financial product.





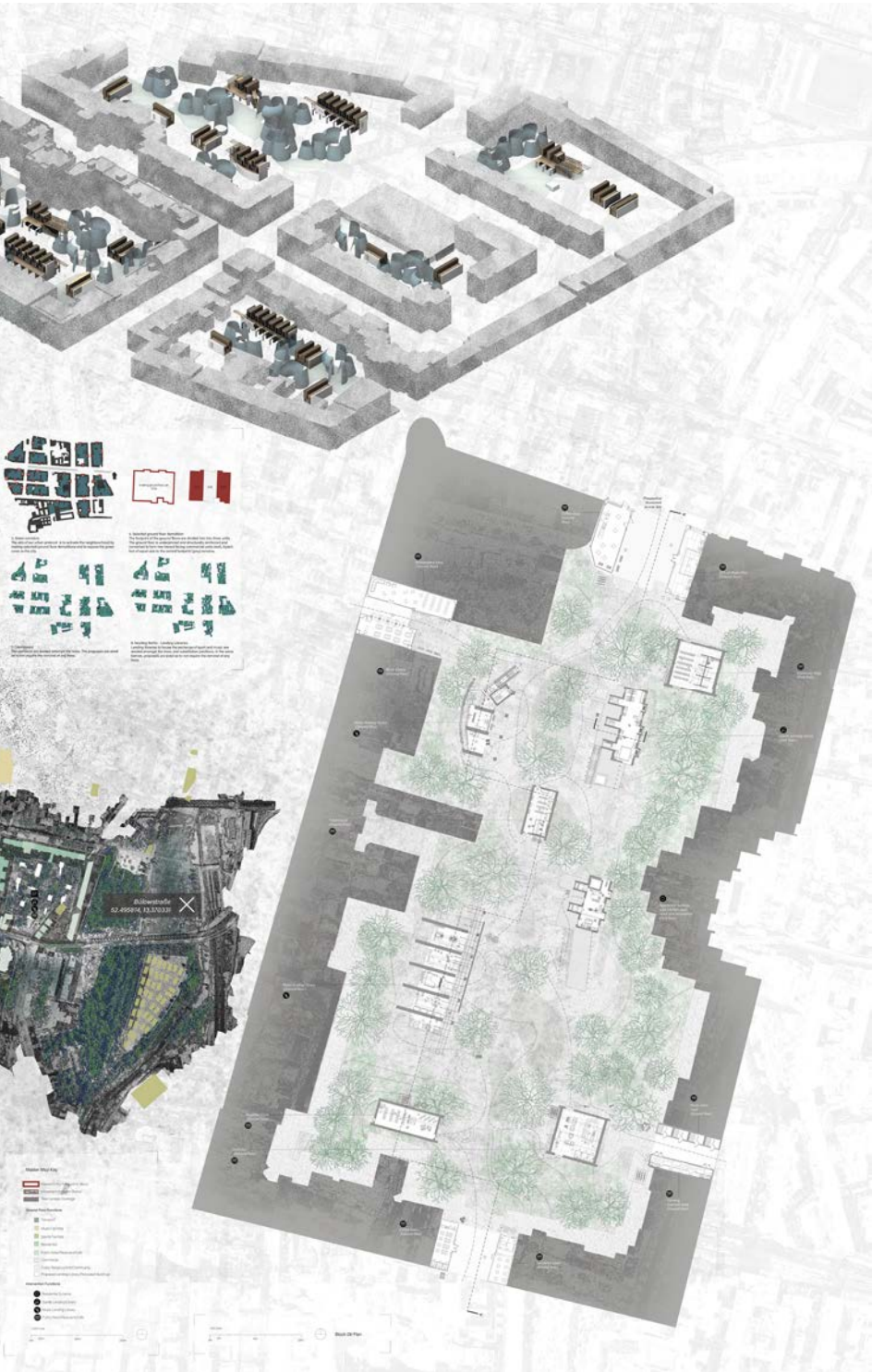



# 02



## URBAN POROSITY

### LENDING LIBRARIES FOR INNER CITY URBAN BLOCKS

FOLAHAN ADELAKUN  
CARL HARRIS  
OLIVER MAXWELL

In and amongst the vibrant pulse of Berlin's urban expanse, the promenade winds its path through the streets of the bustling city. Here, amidst the thrum of urban rhythms, the Bülowstraße bridge stands sentinel, a titan of time – connecting the city of yesterday and tomorrow.

Towards an opportunity for intervention. Of urban harmony...

Once cloistered havens, the impermeable private blocks of Bülowstraße now yearn for liberation, shedding their walls to embrace the communal. No longer fortresses of exclusivity, they now beckon to all, transformed into delicately composed hubs of activity.

In this metamorphosis, the Berlin block becomes a canvas for innovation, a stage for the dance of leisure and community. Music, Craft, and Sport take centre stage, weaving a tapestry of cultural exchange and kinship among Bülowstraße' denizens and beyond.

As the architecture shifts over time, it breathes with the city's pulsing beckon for resilience and adaptability. Modular and fluid, these structures become vessels of transformation, reflecting the ebb and flow of urban life. Branching off, from the span of the Bülowstraße' bridge a harmony between humanity and nature is unfolded. Enabling the thriving of the vibrant ecologies that dwell within and without, animating a porosity of movement amongst human and non-human protagonists.

Within the beating heart of Bülowstraße, the trinity of community, nature, and culture converges in a kaleidoscope of care, nurturing, and vitality, ushering forth a new dawn in the great city's eternal symphony.

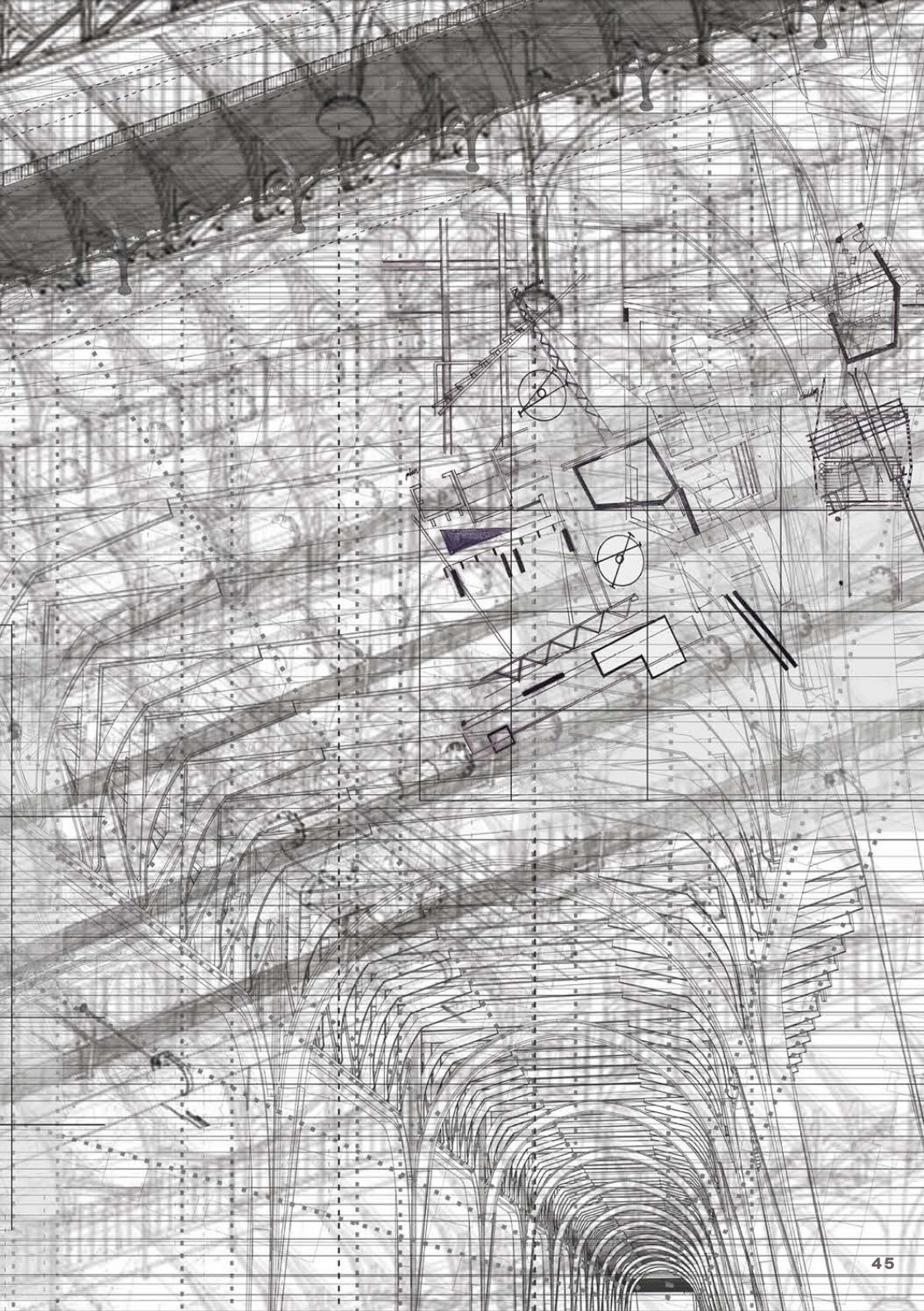



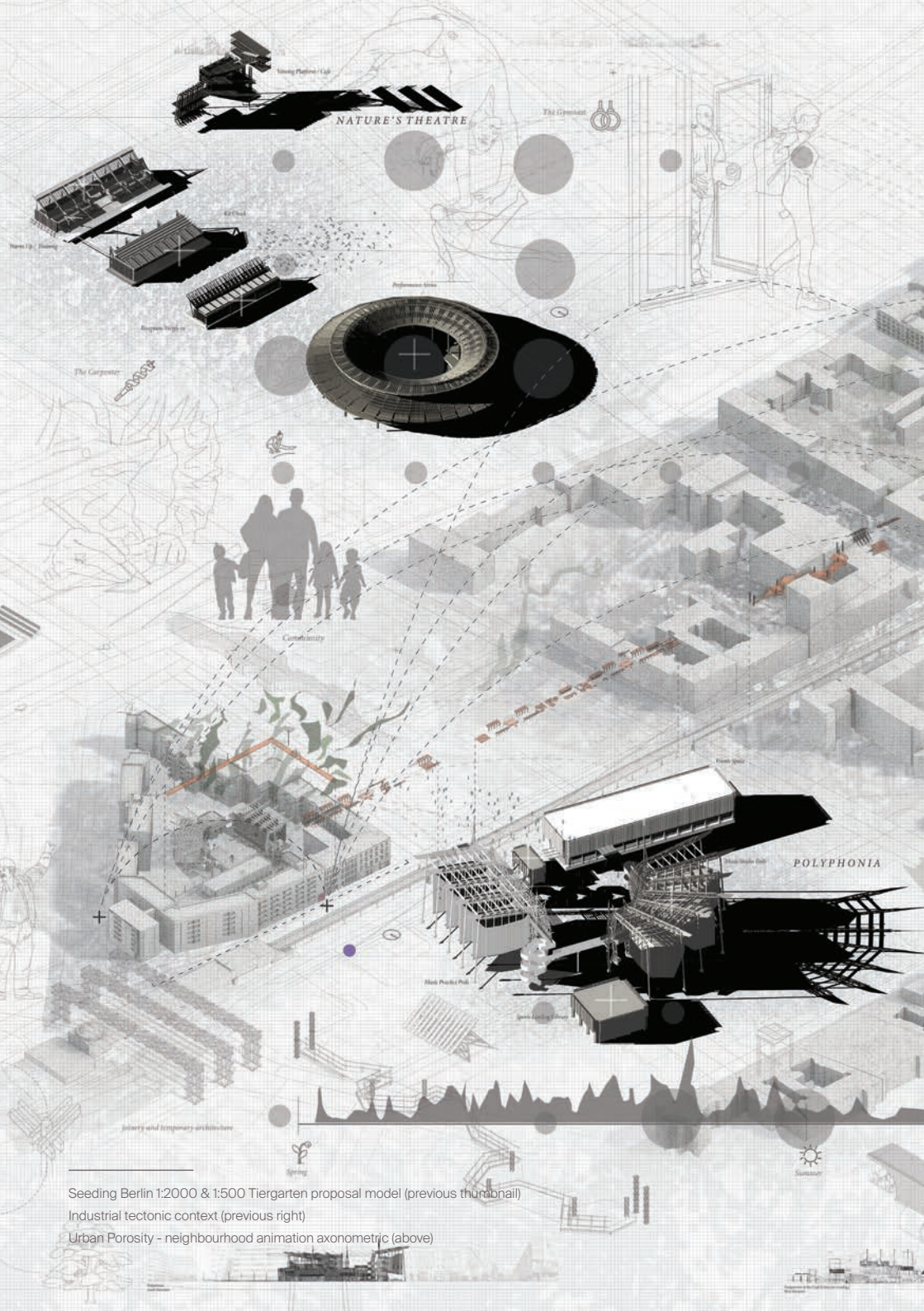

NATURE'S THEATRE

POLYPHONIA

Seeding Berlin 1:2000 & 1:500 Tiergarten proposal model (previous thumbnail)

Industrial tectonic context (previous right)

Urban Porosity - neighbourhood animation axonometric (above)







Street Furniture



Autumn



Winter

Carbon offsetting

Biodiversity potential

Disability

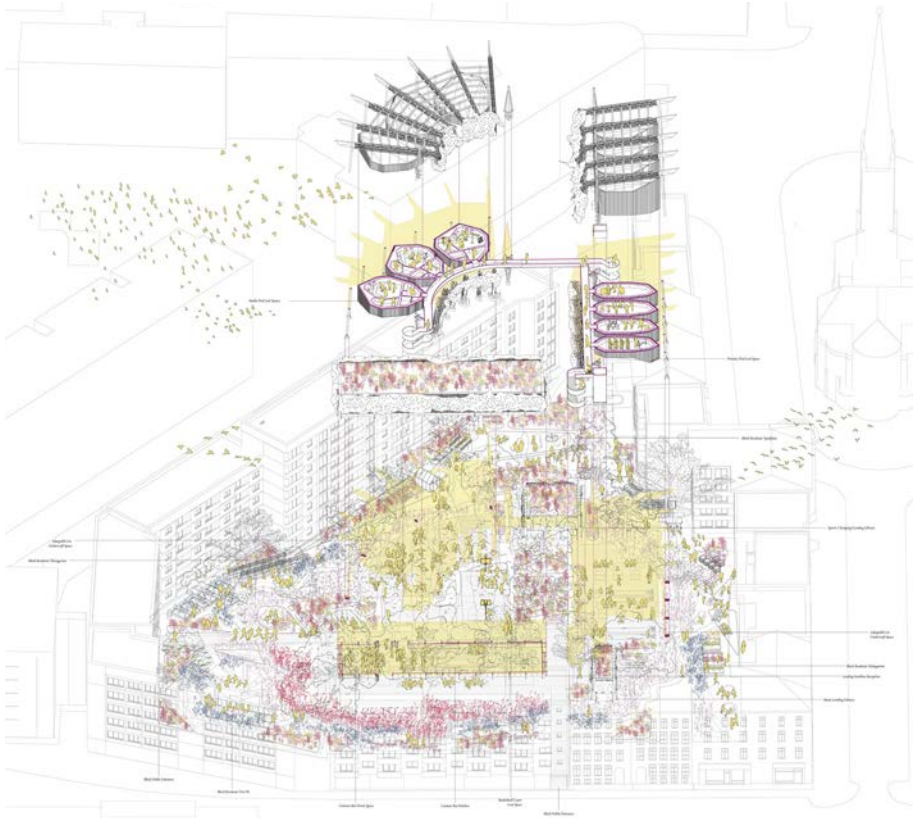





Polyphonia habitation axonometric (adjacent top)  
 Tiergarten in motion - visualisation (adjacent bottom) +  
 Polyphonia - community garden perspective (above)  
 Polyphonia - habitation section (below)

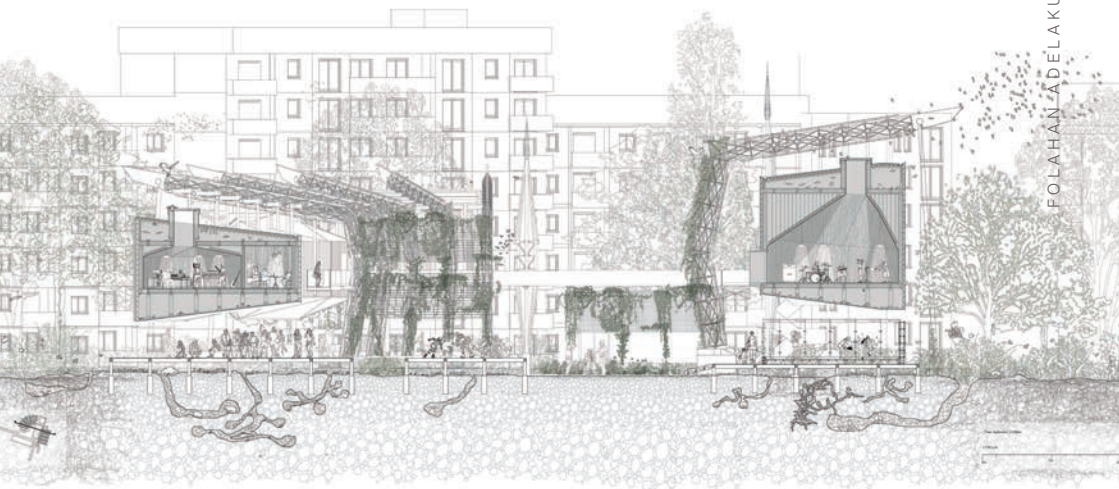





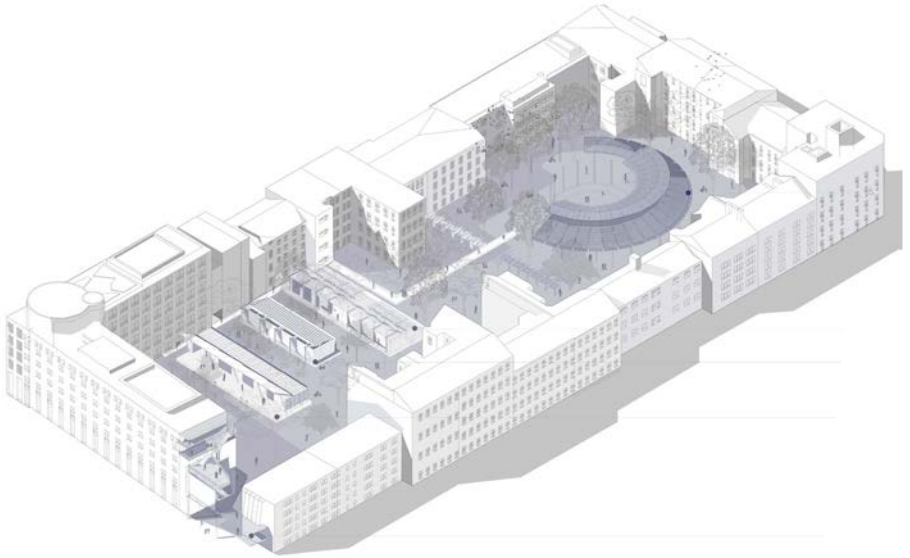

Seeding Berlin - maquette (adjacent top)  
Nature's Theatre - auditorium perspective - (adjacent middle) +  
Nature's Theatre - block axonometric (above)  
Nature's Theatre - habitation section (below)

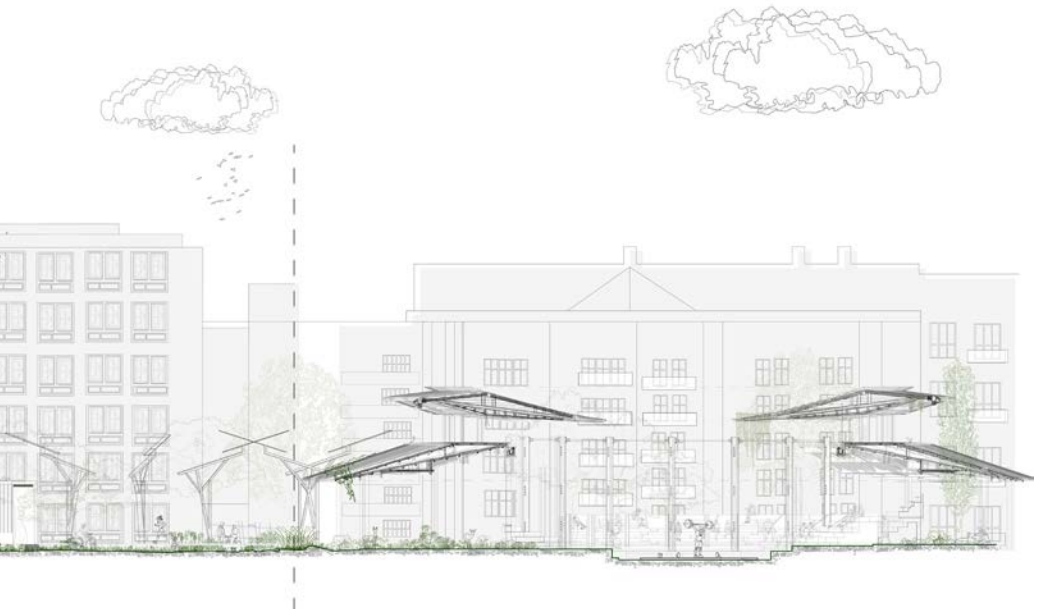



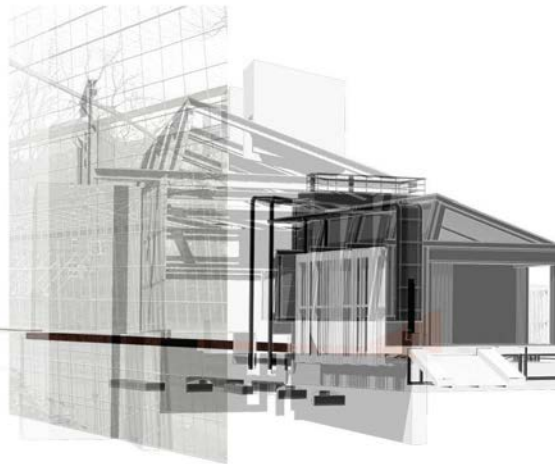
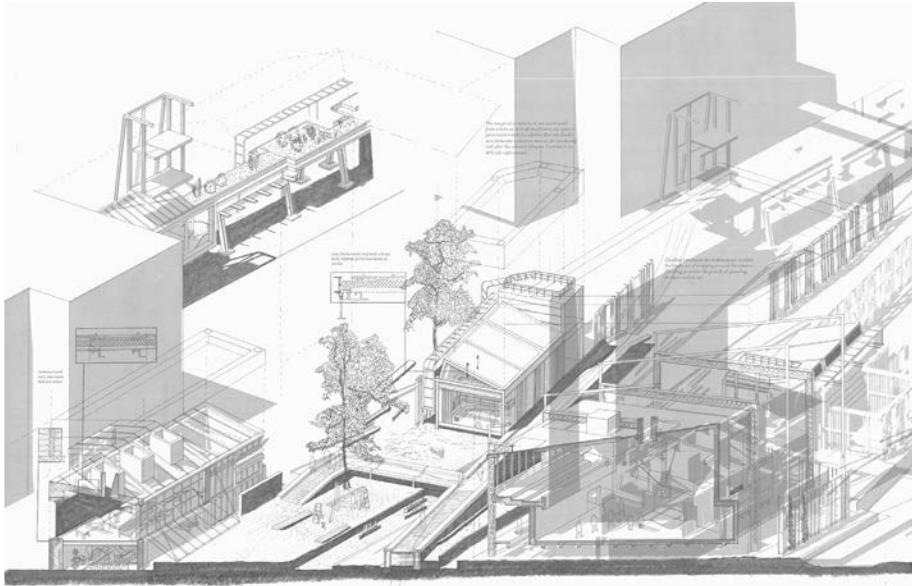

Components of the Craft - tectonic section (top)

Components of the Craft - habitation section (above middle)

Components of Craft - perspective (bottom)



Components of the Craft - tectonic study model (above left) +  
Components of the Craft - arboricultural plan (above right)

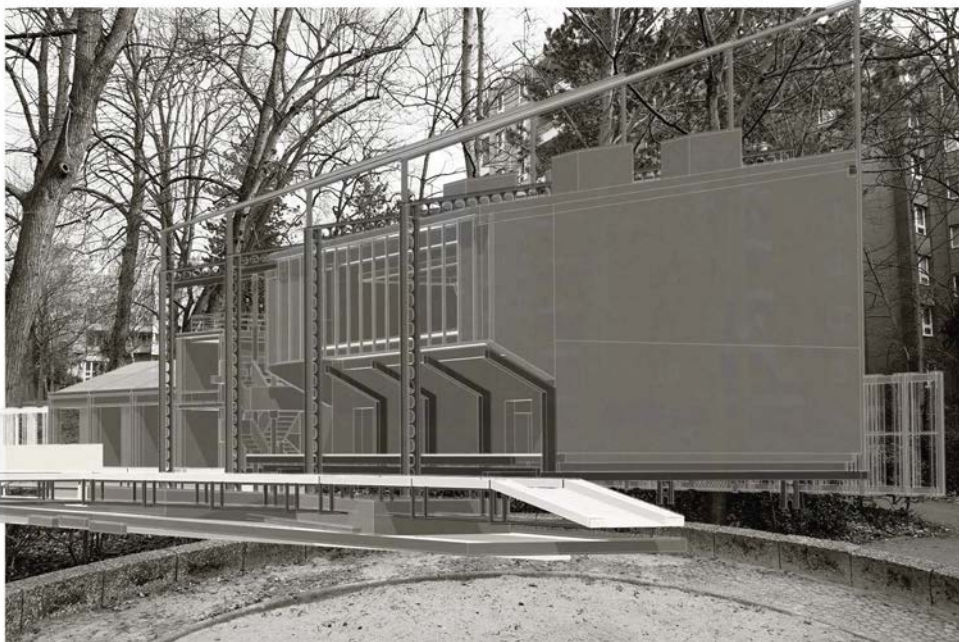

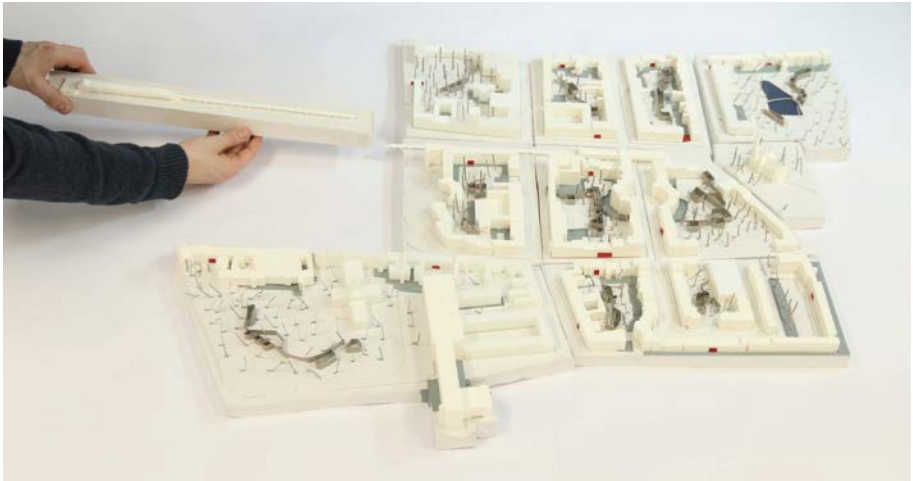

Neighbourhood intervention model (above)

Components of the Craft - Potsdamer Strasse perspective (adjacent top)

Bülöwstraße U-Bahn festival site (below)

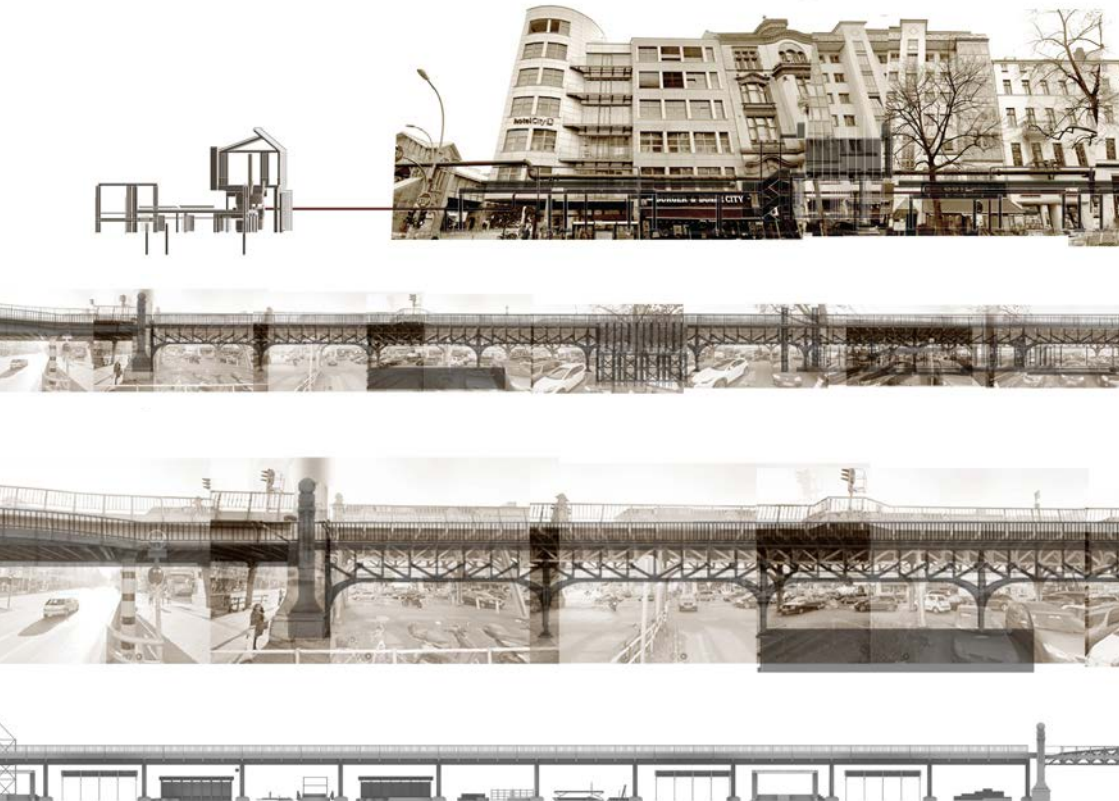



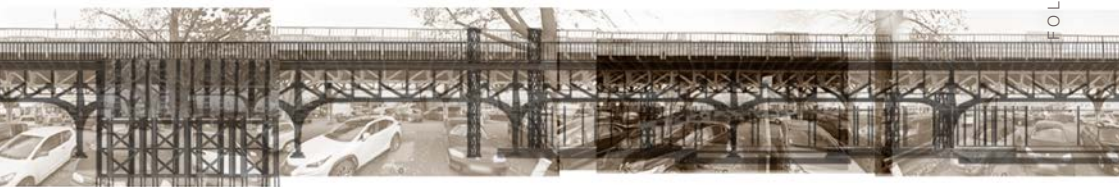

FOLAHAN ADELKUN + CARL HARRIS + OLIVER MAXWELL

# Berlin's Blocks to Rewilding Plots

Warehouse to Birdhouse: Revitalizing Grey Area Lots in Berlin

In the heart of the city of Berlin, where the hands and hearts of urban life intersect with the whispers of our rain, an outlook on an ambitious journey to redefine this historic and now-broken landscape. Our goal is not just to restore, but to actively engage with the city's ecological systems, utilizing cutting-edge technology to bridge the gap between human progression and the often-overlooked success of urban ecology.

The Urban Block to Rewilding Plan primarily focuses on manufacturing an industrial site, previously utilized for car rental and storage, into a rewilding and ecological development. Situated on the right side of the New Zoo Park in Berlin, we draw inspiration from the city's historical transformation of industrial sites into green spaces. Through a multi-phase process to create habitats for birds and bees, the design we achieved the design intent to balance human and non-human ecology, mitigating the impact of climate change and biodiversity loss, ultimately shaping the future of urban nature.

The full of technology in design and implementation cover rights. From our own green roof to an urban farm to be fully automated, reducing spatial demands for parking and plant facilities through structural and efficient automation processes. The rewilding and manufacturing of abandoned even functional industrial sites we re-imagined our commitment to sustainable development and ecological harmony. The proposal seeks to build upon the rich history of this urban block, a multifunctional space that combines housing, dining, and sporting areas with an unexpected blue factory that uses a hybrid greenhouse and ecological area.





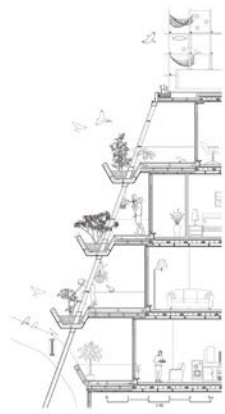
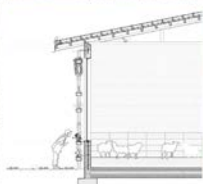
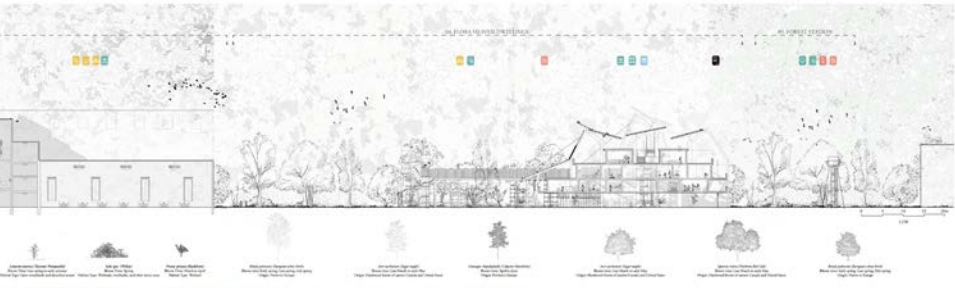

**TECHNICAL SPECIFICATIONS FOR MECHANICAL LIFT SYSTEMS**  
 1. Max. Load Capacity: 1000 kg  
 2. Max. Travel Distance: 10m  
 3. Max. Travel Time: 10s  
 4. Max. Travel Speed: 1m/s  
 5. Max. Travel Acceleration: 1m/s²

**COMMON LIVING ENVIRONMENT DESIGN**  
 1. Max. Floor Area: 100m²  
 2. Max. Floor Height: 3m  
 3. Max. Floor Slope: 1:10  
 4. Max. Floor Level: 10m  
 5. Max. Floor Level Difference: 1m

**MAX. 10m Floor Area**  
 1. Max. Floor Area: 100m²  
 2. Max. Floor Height: 3m  
 3. Max. Floor Slope: 1:10  
 4. Max. Floor Level: 10m  
 5. Max. Floor Level Difference: 1m



# 03



## BERLIN'S BLOCKS TO REWILDING PLOTS

### WAREHOUSE TO BIRDHOUSE

**TERRY FENG**  
**KIM LEE**  
**BINGZHI LI**

The project represents an extensive revitalization aimed at redefining the relationship between humanity, non-humans, and the environment within urban landscapes. In this context, revitalization refers to the process of adapting building structures to meet changing user requirements while honouring Berlin's tradition of transforming industrial sites into green spaces. Our mission is to engage with the city's ecological narrative and address the pressing challenges of climate change and biodiversity loss. Our design draws inspiration from 19th-century Schrebergärten (allotment gardens) and railway wasteland transformation. The project retains the steel frames (or useful concrete structure) of existing industrial buildings, introducing sustainable pavilions and architecture that promote a harmonious balance between human habitation and rewilding. We incorporate community farming, plant nurseries, and vertical gardening to facilitate this transformation. A core aspect of the development is the 15 to 30-minute city concept, where residents have convenient access to services within a short distance. In the first part of our project (the competition phase), we transformed a former postal service centre, car dealership and repair station, and an unoccupied beer factory site into a hybrid greenhouse and residential area. Subsequently, we proposed converting warehouses, abandoned offices, and parking lots into a primary school, sports pitches, a day care centre, a community centre/performance hall, residential areas, a furniture factory, and a market. This setup encourages community cohesion and reduces commuting, promoting a sustainable urban lifestyle.



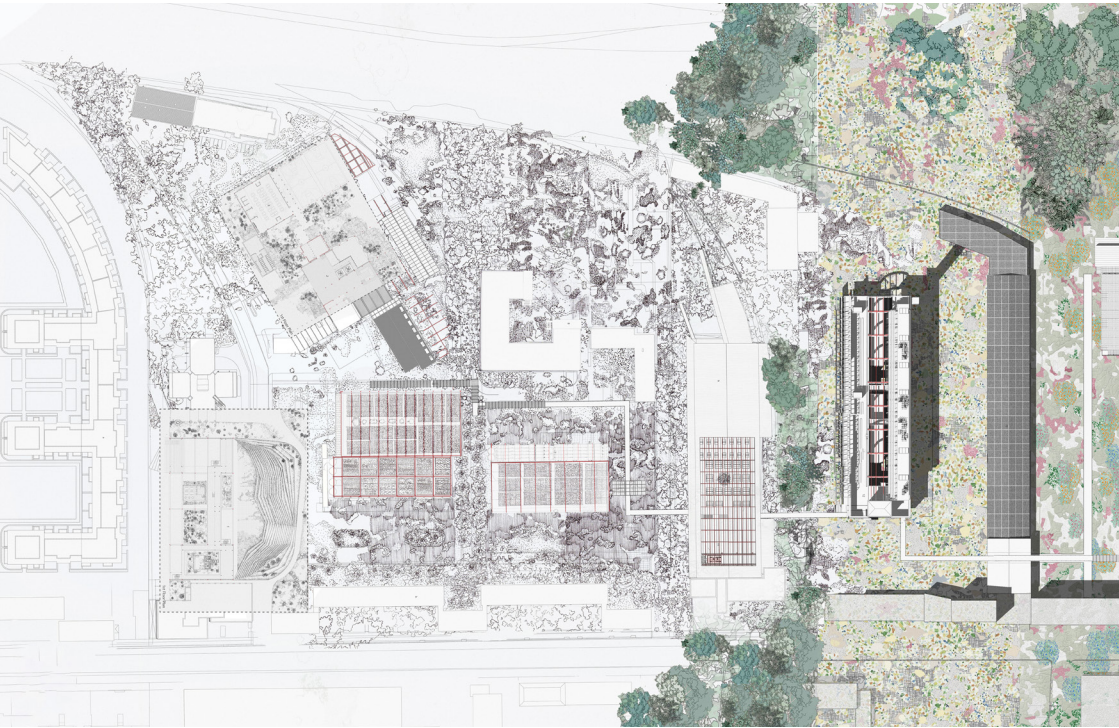

Observation tower model (previous thumbnail)

Rail side Industrial Rejuvenation: Rewilding along railway lines (previous right)

Rewilded site plan and corresponding scheme section (above)

Farmland with intensive agriculture building perspective (adjacent bottom)

Farmland with intensive agriculture building section (below)







TERRY FENG + KIM LEE + BINGZHI LI | BERLIN'S BLOCKS TO REWILDING PLOTS





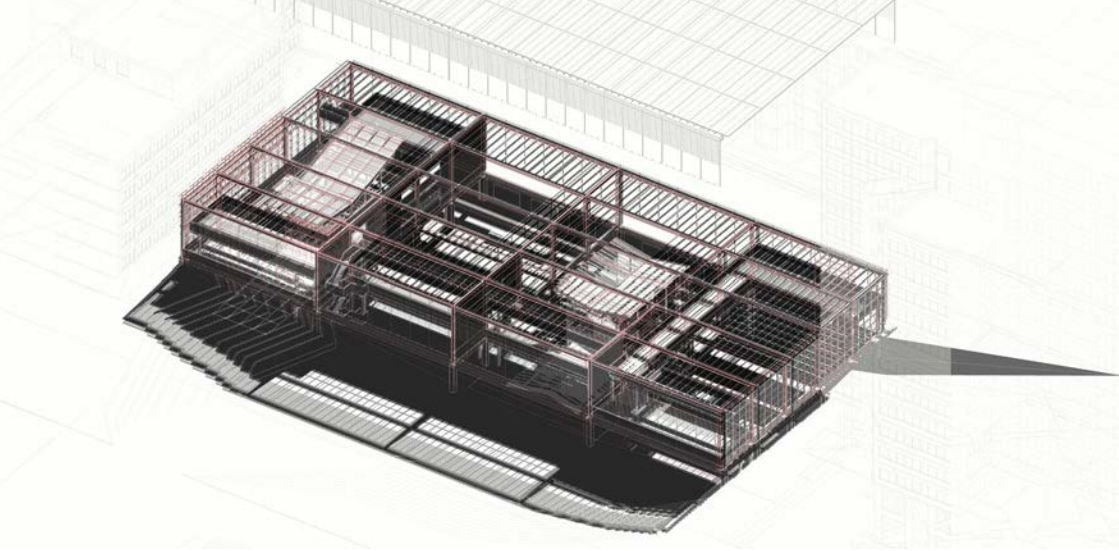



Enclave Hall - structural axonometric (adjacent top)  
Enclave Hall - visualisations (adjacent middle and above)  
Scheme section - part 1 (below)







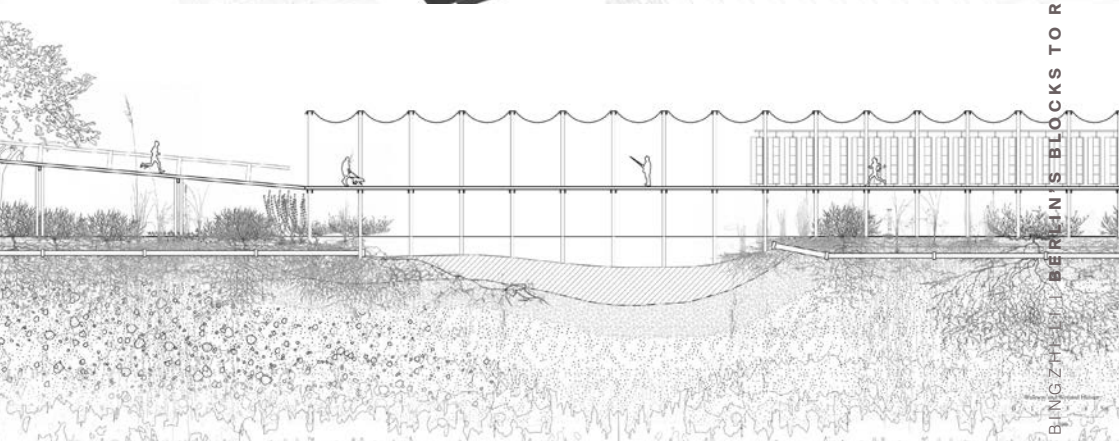
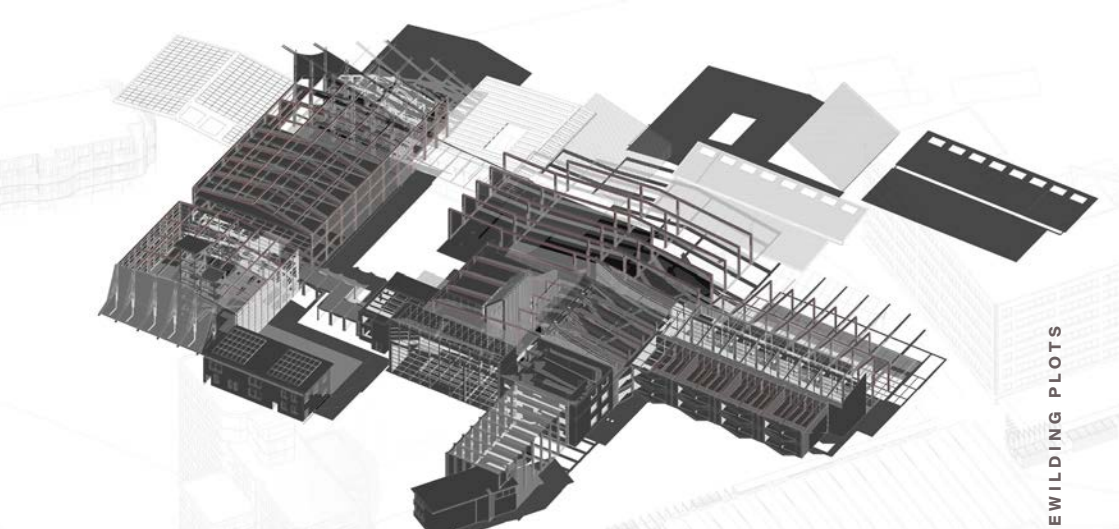

- Primary school interior visualisation (adjacent top)
- Primary school and daycare centre garden visualisation (adjacent middle)
- Primary school and daycare centre - structural axonometric (top)
- Rewilded elevated walkway section (above)
- Scheme section - part 2 (below)



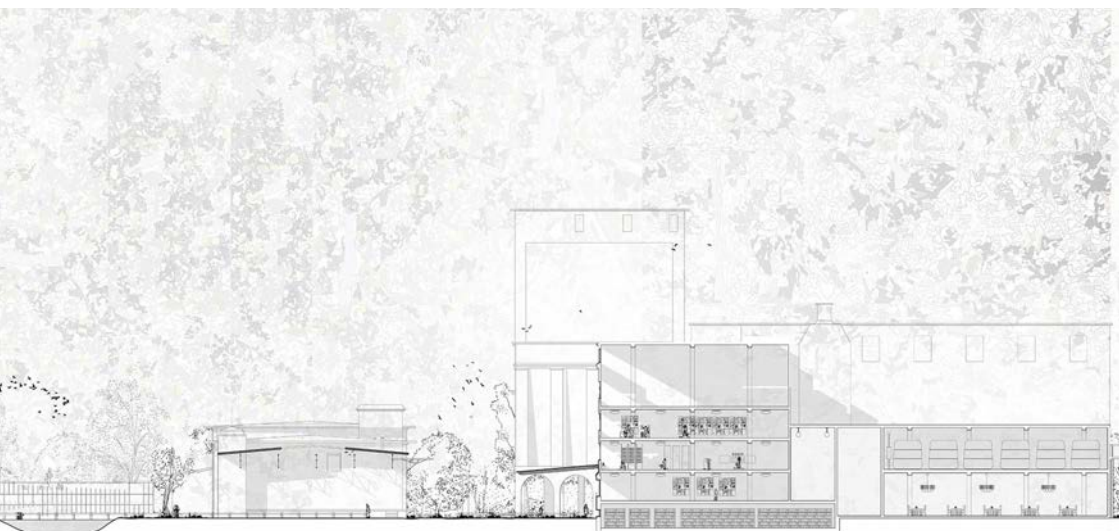
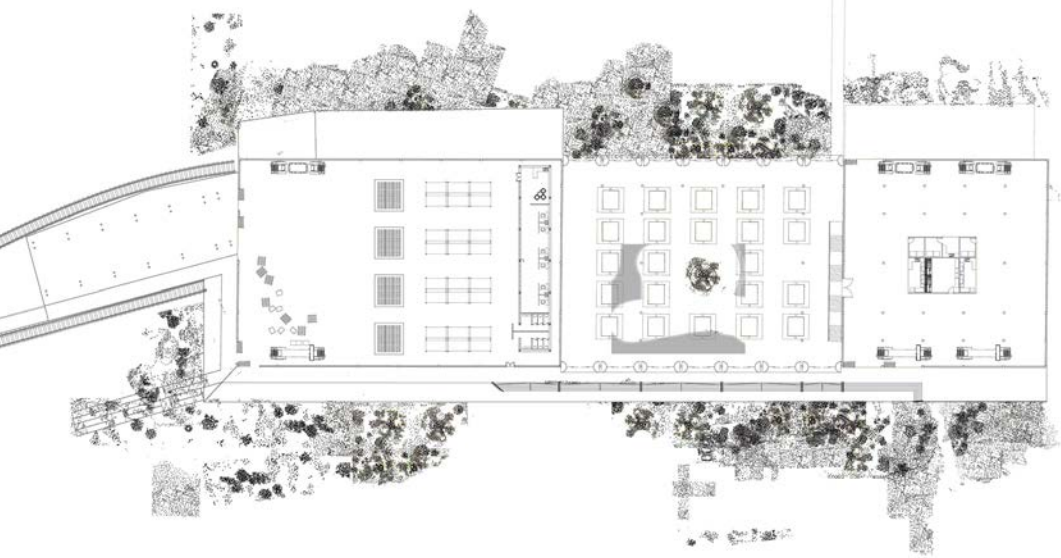



Harvest Junction Depot, Market & Communal Kitchen plan (adjacent top)  
Central Market visualisation (adjacent middle)  
Field Station - Site Monitoring Station (above)  
Scheme section - part 3 (below)







---

Rewilding Device Workshop visualisation (above)

Harvest Junction warehouse (adjacent top)

Scheme section - part 4 (below)

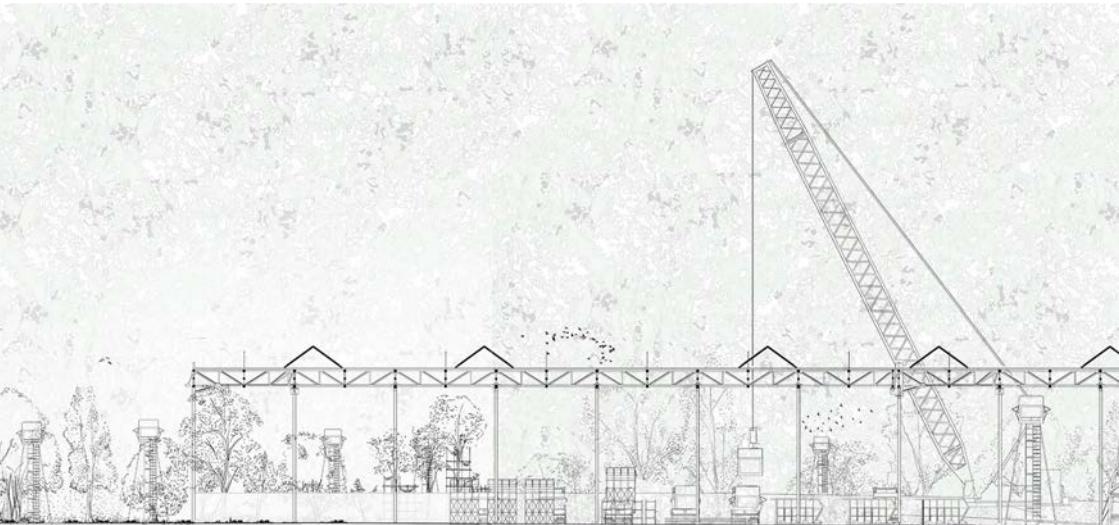



TERRY FENG + KIM LEE + BINGZHI LI | BERLIN'S BLOCKS TO REWILDING PLOTS

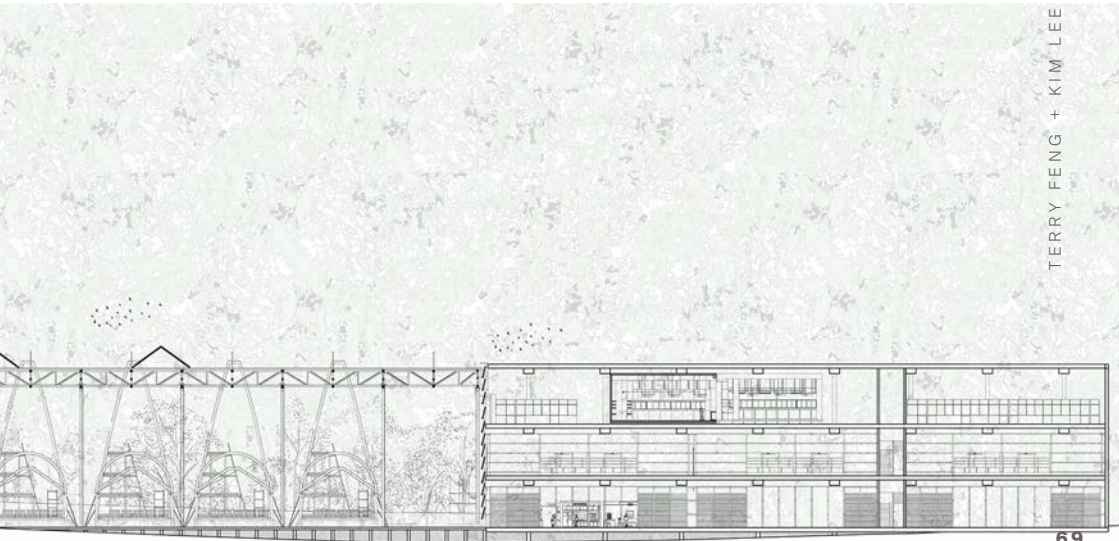



# INTERWEAVING HABITATS

A More-than-Human Infrastructure for Landswehrkanal

Mixing natural habitats. Berlin is saturated with stone buildings, mostly built back in the 19th century. The idea is to interweave the present fabric with the natural elements of a landscape. An urban system of green spaces, including the canal, is to be integrated into the existing urban fabric. The goal is to create a more sustainable and resilient urban environment.

Integrating nature into the urban fabric. The goal is to create a more sustainable and resilient urban environment. This involves integrating green spaces, including the canal, into the existing urban fabric. The aim is to create a more sustainable and resilient urban environment.

Integrating nature into the urban fabric. The goal is to create a more sustainable and resilient urban environment. This involves integrating green spaces, including the canal, into the existing urban fabric. The aim is to create a more sustainable and resilient urban environment.

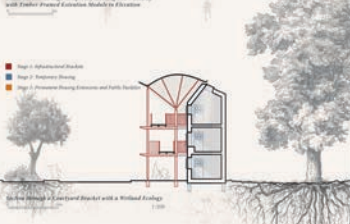
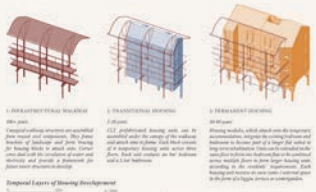

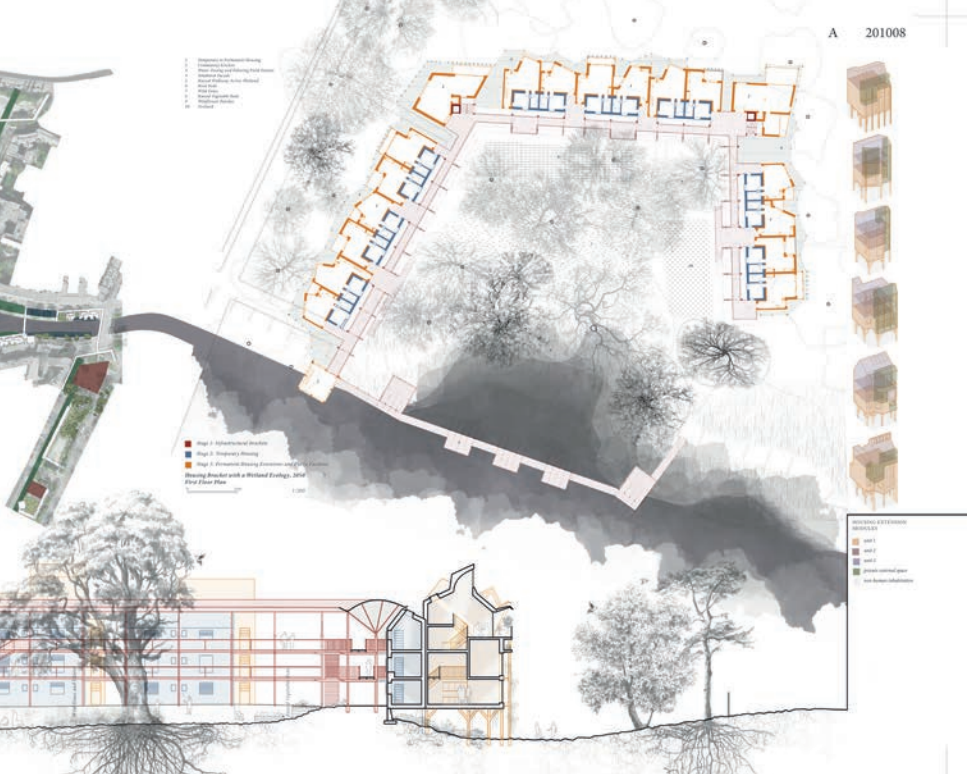



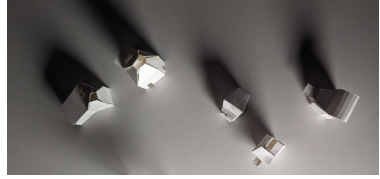

# 04a

## CRAFTING FUTURES

JODIE HORSBURGH

Building on Interweaving Habitats, the project further embraces the theme of care for both humans and non-humans.

Nestled in a green corridor within two streets in Bärwaldstraße, and near the historically industrial Landwehrkanal, the project seeks to harness the potential of this urban ecological space while fostering an educational scheme. The proposal consists of a Construction College integrated with surrounding greenery, aimed at re-training adults with vocational skills to bolster employability. The existing site is composed of two areas, with the proposed educational college infrastructure located in the north and public allotments and park space situated in the south.

By reclaiming and re-purposing underutilised greenspace, the project contributes to the enhancement of Berlin's biodiversity. This is further prevalent with the placement of a biotope patchwork that is incorporated throughout the site, which supports native flora and fauna. The establishment of a Vocational Training College for Construction equips individuals with marketable skills, particularly focussing on those living within the previously developed housing scheme. The college itself is subdivided into three main areas: General Construction Skills, Electrical Engineering and Plumbing, with design influenced by specific needs for each of these sectors.

The replicability of this proposition extends beyond its physical footprint and is viewed as a template across these greenspaces within the city of Berlin. While the specific programmatic elements may vary, the intent of the proposal is to enhance these spaces by unlocking their full potential.









- Field station maquettes (previous thumbnail)
- Crafting Futures - site plan (previous right)
- Long Section (top)
- Site, tectonic and developmental maquette models (middle)
- Short section through college (below)







# 04b

## LANDSCAPE OF CARE

### CRITICAL ZONE OBSERVATORY

INKA EISMAR

The Interweaving Habitats masterplan aims to rewild the former industrial waterway of Landwehrkanal by forming a patchwork of ecologies in the currently monotonous grassy landscape. The proposal introduces a critical zone observatory within the masterplan, which monitors the process of diversifying the canal ecology and studies how humans and non-humans can cohabit in the city. By softening the hard canal edge, the waterline is brought further inland to create a series of wet and dry ecology patches bracketed by buildings. The public promenade along the canal is transformed into a field station walkway with a sequence of monitoring stations, providing spaces to observe the newly established biotopes.

The observatory includes residential accommodation, which provides on-site housing to scientists and accommodates various forms of short and long-term research stays. The residential component simultaneously serves as a case study for the observatory mission, as close cohabitation of human and non-human residents is studied. The houses are raised on stilts, sitting above wetlands and providing multi-species contact points in their layered façade.

Through the lens of critical zone theory, water, nutrient and energy cycles are monitored in a multi-disciplinary way. Monitoring stations are structured according to the core spheres of the critical zone: atmosphere, hydrosphere, soil and biosphere. Interactions between elements are studied from micro to macro scale, and from small reactions to the long-term ecological regeneration of the canal.



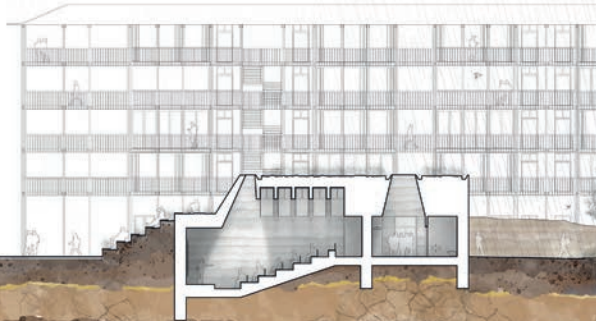
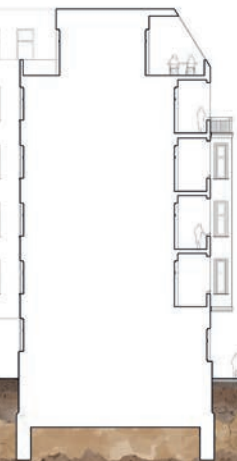
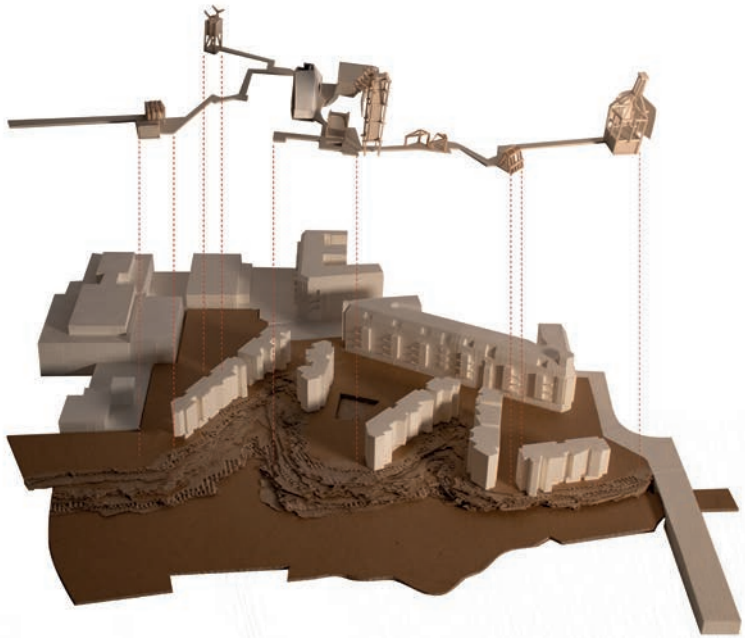
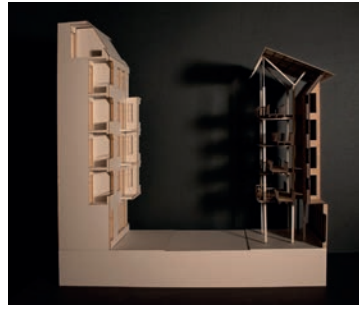



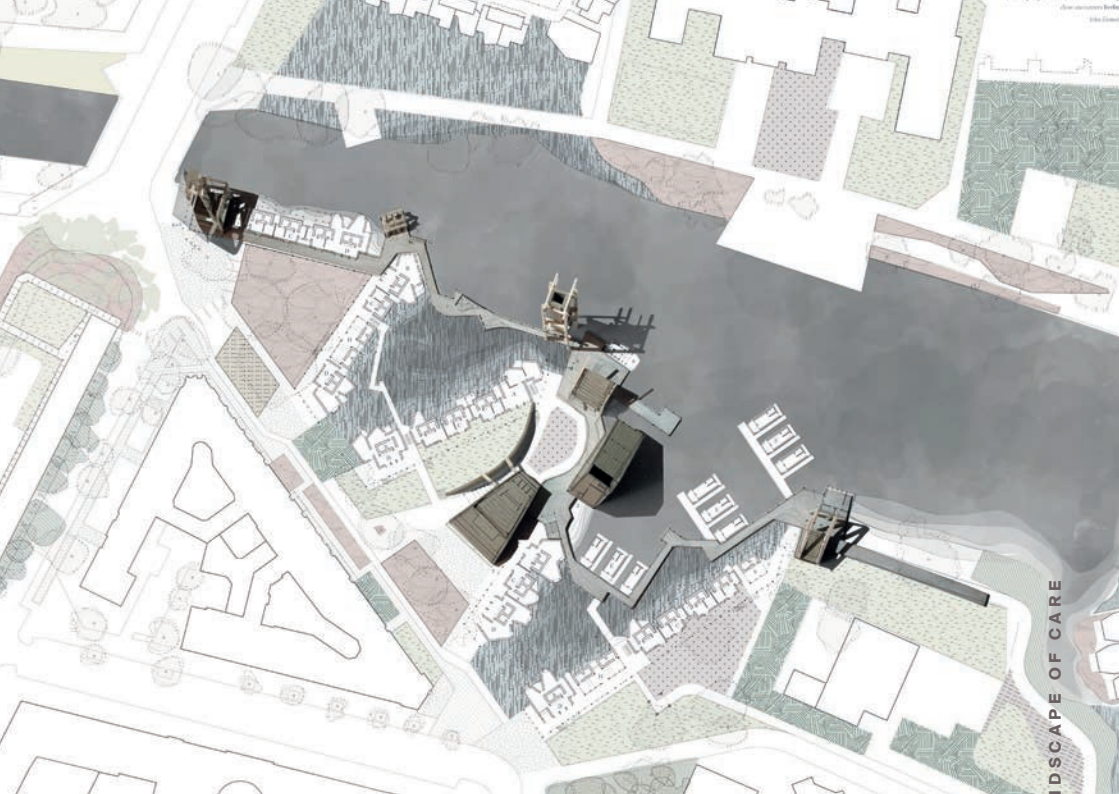

- Critical Zone diagrams: Critical Zone, Lithosphere, Soil, Hydrosphere, Atmosphere (previous thumbnail)
- Inhabited facade model study (previous right)
- Critical Zone Observatory pathway and waterline (adjacent top left)
- Neighbourhood residential context model (adjacent top right)
- Pathway overview and waterline modification (adjacent middle)
- Observatory path & adjoining landscape patches (above)
- Lecture theatre and Water Field station section (below)

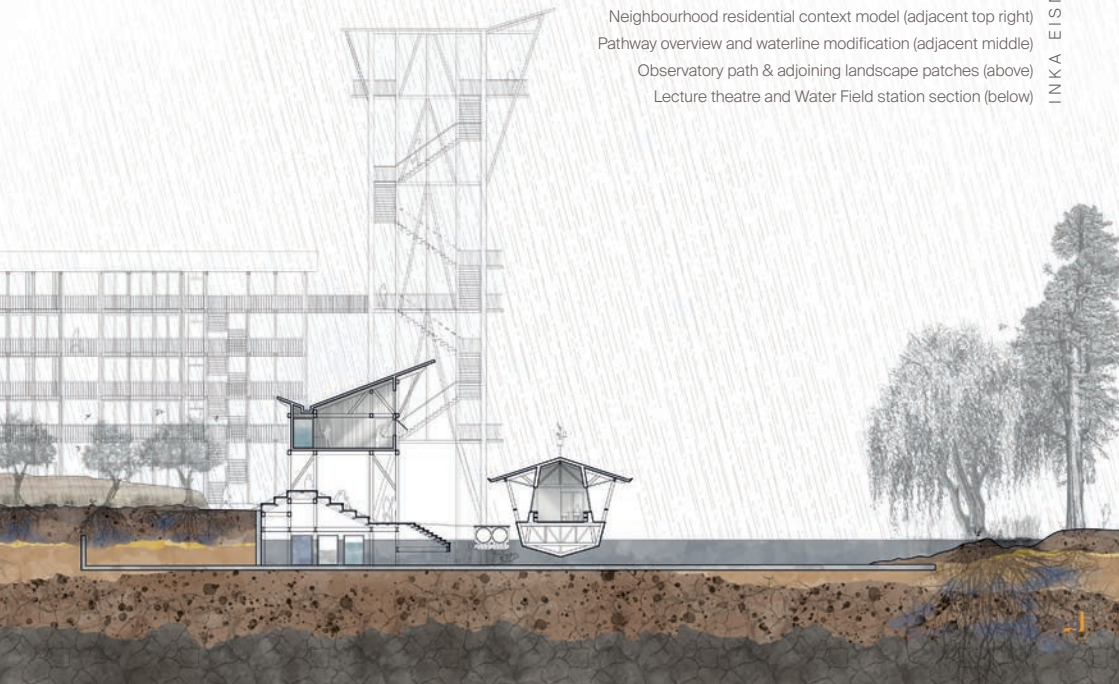

# 04c

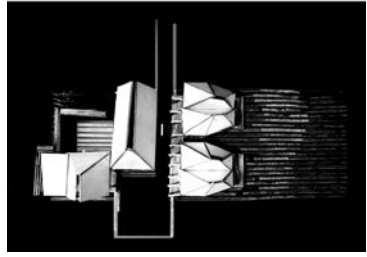

## REWILDING ISLANDS

NURTURING COMFORT IN PALLIATIVE CARE

EILIDH MCKENNA

Expanding upon Interweaving Habitats, the project seeks to redefine the relationship between more-than-human and human care. Situated along the Landwehrkanal, the project reintroduces island formations into the canal. Adjacent to the Nantes Krankenhaus Berlin Hospital, it revitalises underutilized greenspace while offering crucial support to the hospital community. The proposal offers additional support for the hospital, whether this be for patients, visitors, or staff. Acting as a transitional domestic space between the city, the mega-hospital, and individuals' homes. The concept aims to reconnect people with nature, giving an escape from the clinical setting instead creating a nurturing and dignified environment. The dichotomy between open islands and walled courtyards protects ill patients from harsh elements while promoting healing interactions with nature; a salutogenic holistic approach to care. The scheme accommodates future flash-flooding by softening the canal edge to create a permeable ground surface. While the retaining walls act as a barrier protecting the islands from water flow erosion; overtime sediment will build up around the walls, creating marshlands that promote carbon sequestration. The islands use the developed biotype patchwork system to support native flora and fauna, enhancing biodiversity and creating habitats. The program includes the Public Outreach Wildlife Tower, The Hospice, The Maggie's Centre, The Short-Term Visitor Housing, and the non-denominational Chapel. The scheme can be used as a framework along the canal, re-purposing the program to best care for the surrounding context.





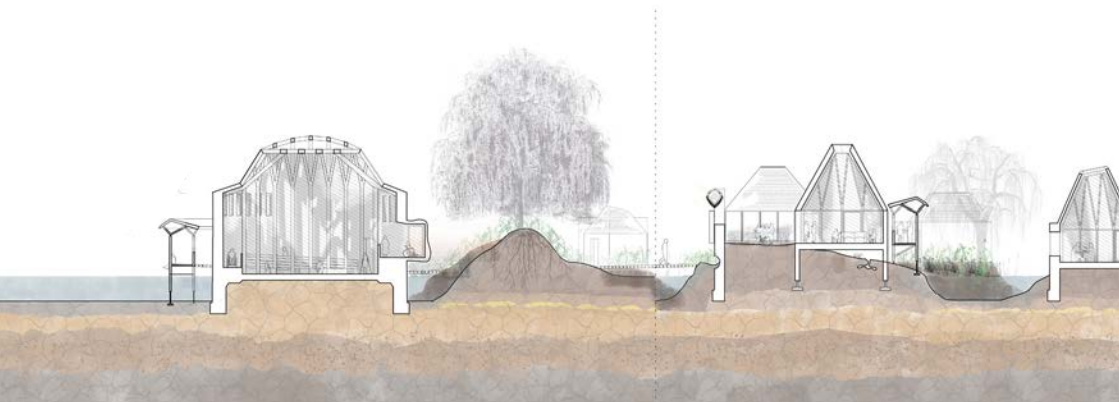



Hospice in sedimentary landscape model - plan (previous thumbnail)

Collage visualisations: pathway, canal and hospital context (previous right)

Hospice in sedimentary landscape model - section (adjacent top)

Soft canal edge - rewilded landscape (adjacent middle)

Roof plan with mediated landscapes (above)

Non-denominational Chapel, Maggie's Centre and residential facilities section (below)

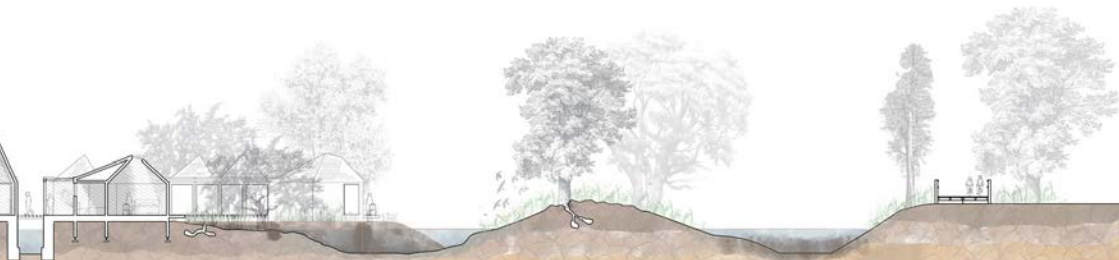

## Der Große Park: Enhancing Flood Resistance through Urban Re-Wilding



Der Große Park bridges the gap between urban development & public parks to encourage outdoor living. It establishes a green corridor across the city that connects the 3 major parks: Tiergarten, Park Am Stöberweg & Maria Park Burggarten. Our approach redefines Berlin's urban landscape by linking a variety of experiences into one cohesive park.

Zooming into Nordbahnhof, a sustainable & interconnected outdoor space, we support social interaction with activities accompanied by a variety of uses: walking & jogging, playing, accompanying human & non-human communities in this natural environment promoting long-term health & well-being. Resilient & flood-resistant landscapes are required to create physical wellness.

The strategic focus on Nordbahnhof, with its flood attenuation design, promotes a commitment to sustainable urban development & ecological resilience. Our natural materials support the site's 'sprung' walking up surface water flooding while its gridding facilitates for birds.

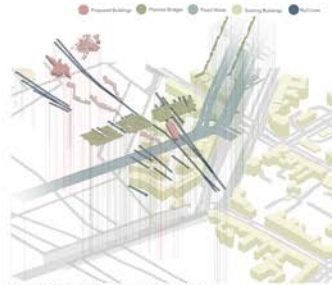







# 05a

## GATEWAY TO THE GREEN CORRIDOR

GEORGIA TUCKER

Located in the Park am Gleisdreieck, along the busy Yorckstraße junction in Berlin, the Gateway community hub comprises a hybrid library/community centre spanning the park's rail bridges. The gateway hub situates itself within the site based on research and development from an initial competition scheme, a green corridor through the centre of Berlin; re-linking park spaces within the city to form a singular, Große Park.

The hub aims to connect the lower junction and residential area with the upper-level park, through a singular community centre that acts as a circulatory gateway up, down, across and over the site. Clad in timber, with a fully walkable green roof, the hub is sustainably built using natural materials. Rainwater is collected from the junction wetland proposed in the competition scheme and is reused throughout the building. The hub is positioned within the old refugee garden, which has been relocated to an empty park section, bringing new life to a previously desolate space. Within the old refugee garden, a small play park has been added to encourage links between the children's library and a local nursery opposite the building.

There is also a series of 'mini city spaces' below the park, built into the junction's wall. These small rooms create an underground city bridging the two neighbouring residential blocks on either side of the park, encouraging further use of the underground spaces - livening up the wide junction space below.

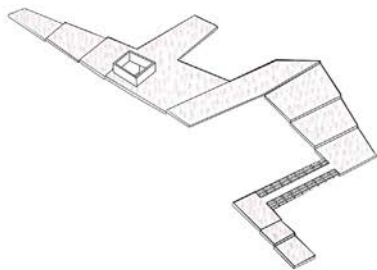

Wildflowers planted across roof to encourage biodiversity for insects

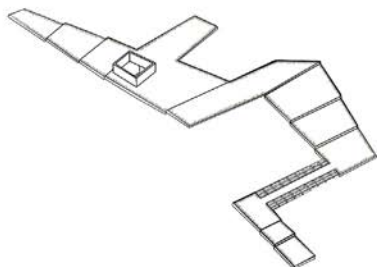

Bushes used to create a natural safety barrier on roof to maximise views from the roof and provide some habitats for non-human inhabitants of the Park

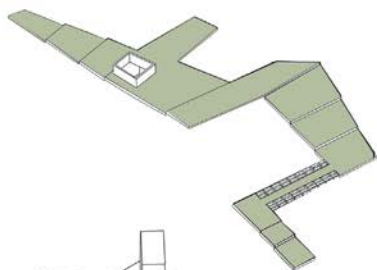

Fully-walkable Sedum roof, bringing human and non-human visitors on top and over the entirety of the scheme

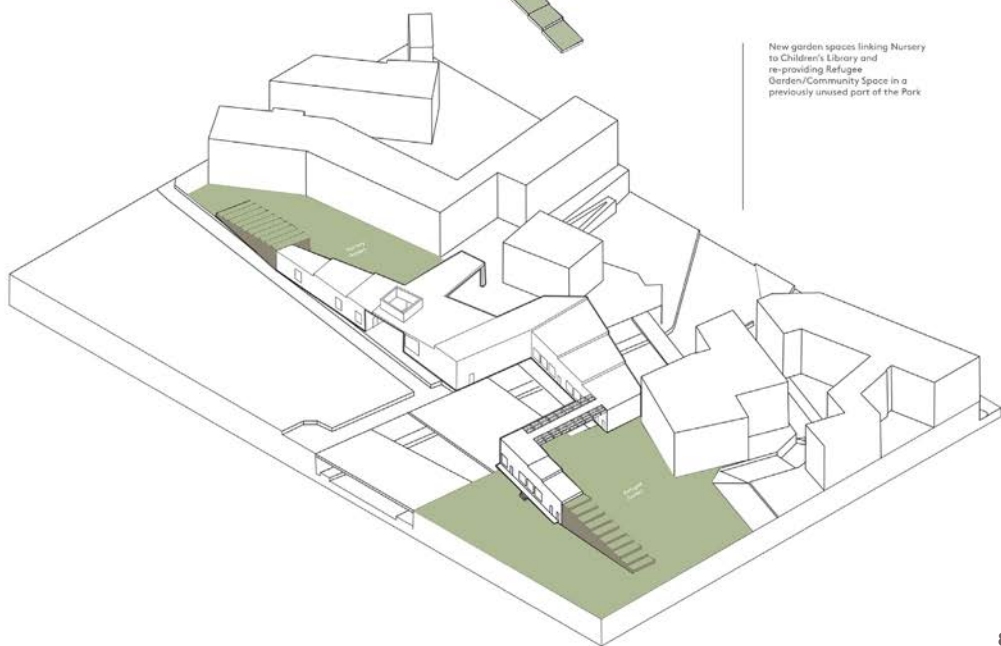

New garden space linking Nursery to Children's Library and re-providing Refugee Garden/Community Space in a previously unused part of the Park



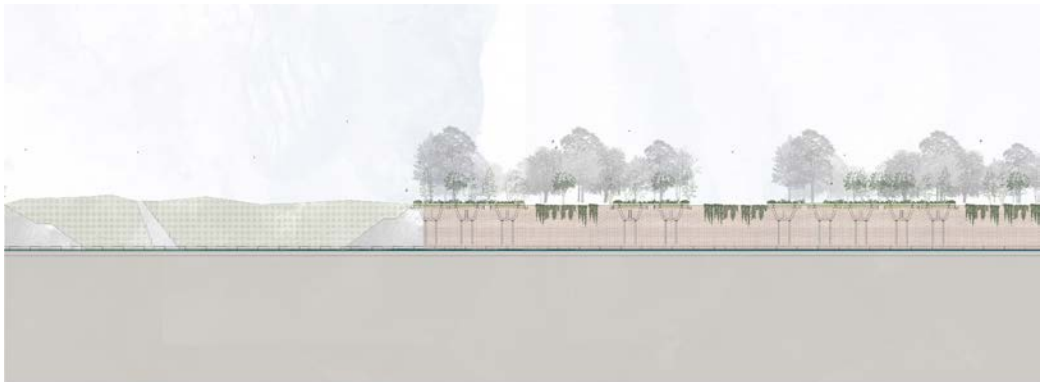

- Library section model (previous thumbnail)
- Landscape strategy layers (previous right)
- Park approach visualisation (adjacent top)
- Carved massing model (adjacent middle)
- Plans: ground, basement and roof (right)
- Liveable research pod (middle)
- Long section urban to park through rail bridges (bottom)

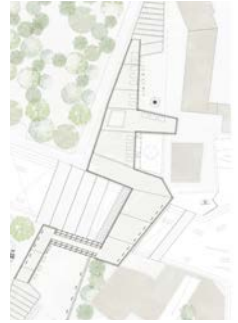
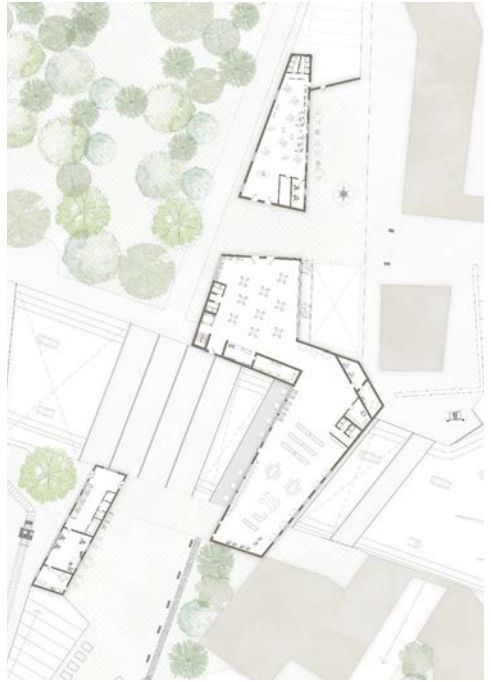
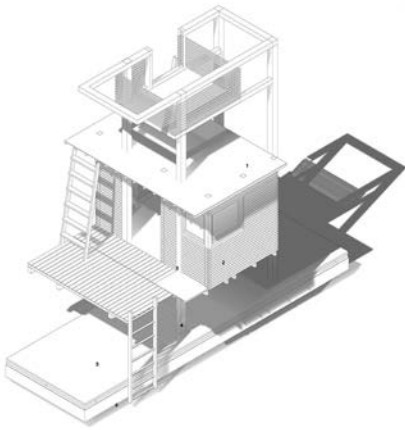

GEORGIA TUCKER | GATEWAY TO THE GREEN CORRIDOR





# 05b

## NESTING DER GROÙE PARK

UNVEILING NATURE AND BIRDS

SIMY PUTHENVEEDU ABRAHAM

Gleisdreieck, Berlin is a historic railway junction turned vibrant urban space that seamlessly integrates history, neighbourhoods, and parks, where creating a neighbourhood for birds makes it more prominent. 'Nesting' - a bird research space and exhibition centre in an urban context mainly focuses on creating and promoting a safe urban neighbourhood for birds, where humans can observe, listen and interact with non-humans.

Elevating the biodiversity without tampering with the ecological balance is essential while designing bird-friendly infrastructure. Nesting encompasses two separate buildings, one with an exhibition centre open for the public showcasing bird-related materials and sensory experiences while the other one with private research space dedicated to ornithology. These buildings are mainly designed with rammed earth walls and timber, also featuring a long-elevated pathway for humans to observe birds. This leads through rammed earth walls on both sides accommodating nesting space for various species of birds at different heights. The tree bird habitat is located on the northern side while the water bird habitat is on the southern side. This bird habitat is designed without disturbing the existing trees and planting new ones accordingly. It also includes a new body of water which merges with the existing landscape. The thriving vegetation of trees, bushes and plants along with the water makes the space even more bird-friendly and a soothing space for humans where they can experience and enjoy the music of non-human life.



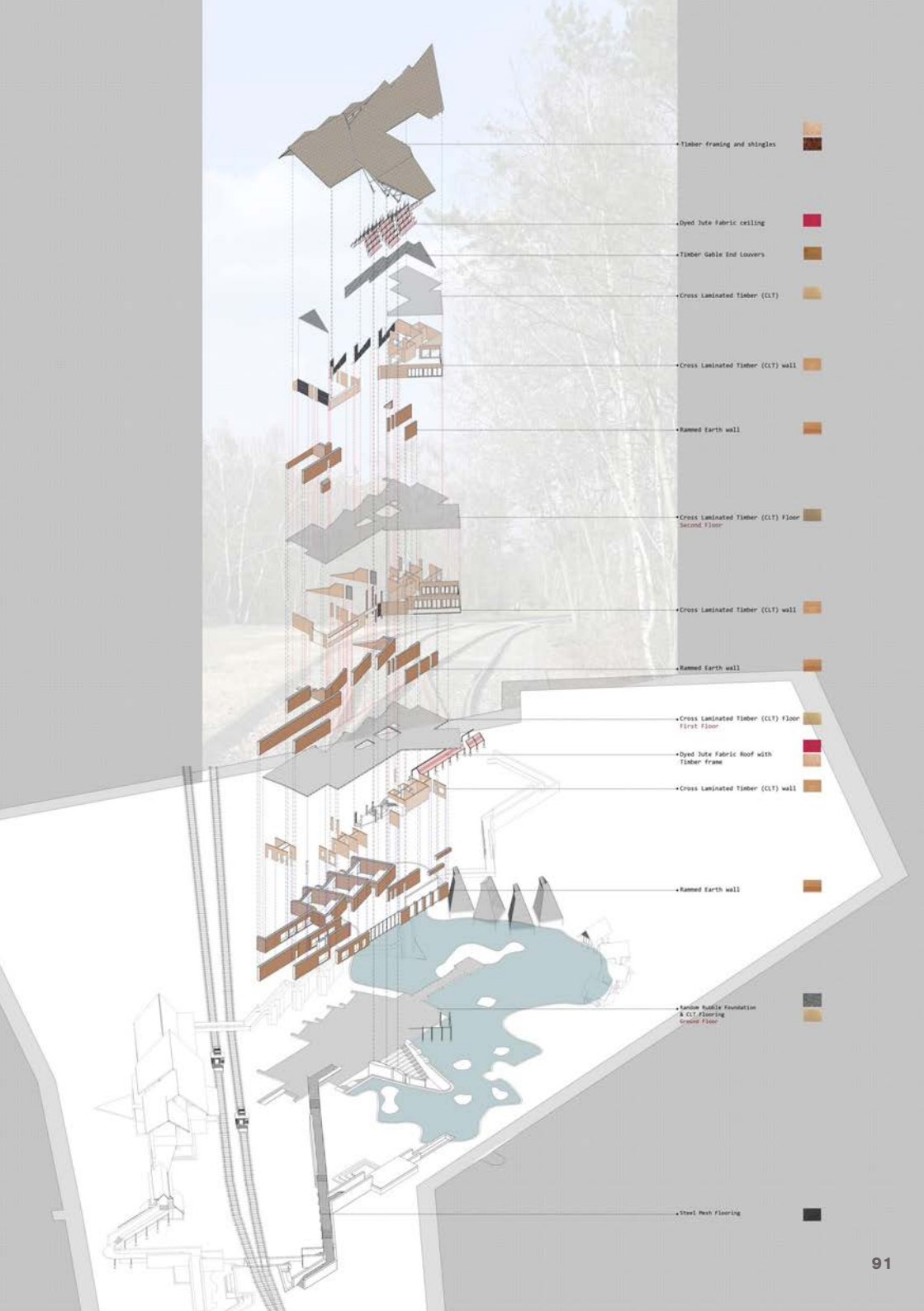

Timber framing and shingles

Dyed Jute Fabric ceiling

Timber Gable End Louvers

Cross Laminated Timber (CLT)

Cross Laminated Timber (CLT) wall

Rammed Earth wall

Cross Laminated Timber (CLT) Floor  
Second Floor

Cross Laminated Timber (CLT) wall

Rammed Earth wall

Cross Laminated Timber (CLT) Floor  
First Floor

Dyed Jute Fabric Roof with  
Timber frame

Cross Laminated Timber (CLT) wall

Rammed Earth wall

Rammed Earth Foundation  
& CLT Flooring  
Grade Floor

Steel Mesh Flooring



Bird species (previous thumbnail)

Constructional exploded axonometric (previous right)

Elevation (top)



Water body visualisation (top middle)

Open amphitheatre (bottom middle)

Cross section (bottom)



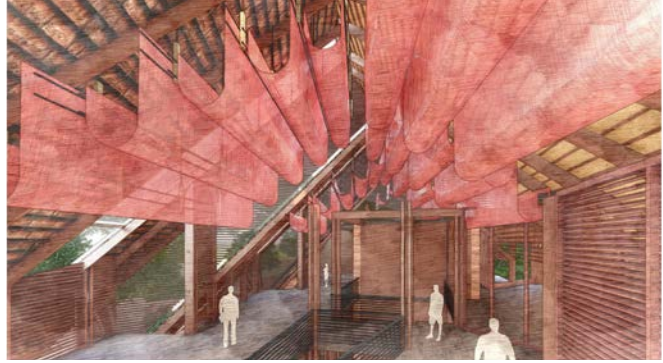

SIMY PUTHENVEEDU ABRAHAM | NESTING DER GROSSE PARK

Eaves display space (top middle right)  
 Bird watching promontory (bottom middle right)  
 Large Field station model (middle left)





# Living Bridges

## Repairing Green Infrastructures

266876

© 2014 The City of Los Angeles, Department of Transportation. All rights reserved. This document is the property of the City of Los Angeles and is loaned to you for your use only. It is not to be distributed, copied, or reproduced in any form without the prior written permission of the City of Los Angeles. The City of Los Angeles is not responsible for any errors or omissions in this document. The City of Los Angeles is not responsible for any damages, including consequential damages, arising from the use of this document. The City of Los Angeles is not responsible for any claims, including attorney's fees, arising from the use of this document. The City of Los Angeles is not responsible for any claims, including attorney's fees, arising from the use of this document.

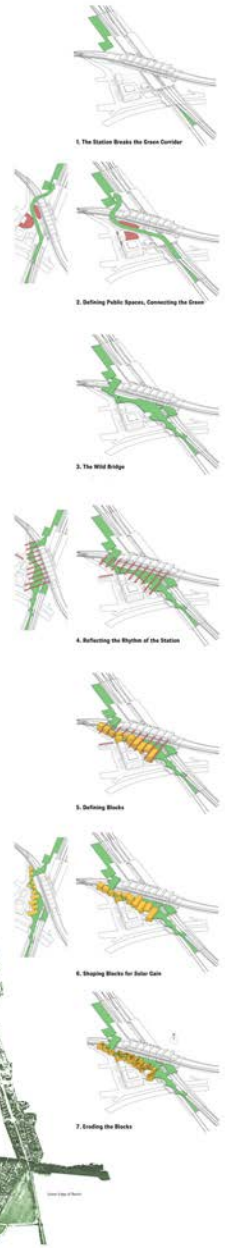

Site Plan | 1:2000

Viewing the Wild through the City

The Green Corridor | 1:50,000

266876

Floor Plans | 1:250

Roof Plan

Ground Floor | Commercial Space

1st Floor | Residential

2nd Floor | Residential

3rd Floor | Residential

4th Floor | Residential

Roof Plan

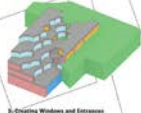
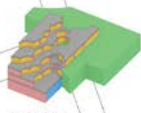
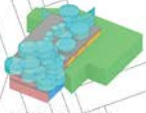
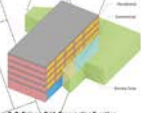
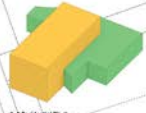
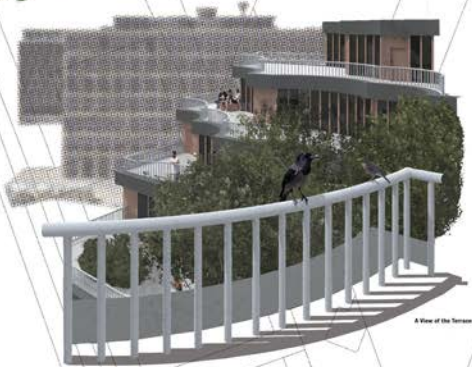



# 06

## LIVING BRIDGES

### REPAIRING GREEN INFRASTRUCTURES

WULFRIC CLACKSON

Living Bridges explores how humans and nature may coexist in urban environments. It challenges the typical structures of the city and explores alternative forms, giving more space for people to dwell, and more connection to the city's non-human inhabitants.

The project looks at how the structure of the city fragments wildlife, and how we can re-purpose existing infrastructure to reconnect it. Focusing on the rail lines which served the former Anhalter Bahnhof in Berlin, Living Bridges studies how the decay of this infrastructure creates ideal spaces for the creation of a wildlife corridor.

This route has gaps, however. Here architectural intervention is required. The largest such gap is at the Südkreuz railway station. To bridge it, the project takes heavy inspiration from nature, and the work of Hans Scharoun and Paolo Portoghesi. It creates an eco-duct, entwined in complex series of buildings, which are reflective of the fractal complexity of the natural world, a contrast to the rigid forms presently on the site.

Housing is in dire need in Berlin, so the project looks at how housing may be integrated into the corridor, allowing both humans and non-humans to coexist. Referencing *Soft City*, by David Sim, the project challenges the present structures of the city and aims to create a richer, more diverse place to live.





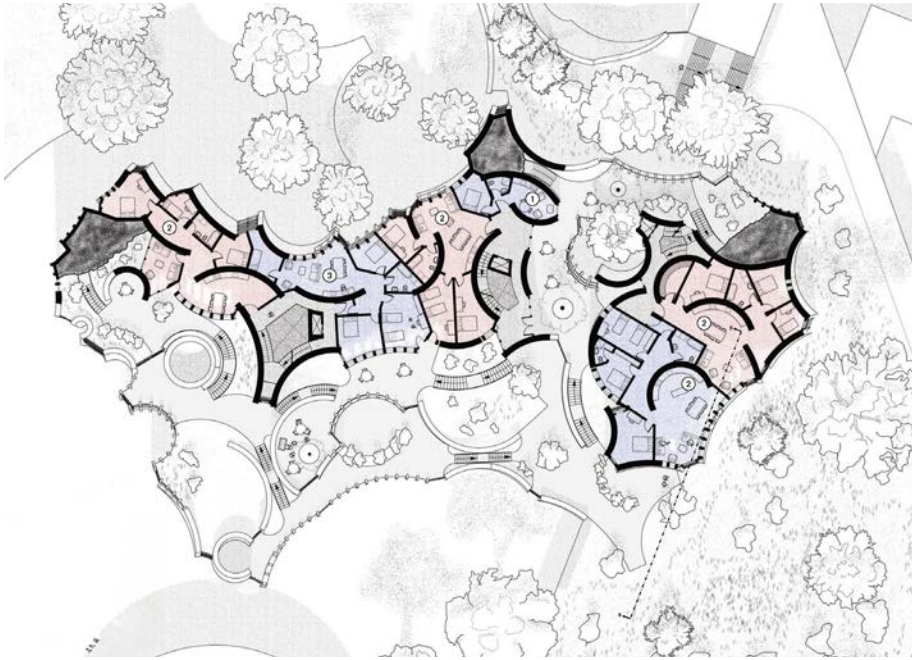

- 
- Modular ellipses maquette (previous thumbnail)
  - Scheme overview around Südkreuz rail station (previous right)
  - Third floor residential and terrace plan (above)
  - Elliptical courtyard visualisation (adjacent top right)
  - Iterative layered site model (adjacent left top)
  - Clay massing maquette (adjacent left middle)
  - North-south section (bottom)

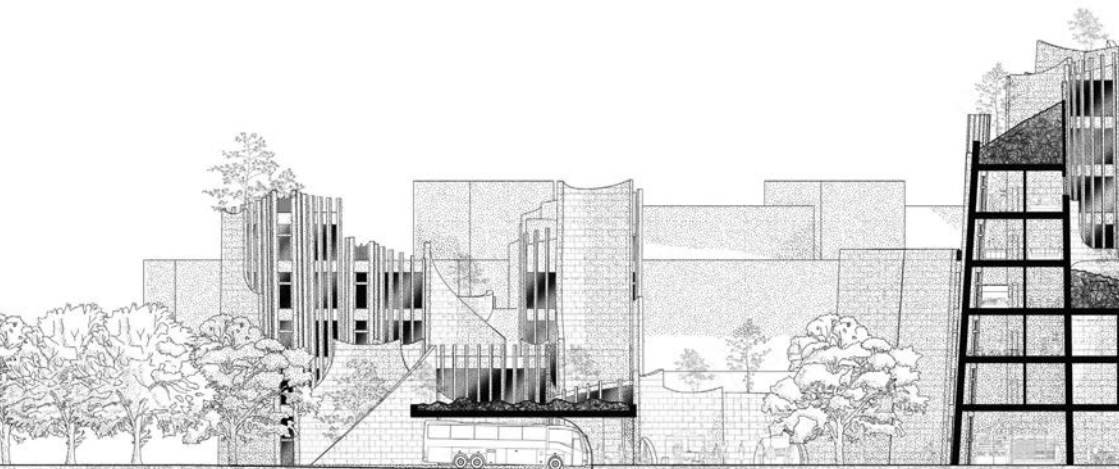



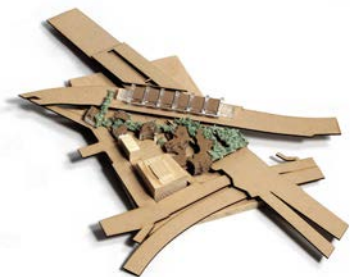

WULFRIC CLACKSON | LIVING BRIDGES







**ARTICULATION OF THE SITE** This site represents the existing infrastructure around the station and the rail. It includes a large area of high pollution and low pollution areas.

**Site and Plan** The location of a general urban plan and the location of the site.

**Station** The location of the station.

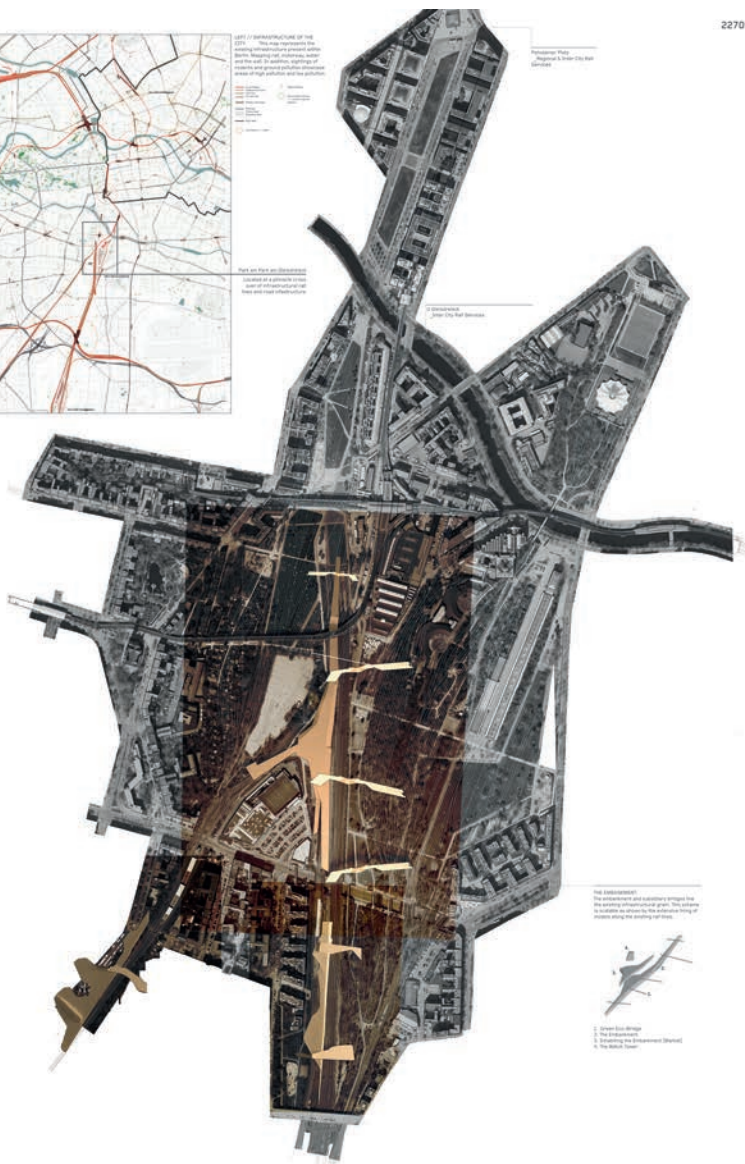

**Station** The location of the station.

**The Station** The station and its location in the urban fabric.



1. Urban Fabric
2. The Station
3. The Station and its location in the urban fabric



**1. The Station** The station and its location in the urban fabric.



**2. The Station** The station and its location in the urban fabric.

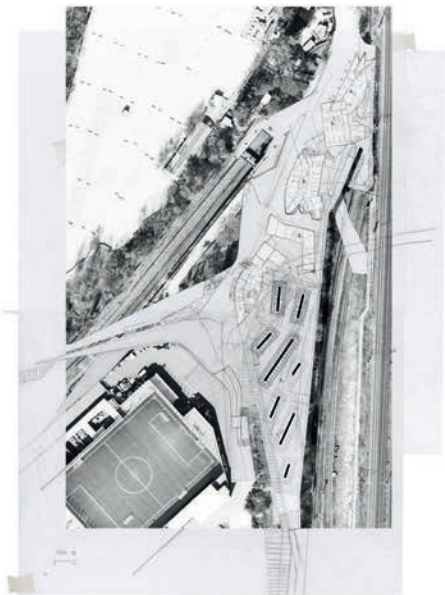

- 1. Inhabited Embankment
- 2. Main government independent stage
- 3. Berlin Sports Center
- 4. Government Office Building
- 5. Sports Ground

TOP OF 1:1000 Section - Showing the stadium's location, the main government independent stage, the Berlin Sports Center, the Government Office Building, and the Sports Ground. The stadium is located on the left side of the embankment and is connected to the main government independent stage by a pedestrian bridge. The stadium is located on the left side of the embankment and is connected to the main government independent stage by a pedestrian bridge.



- 1. Gymnasium
- 2. Member Parking
- 3. Club
- 4. Inhabited Plaza

TOP OF 1:1000 Section / Member Level - An access level, this floor provides the lighting for larger vehicles, such as ferries, to enter the site and access the stadium. The stadium is located on the left side of the embankment and is connected to the main government independent stage by a pedestrian bridge. The stadium is located on the left side of the embankment and is connected to the main government independent stage by a pedestrian bridge.

## The Inhabited Embankment A Berlin Infrastructure of Co-Existence

The Inhabited Embankment emerges as an ecological infrastructure within the city's boundaries, an ecological infrastructure that facilitates co-existence. The project aims to reduce the amount of urban development by transforming urban and ecological conditions through the integration of ecological infrastructure, urban planning, and a variety of other urban participatory and architectural strategies.

Approximately 80 years ago, the historical wall of Berlin was built, creating a barrier between the city and the surrounding landscape. The wall was built to protect the city from the surrounding landscape, but it also created a barrier between the city and the surrounding landscape. The wall was built to protect the city from the surrounding landscape, but it also created a barrier between the city and the surrounding landscape.

Over time, the wall has been dismantled and the city has grown. The wall has been dismantled and the city has grown. The wall has been dismantled and the city has grown. The wall has been dismantled and the city has grown. The wall has been dismantled and the city has grown.

The project is a habitat of co-existence, a habitat of co-existence. The project is a habitat of co-existence, a habitat of co-existence. The project is a habitat of co-existence, a habitat of co-existence. The project is a habitat of co-existence, a habitat of co-existence.



1. Inhabited Embankment - This project shows the scale and scope of the embankment and the surrounding infrastructure. The project is a habitat of co-existence, a habitat of co-existence. The project is a habitat of co-existence, a habitat of co-existence.

2. Inhabited Embankment - This project shows the scale and scope of the embankment and the surrounding infrastructure. The project is a habitat of co-existence, a habitat of co-existence. The project is a habitat of co-existence, a habitat of co-existence.

# 07

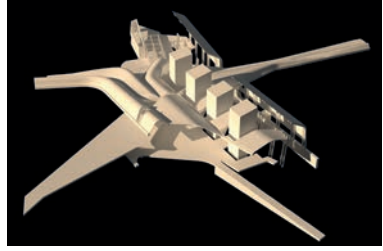

## THE INHABITED EMBANKMENT

SONIC INFRASTRUCTURES OF BERLIN

ADAM MITCHELL

Situated within one of the remaining vestiges of Berlin's industrial rail network, the Inhabited Embankment nestles programmes into pockets of undesirable space. Park am Gleisdreieck, a former shunting yard that remained abandoned since the turn of the Cold War, resisted residential development in favour of urban rewilding, preserving a distended outline of the long-standing infrastructural form. The chosen site, positioned within a convergent position littered with an overlapping series of intertwined rail services, provides the opportunity for the creation of a new infrastructure that will morph the existing landscape 100 years into the future, reforming the concept of urban living by intertwining the human and ecological domain through the language of passage, providing safe crossings for both human and nature.

Facing the railway, a thick rammed earth wall protects neighbouring communities against the thunderous sound produced by the passing trains. Sprouting from the thick mass is a series of glulam columns that form an extended barrier, supporting woven willow acting as acoustic protection. Idealised to become a new piece of urban infrastructure, the embankment expands and contracts in height and depth at varying stages along existing rail lines. At specific points, bearing over this wall exists a sedum roof, constructing a 'green bridge' that permits the crossing of human and non-human inhabitants over the existing rail infrastructure.



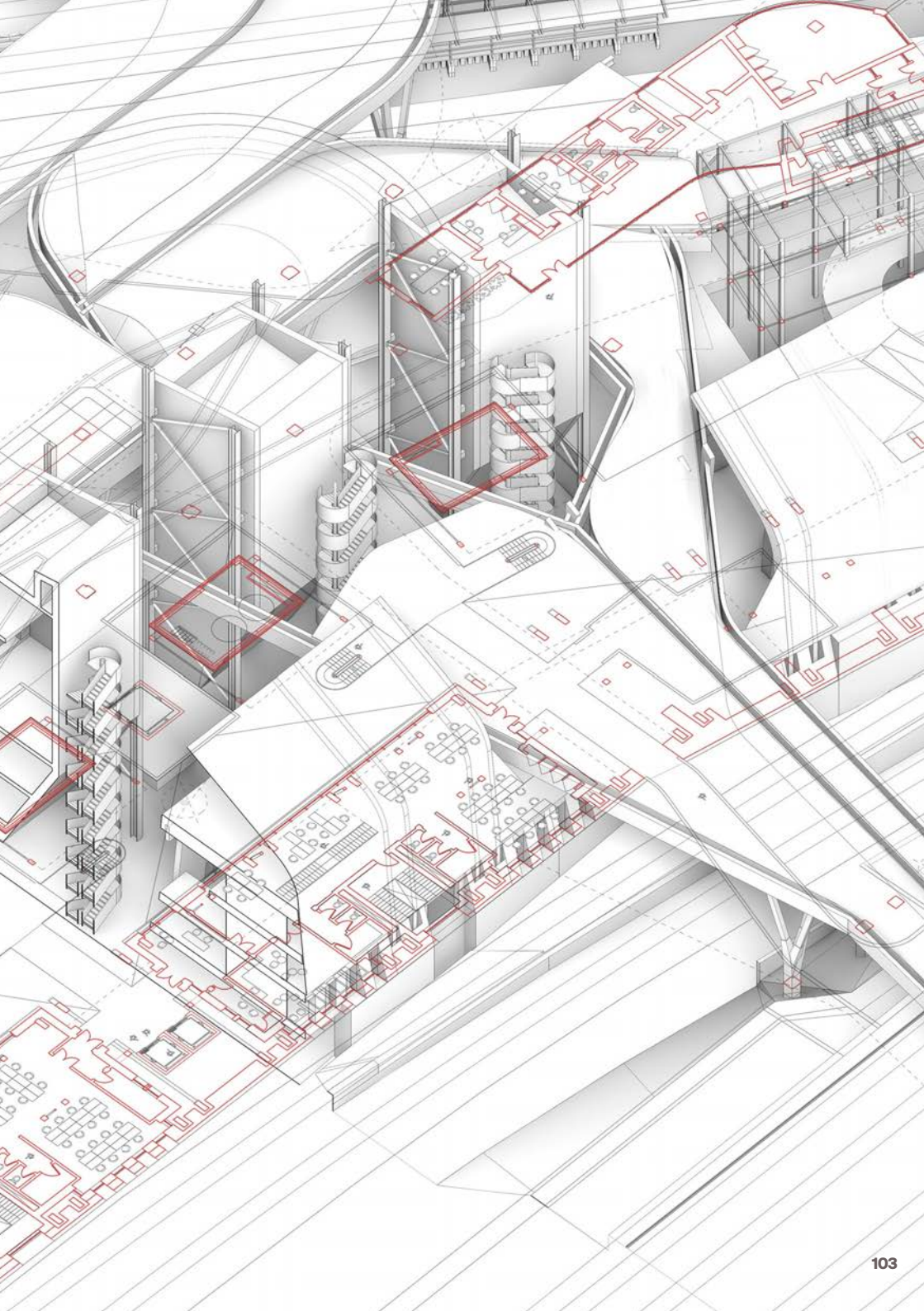

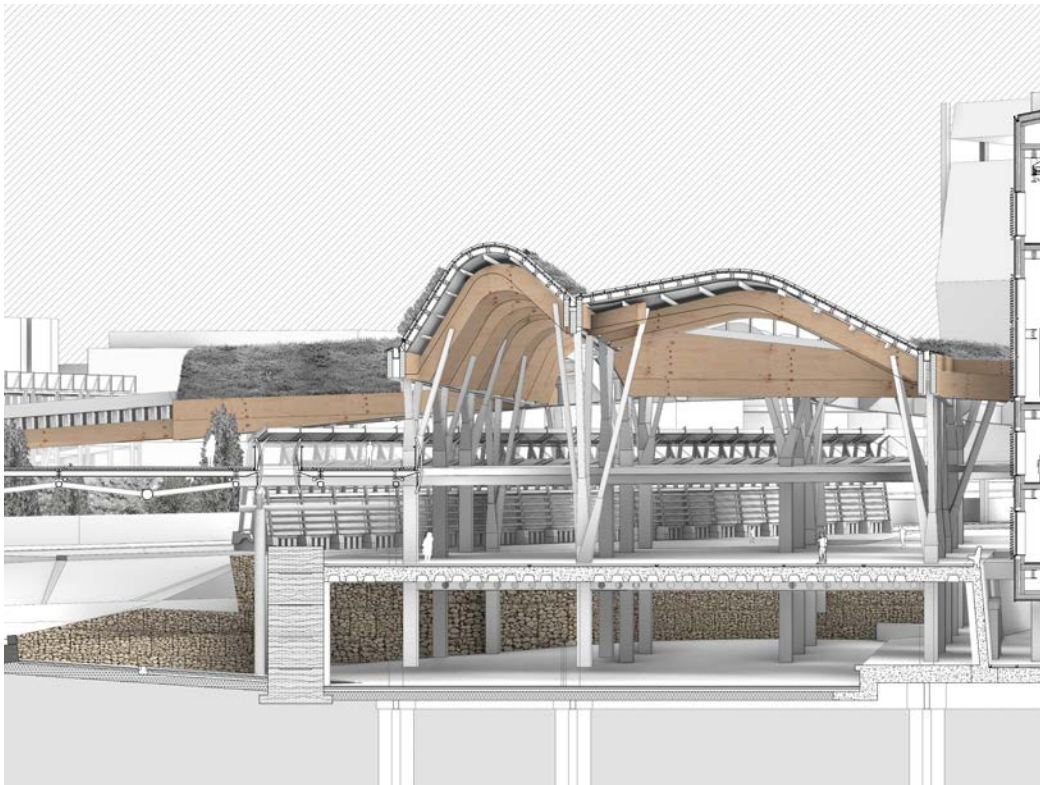
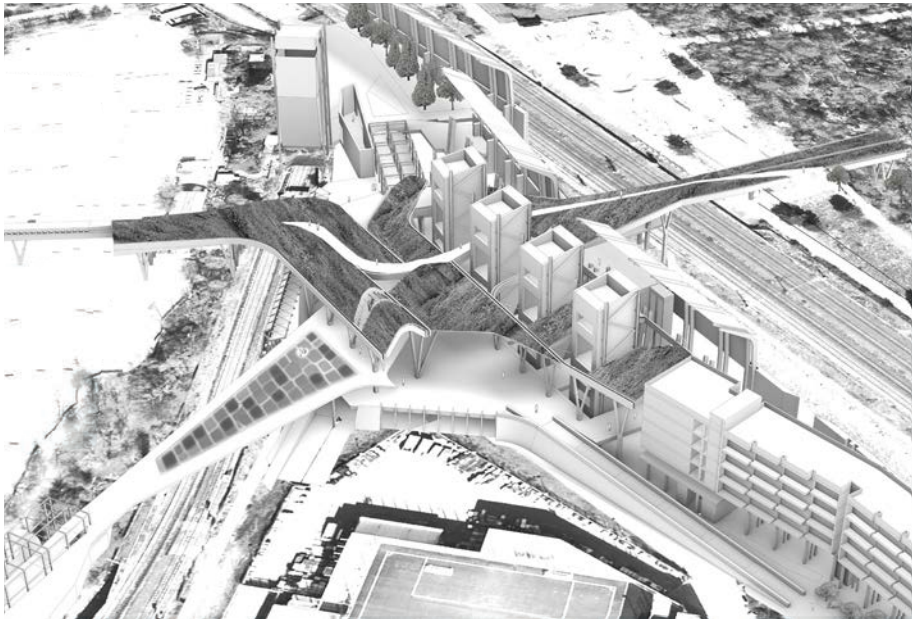





Scheme massing model (previous thumbnail)

Ground floor plan overlaid to sectional cut (previous right)

Green bridge infrastructures aerial perspective (adjacent top)

Tectonic model (above)

Technical scheme section (below)

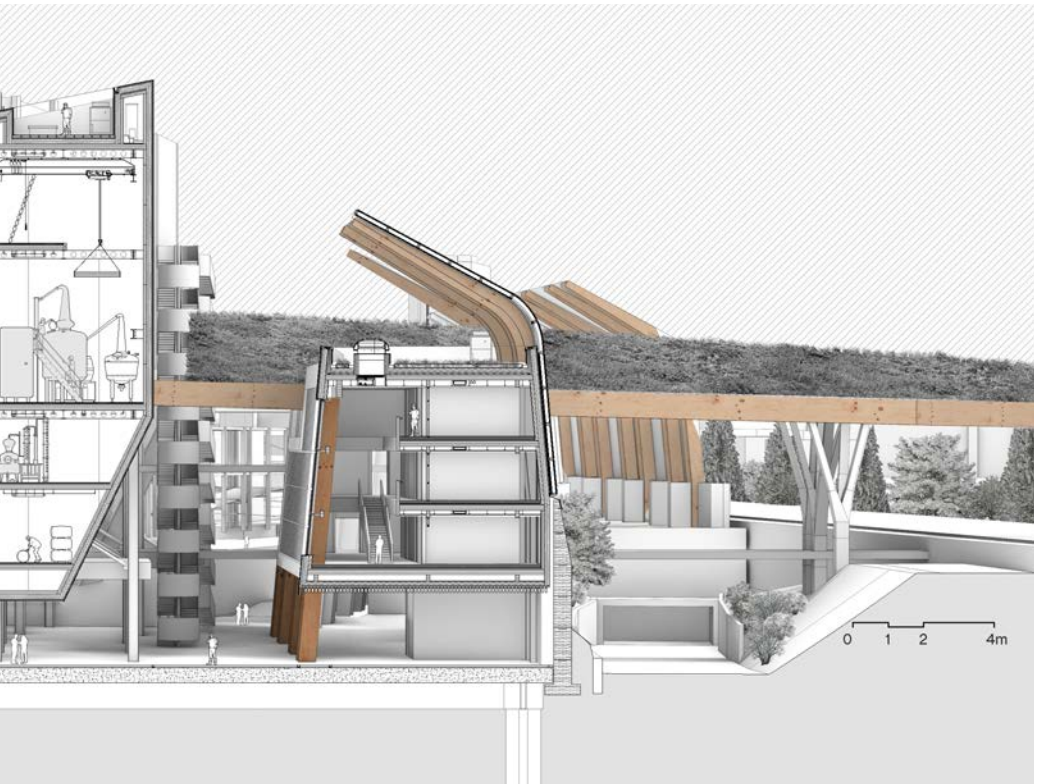





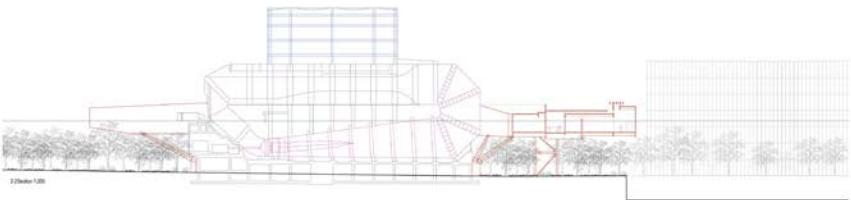
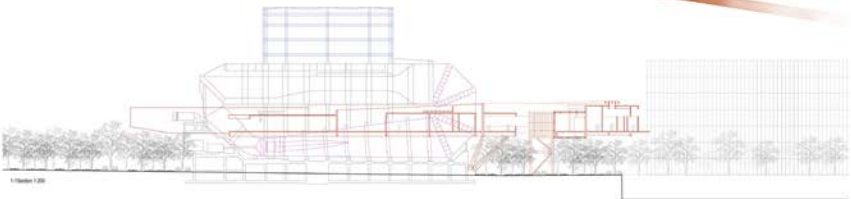
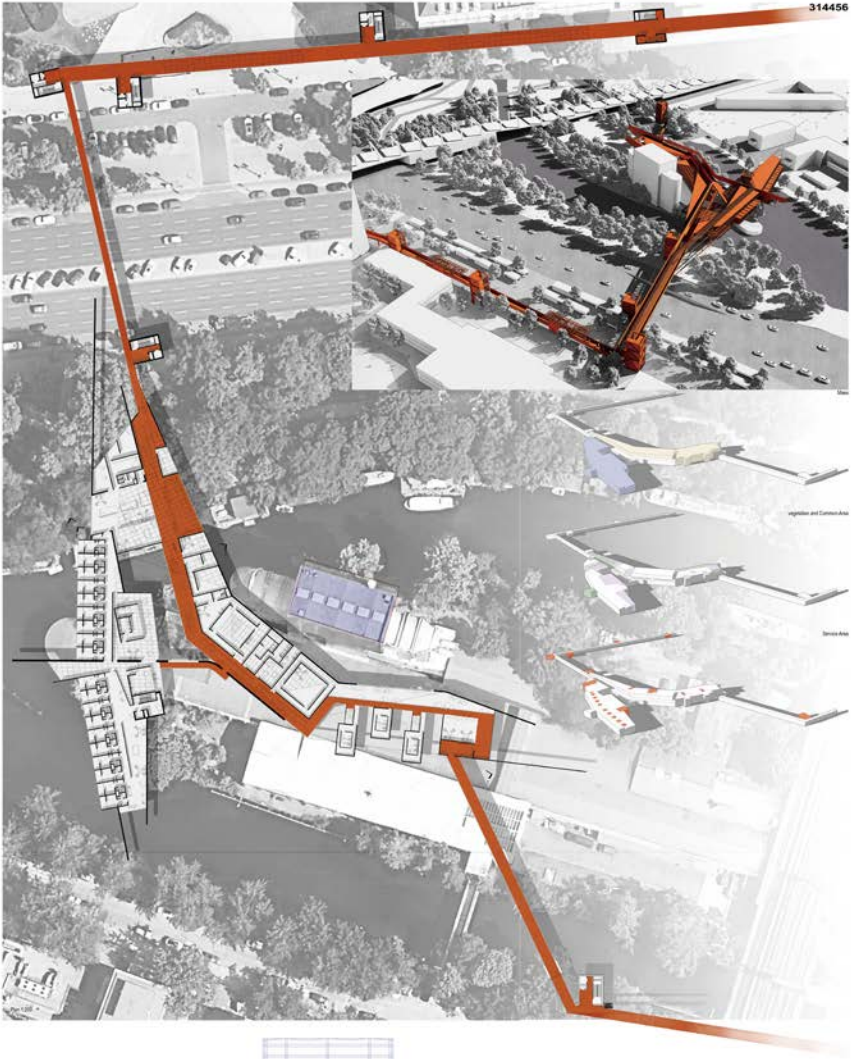

# 08a



## SCIENCE OF NATURE: URBAN-AIR

ZEYU WANG

The focus of the project narrative centres on journey and connectivity. The journey is designed to captivate individuals, incorporating two distinct paths: one attracting visitors from the park, and another designed for students. This establishes a route connecting these areas and groups. This pathway establishes a journey and experience from nature, through urban space, and returns to nature. Secondly the project fosters connections: between people, and between people and nature. To enhance the interpersonal interactions, the design incorporates a Faraday cage to block electromagnetic signals, thus promoting direct communication among individuals. The connection with nature is emphasized through auditory experiences, distinguishing between natural sounds, such as birdsong and the rustling of leaves, and anthropogenic noises such as traffic and human conversation. By preserving the original trees and narrowing the roads, coupled with the installation of traffic calming measures, vehicular noise is reduced, allowing for a more immersive natural auditory experience.

The existing market on the site is maintained while incorporating structural elements reminiscent of tree trunks to echo the natural environment. Considering the restaurant's elevated position and the heat transference through the floor, insulation measures were critically evaluated. The design includes a double-skin façade to decrease reliance on air conditioning systems. Adjustable louvres are implemented to reduce solar gain during summer and gain from the passive heat source in winter.



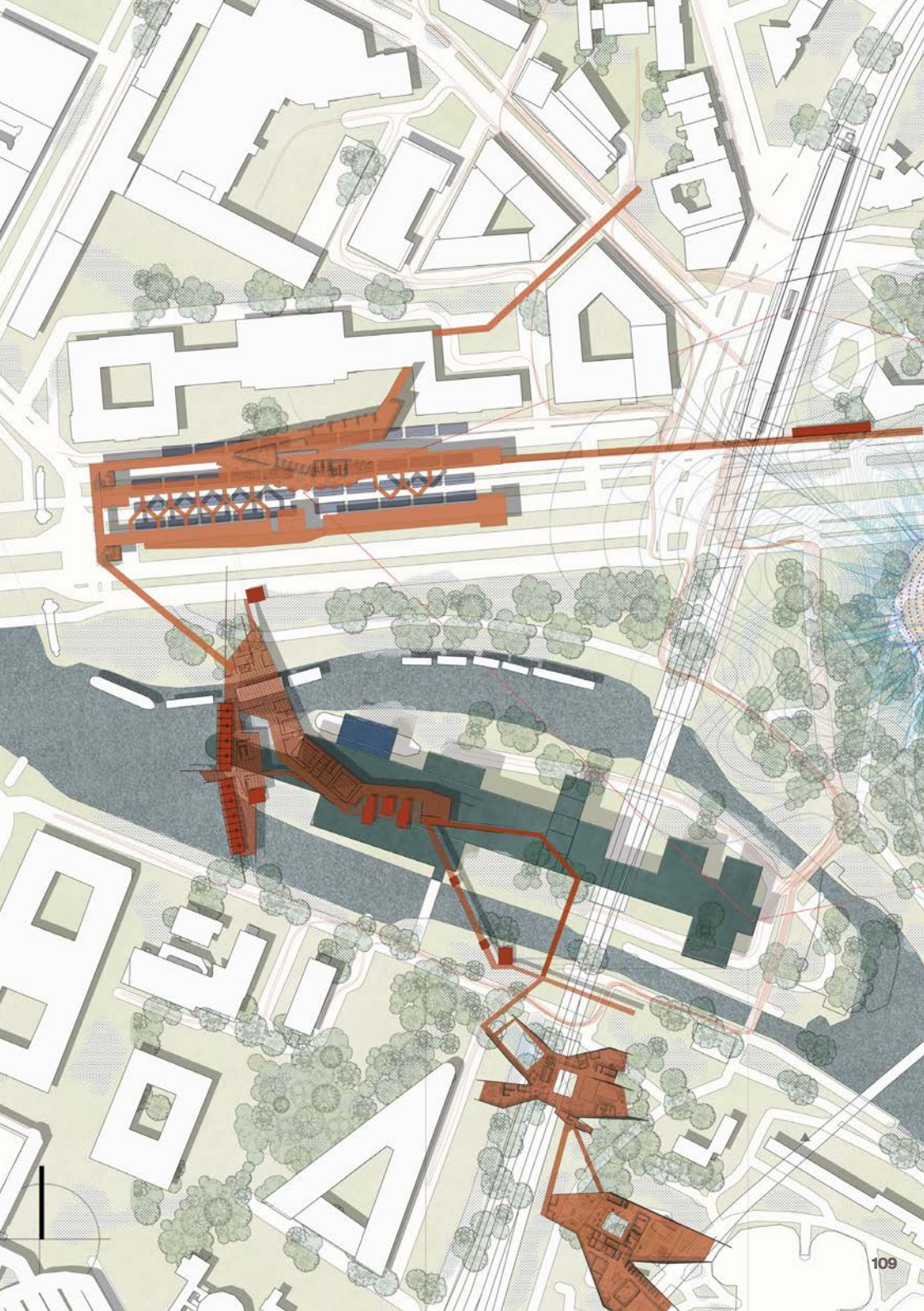

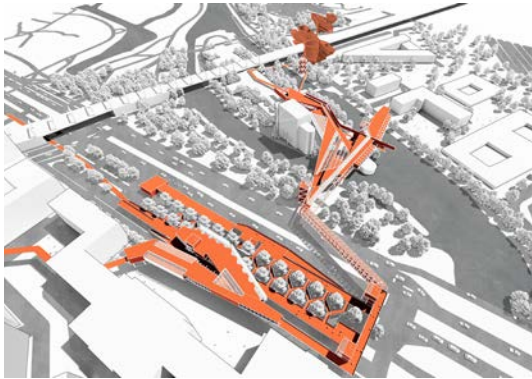

- Tiergarten intervention (previous thumbnail)
- Scheme masterplan (previous right)
- Scheme axonometric (top left)
- Structural axonometric, worms eye view (middle)
- Sectional perspective (bottom)
- Facade layers (adjacent middle)
- Walkway structure model (adjacent right top)
- Scheme massing maquette (adjacent right middle)

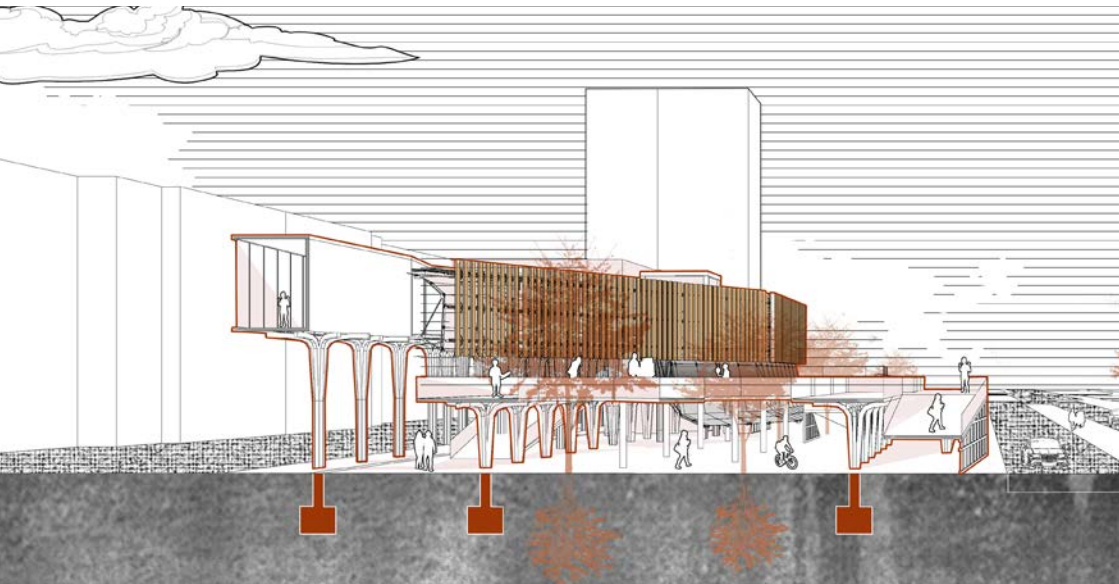
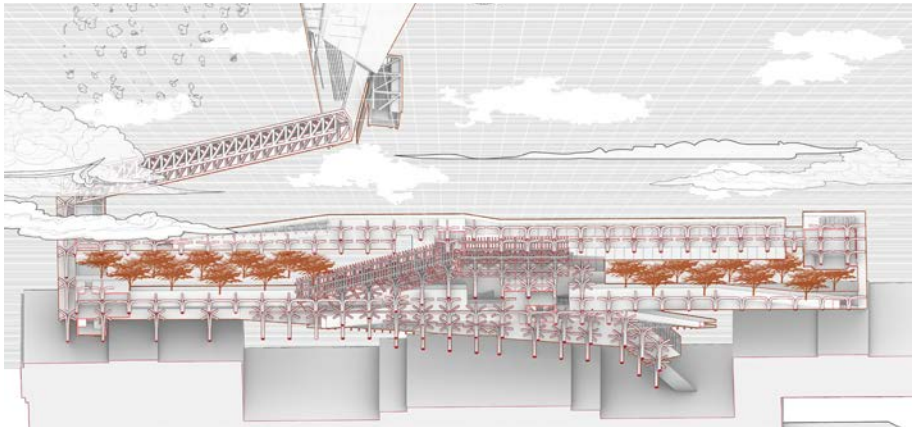



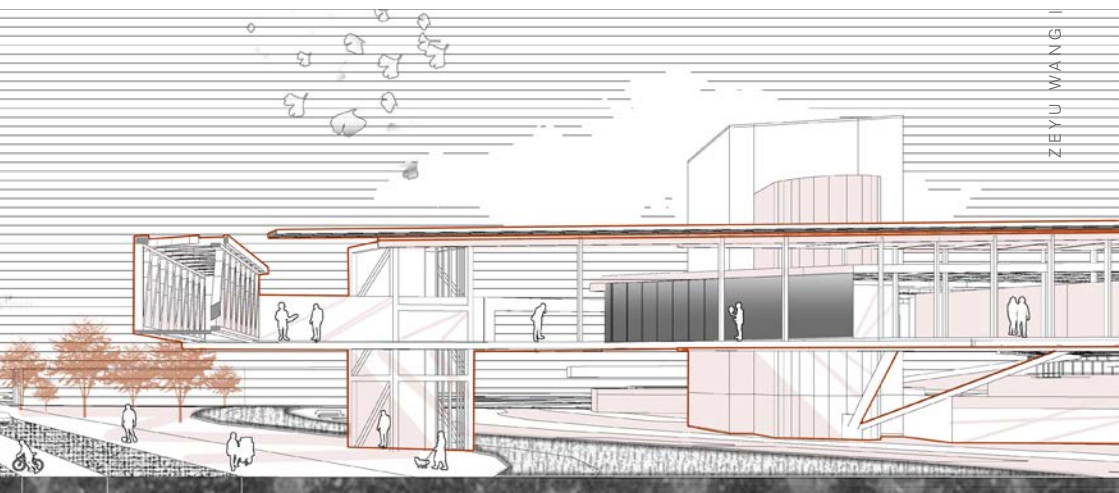
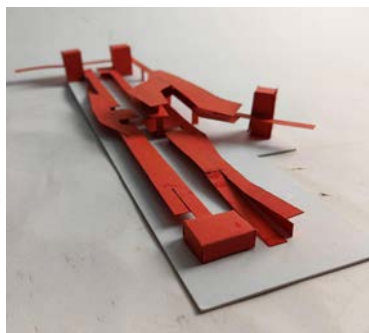
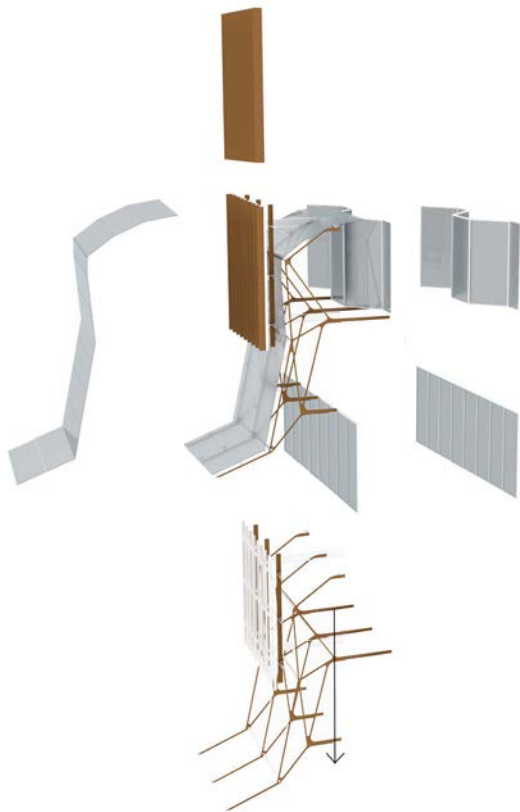



# 08b

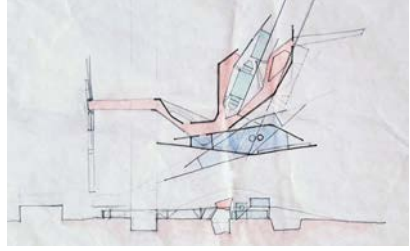

## URBAN EPIPHYTE

RAJ KACHARE

In the bustling heart of the city, where concrete towers reach towards the sky and the pulse of human activity reverberates through the streets, there exists a hidden realm—a sanctuary intertwined with the fabric of urban life yet often overlooked. Like a delicate vine clinging to the façade of a structure the concept of the urban epiphyte emerges—a testament to nature’s resilience and the potential for symbiosis amidst the urban jungle. The urban epiphyte, inspired by its botanical counterpart, embodies the spirit of adaptation and co-existence. It thrives in the most unexpected of places, drawing sustenance from the resources provided by its urban surroundings. Like a silent sentinel, it transforms barren rooftops, neglected alleyways, and forgotten corners into vibrant oases of life and vitality. Rooted in the principles of sustainability and ecological harmony, the project seeks to re-imagine the urban landscape through the lens of the epiphyte. Drawing inspiration from the poetry of architectural phenomenology, the design ethos transcends traditional boundaries, weaving a narrative of connectivity and symbiosis between humans and their environment. As we delve into the intricate dynamics of urban life, we uncover hidden layers of complex birdsong mingling with the hum of traffic, radio waves pulsating through the air, and the rhythmic ebb and flow of human movement. The introduction of the Faraday Cage provides sanctuary from electromagnetic interference, inviting individuals to immerse themselves fully in the essence of Berlin’s natural ambiance.



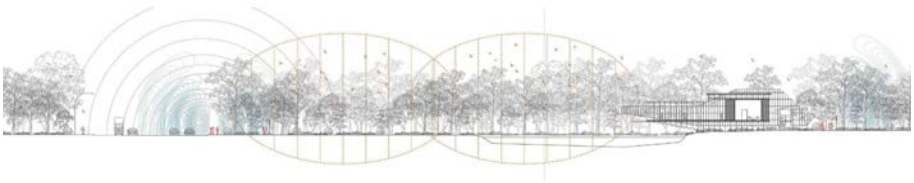
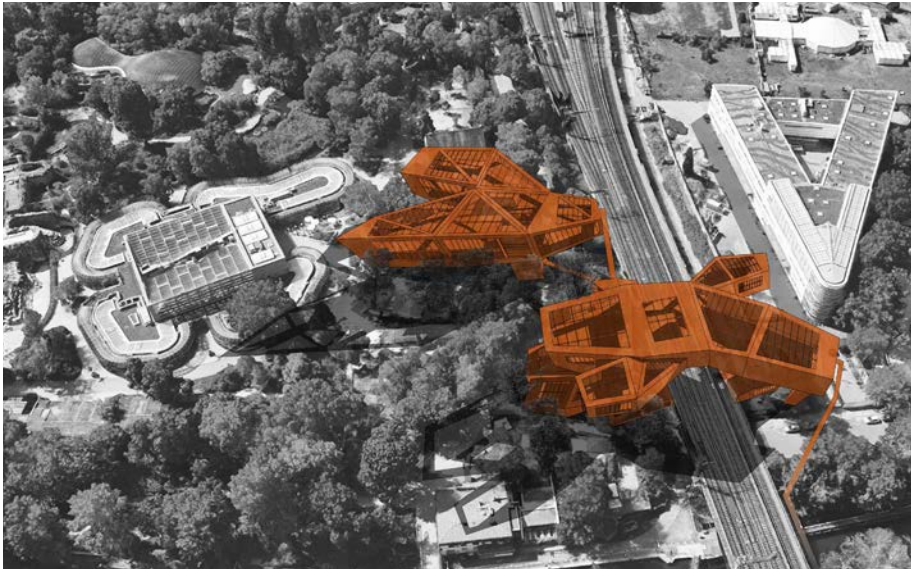

- 
- Scheme sketch (previous thumbnail)
  - Structural cage model (previous right)
  - Scheme massing overview in context (top)
  - Tiergarten field station section (middle)
  - Student facility section and Avion Institute section (bottom)
  - Rail wrapping scheme maquette (adjacent top left)
  - Ground floor plan (adjacent top right)
  - Massing visualisation (adjacent middle)

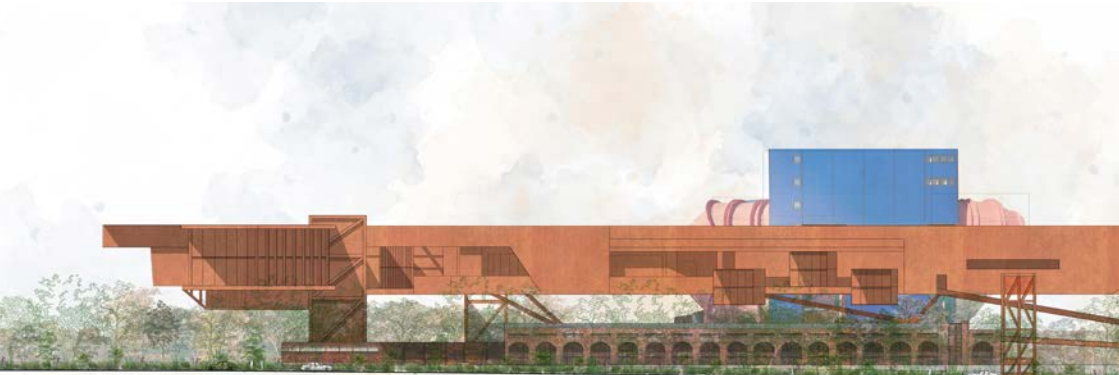



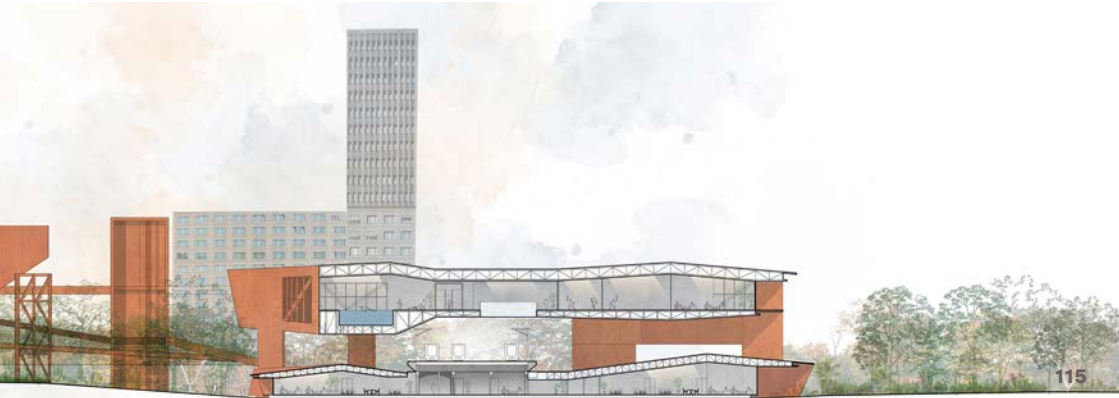
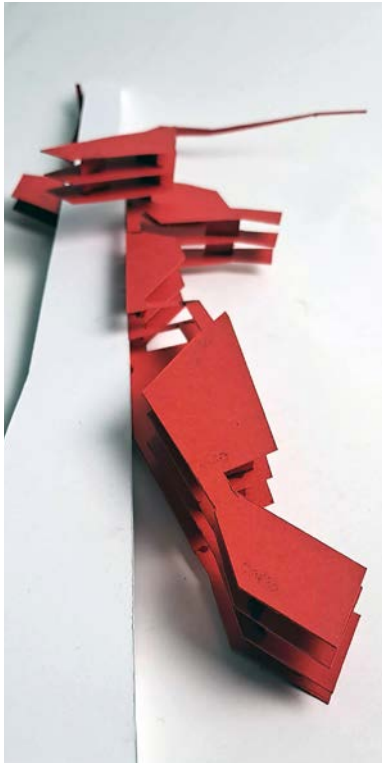

# BIBLIOGRAPHY

---

Ampatzidou, Cristina, Matthijs Bouw, Froukje van de Klundert, Michiel de Lande, and Martijn de Waal. *The Hackable City: A Research Manifesto and Design Toolkit*. Amsterdam: Amsterdam Creative Industries Publishing, 2015.

Arenes, A. "Terra forma: a book of speculative maps" (MIT Press).

Bartoli, Sandra, and Jörg Stollmann, eds. *Tiergarten—Landscape of Transgression (This Obscure Object of Desire)*. Zurich: Park Nooks, 2019.

Benjamin, Walter. *Berlin Childhood Around 1900*. Cambridge: Harvard University Press, 2006.

Böhme, Gernot. *Invasive Technification: Critical Essays in the Philosophy of Technology*. Bloomsbury, 2012.

DiSalvo, Carl. "Critical Making as Materializing the Politics of Design." *The Information Society* 30, no. 2 (March 1, 2014): 96–105.

Gandy, Matthew. *Natura Urbana Ecological Constellations in Urban Space*. Cambridge, Massachusetts: The MIT Press, 2022.

Gandy, Matthew. *Natura Urbana: The Brachen of Berlin* (2017) (Film)

Haraway, Donna. *When Species Meet*. University of Minnesota Press, 2007.

Habermas, Jürgen, *A Berlin Republic: Writings on Germany* (Cambridge: Polity Press, 1998).

Hessel, Franz. *Walking in Berlin: A Flaneur in the Capital*. Brunswick, Victoria: Scribe Publications, 2016.

Latour, Bruno. *After Lockdown: A Metamorphosis*. Polity, 2021.

Latour, Bruno, and Peter Weibel, eds. *Critical Zones: The Science and Politics of Landing on Earth*. MIT Press, 2020.

Mattern, Shannon. *Code + Clay . . . Data + Dirt: Five Thousand Years of Urban Media*. Minneapolis: University of Minnesota Press, 2017.

Monchaux, Nicholas De. *Local Code: 3,659 Proposals about Data, Design & the Nature of Cities*. New York: Princeton Architectural Press, 2016.

Paredes Maldonado, Miguel. "Counter-Hegemonic Sensory Practices in the City and a Collective Remaking of the Data-Based Urban Commons." In *Sensing Collectives: Aesthetic and Political Practices Intertwined*, edited by J-P. Voß, N. Rigamonti, M. Suárez, and J. Watson, 145–64. Bielefeld: Transcript Verlag, 2023.

# IMAGE REFERENCES

---

## Cover

- Bird Device – assembly. Photo, Terry Feng, Kim Lee, Bingzhi Li.

## Prologue

- Schienenmaus data collection – Natur Park. Photo, Wulfric Clackson, Georgia Tucker, Adam Mitchell.
- Tiergarten from Siegestraße. Photo, Andong Guo, Bolun Hua, Shiyu Zhang.

## ***Close Encounters: Berlin. Experiments with Data, Nature and Collective Life in the Urban Milieu.***

- 1 Overgrown rail tracks, Natur Park. Photo, Terry Feng, Kim Lee, Bingzhi Li.
- 2 Birds, Tempelhofer Feld. Photo, Terry Feng, Kim Lee, Bingzhi Li.
- 8-9 Disused rail tunnel, Natur Park. Photo, Terry Feng, Kim Lee, Bingzhi Li.
- 26-27 Project Index, collated by Terry Feng, Bolun Hua and Cosmo Wezenbeek.

## Epilogue

- 124 Field Data Collection - Physical Interpretation. Detail Photo, Andong Guo, Bolun Hua, Shiyu Zhang.
- Sounding the Ground, device tracking photography. Folahan Adelakun, Carl Harris, Oliver Maxwell.







Snapshots from Awards Ceremony, Konzertsaal Universität der Künste Berlin  
AIV-Schinkel-Wettbewerb 2024, über:morgen

# ACKNOWLEDGEMENTS

---

Tutors

**Andrea Faed**  
**Miguel Paredes Maldonado**  
**Andrew Brooks**  
**Jack Green**

Visitors

Alessia Calafiore, Arturo Romero Carnicero, Riet Eekhout, Colin Harris,  
Ross McLean, Carme Pinos, Dorian Wiszniewski,

Digital Prototyping Support

Joe Hathaway

Consultants

Jonathan Narro (Narro Associates), Andrew Leiper (Max Fordham)

Technicians

Rachel Travers, Malcolm Cruickshank, Paul Diamond, Paul Charlton, Richard Collins

Special Thanks

Olivia Reynolds (Lobe Block)

Close Encounters : Berlin edited by

**Andrew Brooks and Andrea Faed**

The format of this catalogue has developed annually, evolving from the inaugural catalogue series produced for the ESALA MArch studios 2017-18, designed by Emma Bennett and Rachel Braude.

Printed by

J Thomson Colour Printers Ltd., Glasgow



Wilmersdorf 2,3  
Universität der Kunst 1,3

Zooanlagen Garten  
& Bahnhof Zoo 1,3

1000  
1000

4,1  
1,3

1120

1245

1000

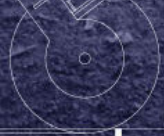







# ESALA



THE UNIVERSITY of EDINBURGH  
*Edinburgh College of Art*